

# Installation Guide: Day & Night Cellulars

Cordless Lift | Motorization



Installation  
Inside Mount



Installation  
Outside Mount

## HARDWARE AND PARTS INCLUDED

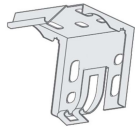

BRACKETS  
CORDLESS  
LIFT

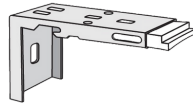

BRACKETS  
MOTORIZATION



SCREWS

## TOOLS REQUIRED



PENCIL



TAPE MEASURE



POWER DRILL



5/64" DRILL BIT

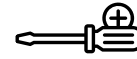

PHILLIPS SCREWDRIVER



PHILLIPS DRILL BIT



LEVEL

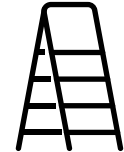

STEP LADDER

### Quick pointers

- 1 If you use your own screws instead of those provided, be sure to pre-drill a small hole with a 5/64" drill bit before the final screws go in to attach brackets.
- 2 If you're using wall anchors, pre-drill with a 1/4" drill bit instead, then tap the wall anchors in place before drilling in the screws.



LEVEL 1 INSTALLATION

## Cordless Lift

### INSIDE MOUNT

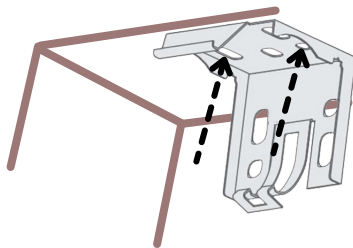

- 1 Hold the bracket up to the top of the window at least 2" from each corner and line the front up to make it flush with the wall.
- 2 Hold the bracket in place and mark the screw holes. Pre-drill through your marks.
- 3 Align the brackets with the holes, and use a Phillips drill bit to install the screws.

### OUTSIDE MOUNT

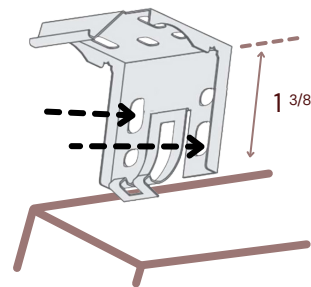

- 1 At least 2" from each corner of the window opening, measure at least 1 3/8" from the top of the window opening.
- 2 Align the top edge of a bracket along each mark, and use the holes in the back of the bracket to mark screw placement.
- 3 Align the brackets with the holes, and use a Phillips drill bit to install the screws.

## Motorization

### INSIDE MOUNT

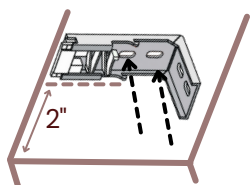

1

Make a mark at least 2 inches from the corner of the window opening.

2

Line up your bracket along this mark and make sure the bracket is flush with the front of the window opening. Mark the holes in the top of the bracket.

3

Predrill your holes and then align the brackets with the holes, and use a Phillips drill bit to install the screws.

### OUTSIDE MOUNT

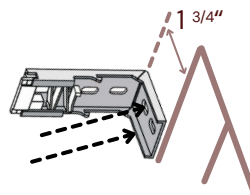

1

Near each corner, from the top edge of the window opening, measure at least 1 3/4" up above and make a mark.

2

At least 2" from each edge of the window opening, hold up the top of the bracket to the mark and mark the screw holes.

3

Predrill your holes and then align the brackets with the holes, and use a Phillips drill bit to install the screws.

## ATTACHING THE SHADE

1

Rest the shade on the front hook of the bracket.

2

Tilt the back of the headrail up towards the top of the bracket. The bracket should click once the headrail is in place. For motorization, you'll have to push the shade back first before tilting the back up.

### Cordless Lift



### Motorization

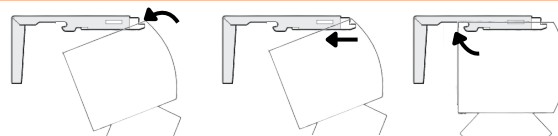

## CLEANING INSTRUCTIONS

1

For regular maintenance, use a duster or a vacuum with a brush attachment and run it over the front and back of the shade.

2

To spot clean stains, use a damp rag with a very mild, gentle detergent or soap. Dab at the affected spots; DO NOT RUB! Let the dampened area air dry and repeat as necessary.



## CHILD SAFETY WARNING

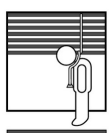

Corded window blinds and shades can be a strangulation risk or cause serious injury to young children and pets. When using corded window treatments, use the following tips to keep them safe:

● NEVER place a crib by a window!

- Move furniture that children can climb on away from the window.
- Secure child-safe tensioners for continuous cord loop chains to the wall or window encasement.
- Always use cord cleats with corded products.
- Keep cords up and away from your child's reach.

# Installation Guide: Day & Night Cellular Shade

Motorization Programming and Remote



Installation  
Inside Mount



Installation  
Outside Mount

## The Remote

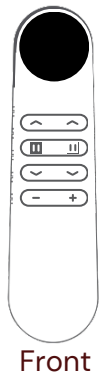

Front

### Front Shade Controls

Up  
Stop  
Down

### Rear Shade Controls

Up  
Stop  
Down

Channel Decrease  
Channel Increase



Back

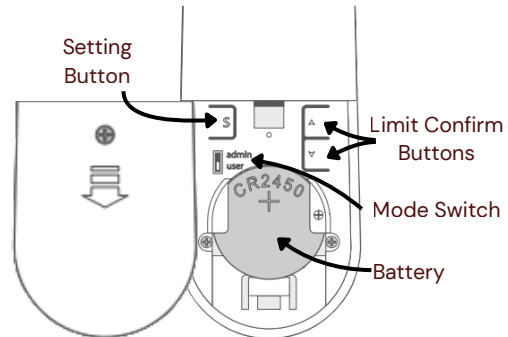

## Quick pointers

Make sure the shade is fully charged before pairing the remote.

## Setting the Limits with the Remote

The shades arrive with the remote already paired and preset, but if you would like to change the limits, follow these steps.

Remove the compartment on the back and switch the mode from "user" to "admin". When the steps below are done, switch back to "user".

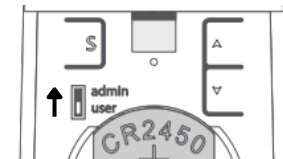

### Upper Limit

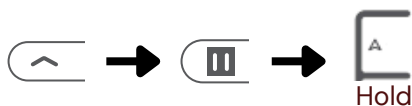

Press the up button and raise the shade to the desired position and press stop.

On the back of the remote, press and hold the Up Arrow Button until the shade jogs confirmation. This limit is now set.

### Lower Limit



Press the down button and lower the shade to the desired position and press stop.

On the back of the remote, press and hold the Down Arrow Button until the shade jogs confirmation. This limit is now set.

### Pairing a Remote

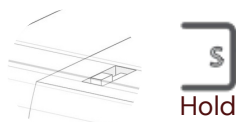

Press and hold the Setting button on the motor until you see a jog. While in "admin" mode press and hold the "setting" or S button on the remote until the shade jogs again to confirm pairing.

### Deleting a Remote



Press the "setting" or S button 5 times quickly to remove the remote. The shade will jog confirmation.

## REMOTE WALL MOUNT INSTALLATION

1

Clean the surface area where you'd like to install your remote's wall mount.

2

Peel the plastic from the adhesive strip on the back of the wall mount.

3

Firmly press the wall mount to the wall and hold it in place for 30 seconds to secure.

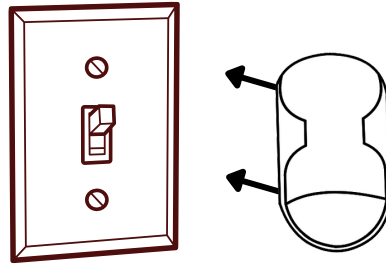

## CLICK2FIT INSTALLATION

### Installation and Removal

1

Hold the Click2Fit up against the top of window opening and make it flush with the window opening. Push the lever upwards until you hear the rail click in place.

2

Should you need to remove the Click2Fit headrail, uninstall the shade from the headrail. Use a flat-head screwdriver to unlatch the lever. Make sure to hold the headrail while unlatching the lever and cushion the lever as it unlatches. This will prevent damage to the window and headrail.

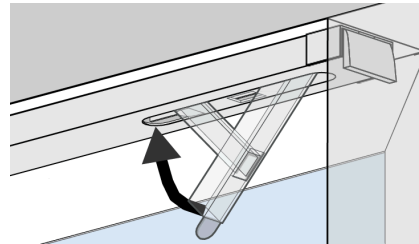

### Optional Metal Plate

1

Uninstall the shade from the Click2Fit headrail. Pull the lever from below to retract the tension block.

2

Peel the adhesive tape off of the back of the metal strip and attach it with the tabs at the bottom.

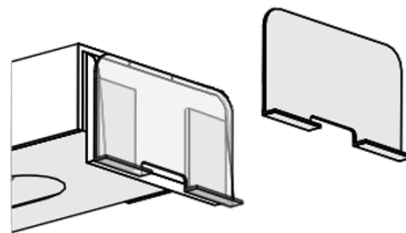

### Built-In Click2Fit

1

Peel back the fabric insert covering the lever. Insert the shade into the window. While the shade is flush with the window opening, press the lever back until you hear it click in place.

2

Recover the lever with the fabric insert and test the shade for operation.

1

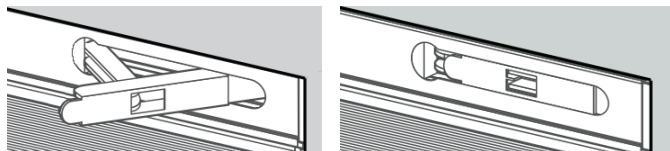

2

