

HOW TO REMOVE & RE-ATTACH CURTAINS ON 1 INCH PIPE ROD FOR CLEANING

- 1 Untighten the screw on center support (Center support is not provided for 28-48 inch rod)

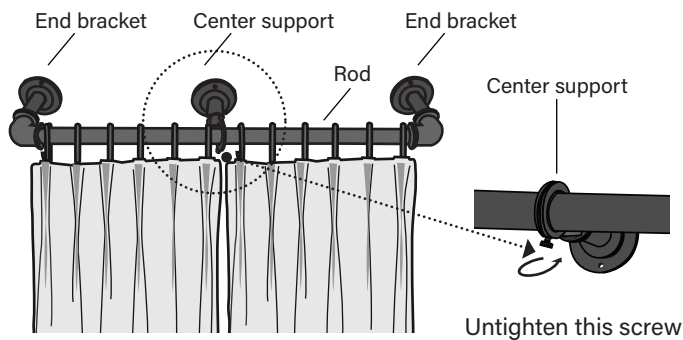

- 2 Firmly hold end bracket with one hand and slowly pull the rod out of the end bracket with the other hand. Gently nudge if necessary. Do not twist the rod to avoid misalignment. Rod adapter will stay on the end bracket.

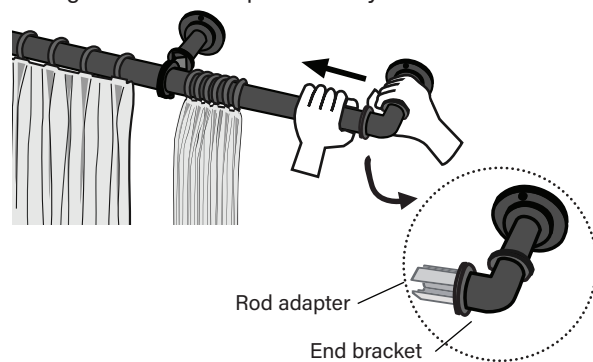

- 3 Remove the panel from the rod.

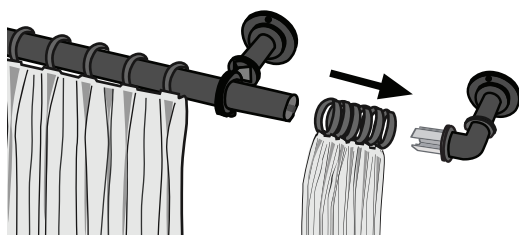

- 5 Gently remove the rod from center support if needed.

- 6 After cleaning the curtains, slide the rod back in center support. (Skip this step if there is no center support.) There are two diameters of rod adapter. For a three piece rod, there is only one diameter of rod adapter. Ensure outer rod and inner rod are facing corresponding rod adapter size. Slide the curtains back on rod.

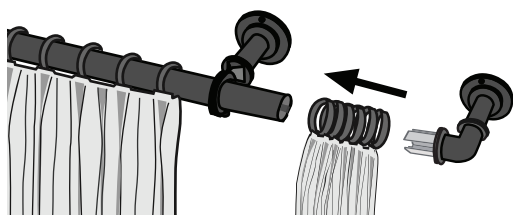

- 8 Repeat step 6 for the other side rod.

- 9 Tighten the screw on center support.

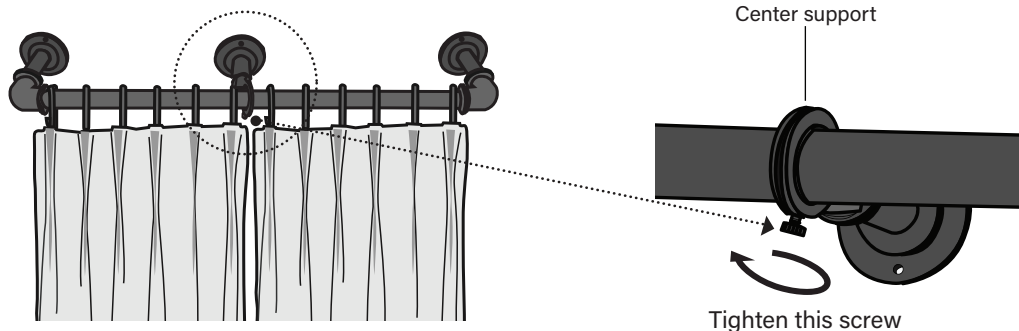

- 4 Repeat step 2 - 3 for the other side rod if needed.

- 7 Align the biggest channel of the rod adapter to the seam of the rod. Firmly slide the rod back to the corresponding rod adapter on the end bracket until completely snug.

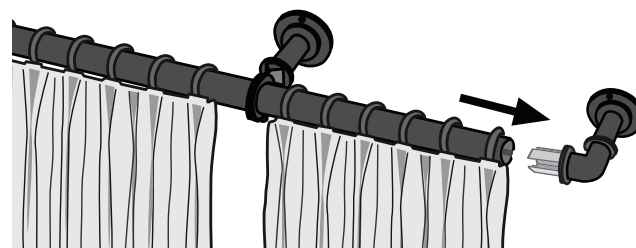
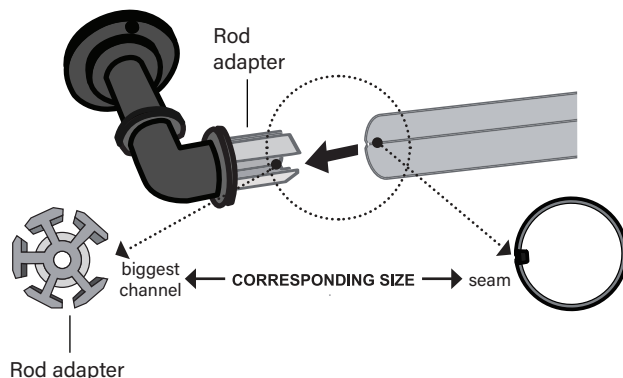

DRYWALL ANCHOR INSTALLATION



If screws are going directly into wood trim or wall studs - drill 1/8" (3mm) holes and install screws through bracket. If screws are going into hollow wall - drill 3/16" (5mm) holes and push or lightly hammer plastic anchors into holes. Then install screws through brackets. Do not tighten screws too much - just snug is best.

INSTALLATION INSTRUCTIONS FOR 1" BLACKOUT/CEILING CURTAIN ROD

CEILING MOUNTED:



WALL MOUNTED:

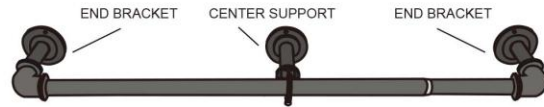

NOTE: Please note 28 to 48 inch rod does not come with a center support.

- 1** Place brackets against wall/ceiling at desired locations. Mark screw holes with a pencil. Be sure marks are level across opening. DO NOT MOUNT UNTIL STEP 6. Keep in mind that at least one bracket will be mounted on each inner and outer rod to prevent rod movement when sliding curtain.

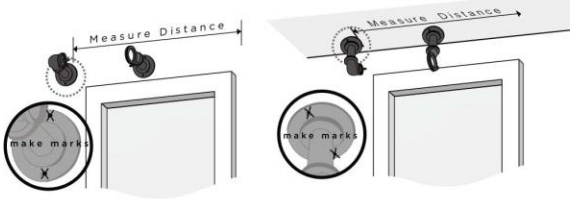

- 2** If screws are going directly into wood trim or wall/ceiling studs, drill a 1/8" pilot hole at pencil marks. If screwing into drywall, follow drywall anchor instructions at the bottom of the page.

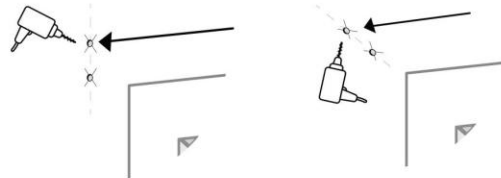

- 3** Assemble the rod by inserting and sliding the smaller diameter rod into the larger diameter rod. Ensure that finials inserts are exposed on each open end after rod assembly.

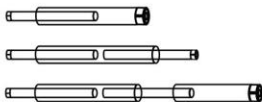

- 4** Slide curtains or curtain rings and center supports (if provided) onto rods.



- 5** Screw-on end brackets to the two ends of rods by turning the end brackets.



- 6** Insert screws through center supports and end brackets, and tighten screws until you feel increased resistance.

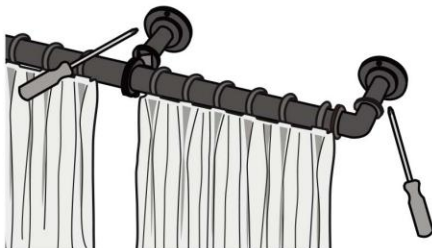

- 7** Tighten screws on center supports.

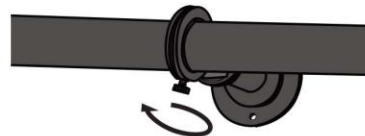

DRYWALL ANCHOR INSTALLATION



If screws are going directly into wood trim or wall studs - drill 1/8" (3mm) holes and install screws through bracket. If screws are going into hollow wall - drill 3/16" (5mm) holes and push or lightly hammer plastic anchors into holes. Then install screws through brackets. Do not tighten screws too much - just snug is best.