

CORDLESS FAUX WOOD INSTALLATION INSTRUCTIONS



1

TOOLS

GETTING STARTED - TOOLS NEEDED FOR INSTALLATION

Rechargeable Drill with 1/4" Hex Bit / Phillips Screwdriver / Pencil / Tape Measure

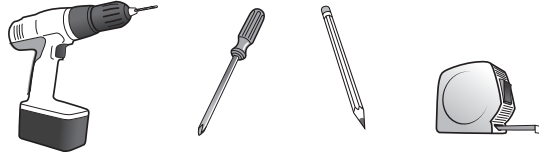

2

UNPACKING THE PARTS

Locate the parts and brackets in hardware box. The quantity will vary with blind size.

Hold-down parts will only be sent for blinds that have requested this option.

Center Support Bracket will only be sent for blinds over 37" wide.

Installation Brackets

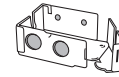

Valance Clips



Center Support



End Cap for Hold-downs



Hold-down Bracket



Installation Screws



3

BRACKET PLACEMENT

Left Bracket

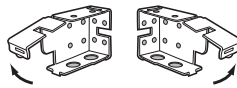

Right Bracket

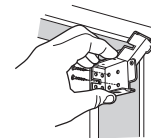

Inside mount

OR

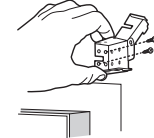

Outside mount

IF APPLICABLE:
Center Support Bracket

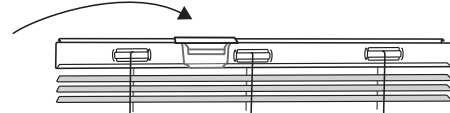
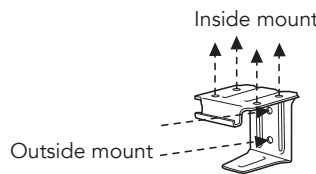

4

VALANCE CLIPS & WAND

Attach Valance Clips

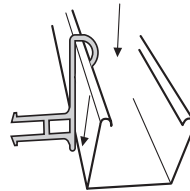
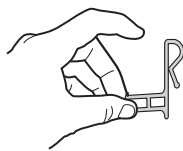

Clip on to Headrail

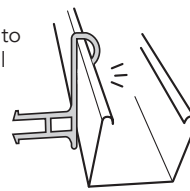

Assemble the Wand

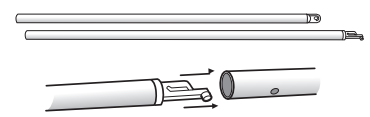

Snap together where applicable.

5

FINISHING UP

Slide into Brackets

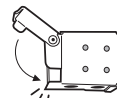
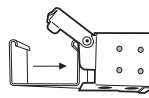
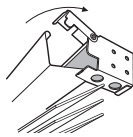

Attach Wand

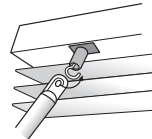

Install Valance

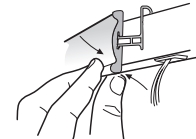

IF APPLICABLE:
Hold-down brackets

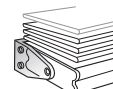
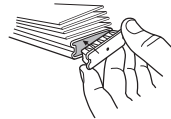

OR

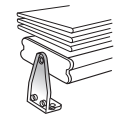

6

OPERATING INSTRUCTIONS

Raise or lower the blind by lifting or lowering the bottom rail to the desired height.

PLEASE NOTE: This product is made up to +6" of ordered height. Blinds over 84" may include up to 10" of additional height. This is normal for this product and not considered a manufacturing error or defect.

Open or close the blind slats by turning the wand until the slats are opened or closed to the desired amount.