

# 1" Green Living Mini Blinds

## Install Guide

### HARDWARE AND PARTS INCLUDED

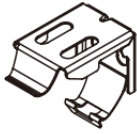

Mounting Bracket

23" - 47" = x2  
48" - 72" = x3



Large Screw

23" - 47" = x4  
48" - 72" = x6



Wand



(Optional)  
Hold Down  
Bracket



(Optional)  
Medium Screw  
x4

### TOOLS NEEDED



Drill or Screwdriver

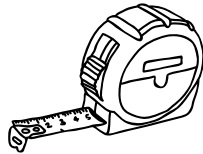
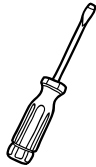

Measuring Tape



Pencil



This is a Level 1 Install.

## Installation

Clip the brackets onto the headrail about 1-3" from the end of the headrail on each side.

For products that are over 72" wide, ensure you place a bracket towards the center of the blind and then evenly space the two outer brackets.

**Be careful to not mount over any obstructions inside the headrail.**

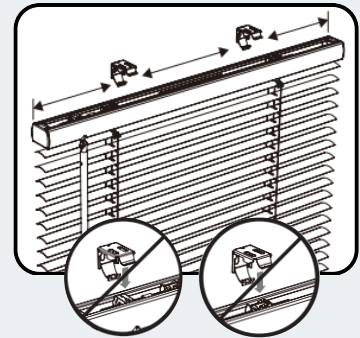

## Inside Mount

With the brackets clipped in, hold the product up to the top of the inside of the window opening, then mark where the bracket will be placed.

Remove the brackets from the product and then hold them up to where you placed your first marks then mark the holes where you'll drill.

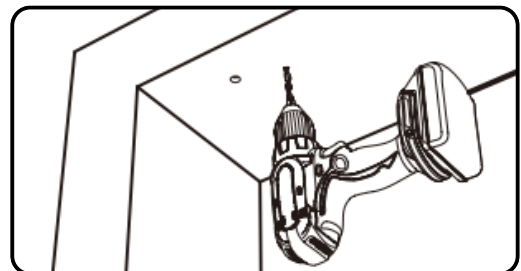

Predrill through your marks.

# 1" Green Living Mini Blinds

## Install Guide

### Outside Mount

With the brackets clipped in, hold the product up above the top of the inside of the window opening, then mark where the bracket will be placed.

Remove the brackets from the product and then hold them up to where you placed your first marks then mark the holes where you'll drill.

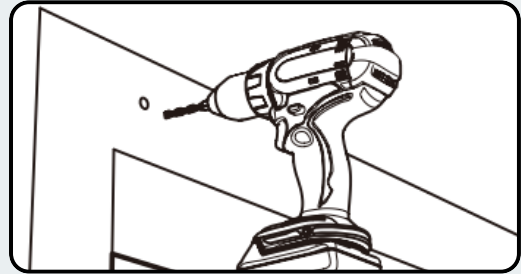

Predrill through your marks.

#### Inside Mount

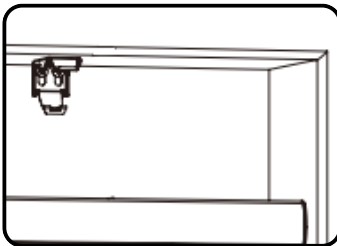

#### Outside Mount

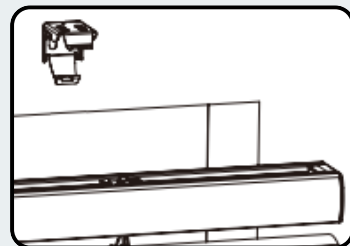

Install the brackets into their respective positions using the Large Screws.

### For Both Mount Types - Installing Onto the Brackets

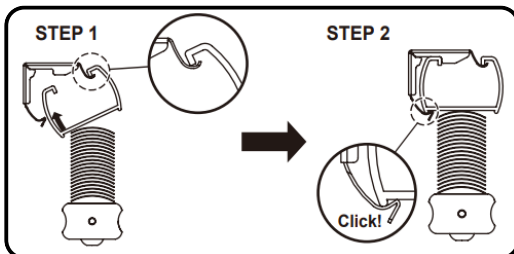

Hook front lip of the headrail onto the front hook of the bracket. Tilt the back up and press firmly to lock the blind into the bracket. You'll hear a click once it's locked in.

Install the wand onto the Tilt Hook and then test out the product's operation.

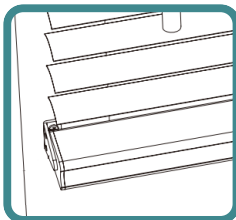
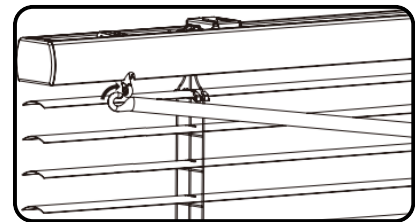

*(Optional) Install the Hold Down bracket by attaching the Hold Down to the bottom rail and lower the blind fully. Mark the placement of the hold down, then use the medium screws to screw it in place.*

**Cleaning:** Use a soft cloth, feather duster, or round brush attachment from a vacuum cleaner. Don't use solvents, or abrasive solutions, this will cause damage.