

# ROLLER SHADES

LIFT SYSTEM: CORDLESS LIFT



The difficulty level of this installation is ranked at **Level 2. You got this!**

If you have questions or get stuck, call our Customer Care Team at 888-257-1840, or email [customercare@selectblinds.com](mailto:customercare@selectblinds.com).

## HARDWARE AND PARTS INCLUDED

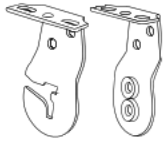

EXPOSED ROLL BRACKETS

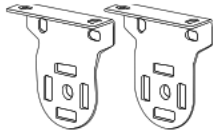

EXPOSED ROLL BRACKETS  
(LARGE SHADES ONLY)

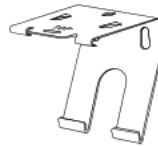

STANDARD CASSETTE  
BRACKETS\*



LARGE CASSETTE  
BRACKETS\*

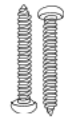

INSTALLATION  
SCREWS

\*The quantity of brackets you receive will depend on the width of your cassette headrail.

## TOOLS REQUIRED



PENCIL



TAPE MEASURE



POWER DRILL



5/64" DRILL BIT



PHILLIPS BIT



PHILLIPS SCREWDRIVER



LEVEL



STEP LADDER

## 1. MOUNTING THE BRACKETS

### MOUNTING EXPOSED ROLL BRACKETS

If your shade is smaller than 72" in width and height, you will receive an **IDLE BRACKET** and a **PIN BRACKET**. If your shade is larger than 72" in width or height, you will receive two **UNIVERSAL BRACKETS**.

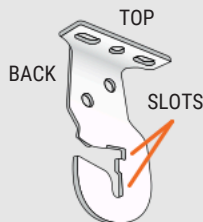

IDLE BRACKET

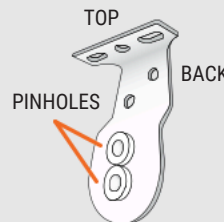

PIN BRACKET

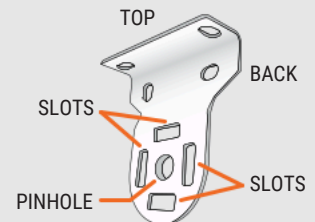

UNIVERSAL BRACKET

**NOTE:** Before you begin installing a shade with idle and pin brackets, it's important to determine which bracket belongs on the left, and which belongs on the right. Use the guide below to determine how your brackets will need to be positioned in the window. The roll position will not change how the brackets are positioned if you're installing a shade with universal brackets.

### Standard Roll:

Install your shade in the **STANDARD ROLL POSITION** if the fabric hangs from the back of the roller tube. The idle bracket will be placed on the left side of the window, and the pin bracket will be placed on the right side of the window.

### Reverse Roll:

If the fabric hangs from the front of the roller tube, install your shade in the **REVERSE ROLL POSITION**. The idle bracket will be placed on the right side of the window with the slots facing the window, and the pin bracket will be placed on the left side.

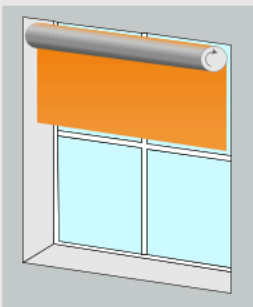

STANDARD ROLL POSITION



LEFT BRACKET

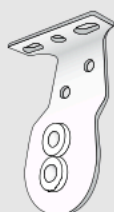

RIGHT BRACKET

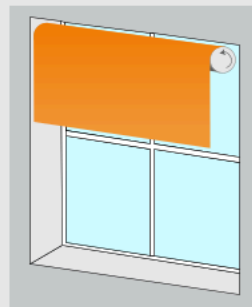

REVERSE ROLL POSITION

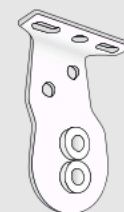

LEFT BRACKET



RIGHT BRACKET

## EXPOSED ROLL - INSIDE MOUNT

**NOTE:** The steps for mounting an exposed roll shade are the same, regardless of the bracket style you received. Before you begin, make sure you've identified your left and right brackets using the guide on page 1.

1. At the top-right corner of the window, measure how deep you wish to place your bracket (at least 2 1/4" required), and make a mark with your pencil. Repeat this step at the top-left corner of the window, using the same depth measurement.
2. Set your right-side bracket in the window so that the back edge aligns with your mark. Hold the bracket in position and use your pencil to mark through either the top screw holes (**TOP MOUNT**), or the back screw holes (**SIDE MOUNT**). Repeat this with your left-side bracket.
3. Pre-drill holes with a 5/64" drill bit at your previous marks on each side of the window.
4. Line up each bracket with the holes you drilled, and insert the screws. Once you have secured both brackets, you're ready to mount the shade (see page 5).

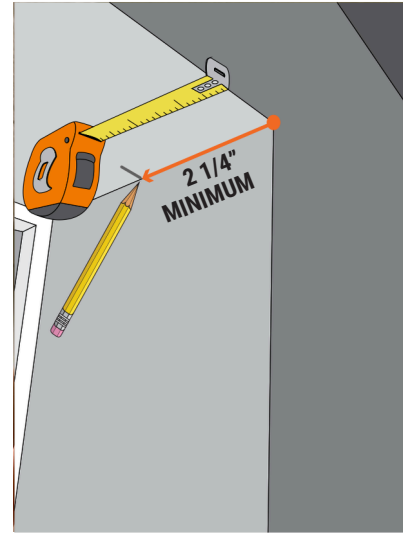

Example shown: Standard Roll - Idle Bracket (Left)

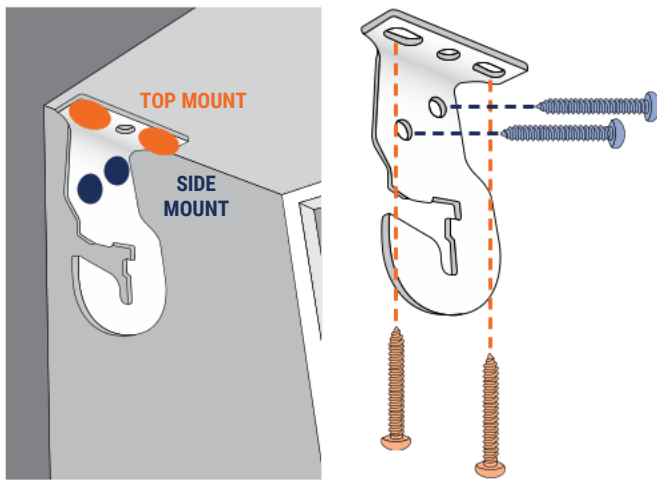

Example shown: Standard Roll - Pin Bracket (Right)

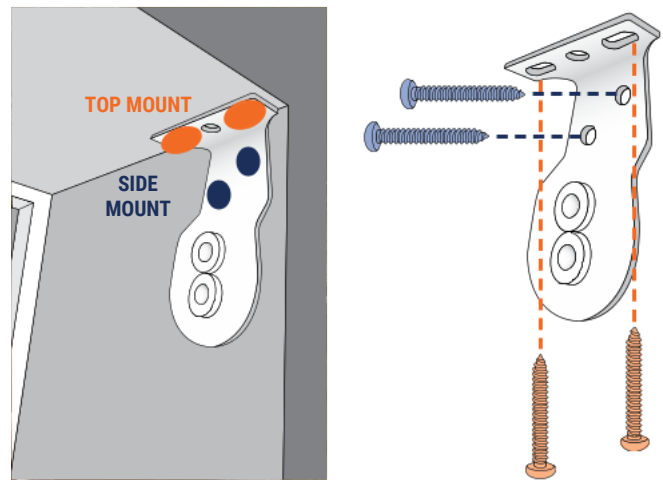

## EXPOSED ROLL - OUTSIDE MOUNT

**NOTE:** The steps for mounting an exposed roll shade are the same, regardless of the bracket style you received. Before you begin, make sure you've identified your left and right brackets using the guide on page 1.

1. At the top-left and top-right corners of the window, measure the height you wish to place your brackets (at least 2" required) and make a mark with your pencil.
2. Determine the difference in width between your shade and your window, and then divide it in half. From your previous marks, measure this distance away from the window, and make another mark with your pencil.

**EXAMPLE:** If your window is 48" wide and your roller shade is 52", the difference is 4". This means we measure and mark 2" away from the window, starting at the previous marks.

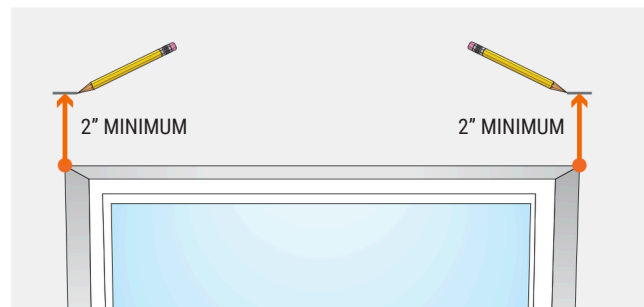

3. Center the right-side bracket at the outermost mark as shown, and use your pencil to mark the screw holes. Repeat this step with your left-side bracket at the outer-left mark.

4. Pre-drill the screw holes with a 5/64" drill bit at your marks on both sides of the window. Before you attach the brackets, you may want to erase any pencil marks that remain on the mounting surface.

5. Line up your right-side bracket with the screw holes, and insert two screws to secure the bracket to the mounting surface. Repeat this step for your left-side bracket. When both brackets are secure, the next step is to set the roller shade in the window (see page 5).

Example shown:  
Standard Roll - Idle Bracket (Left)

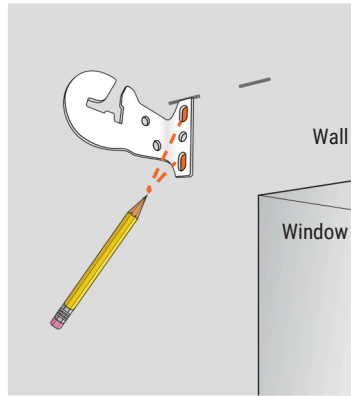

Example shown:  
Standard Roll - Pin Bracket (Right)

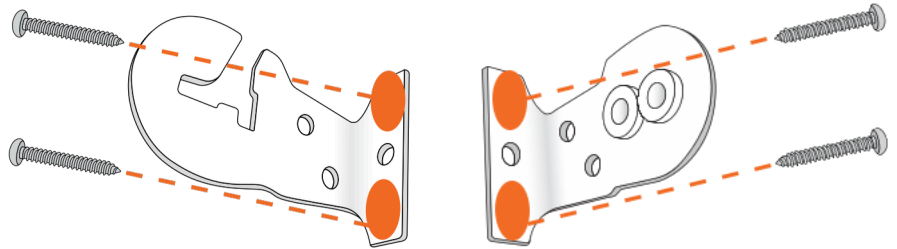
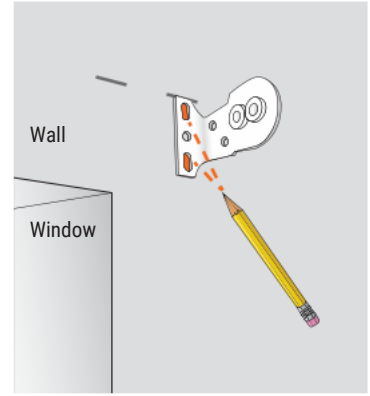

## MOUNTING CASSETTE HEADRAIL BRACKETS

**NOTE:** The roller shade tube is pre-installed in the cassette headrail, which simply snaps onto the provided hardware. You will receive two or more cassette brackets, depending on the width of your shade. **STANDARD CASSETTE BRACKETS** are included for cassette headrails 96" wide or smaller. **LARGE CASSETTE BRACKETS** are included for headrails over 96" wide.

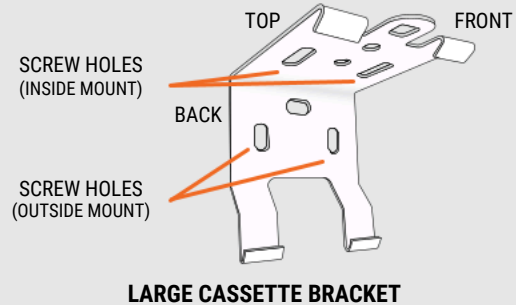
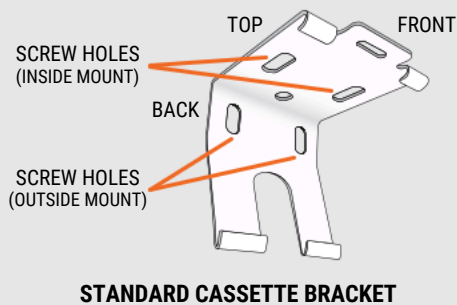

## CASSETTE HEADRAIL - INSIDE MOUNT

1. At the top corners of the window, measure inward and mark with your pencil 2" - 4" from each side. If you have additional brackets, make an additional mark for each one, evenly spaced between the outer marks.

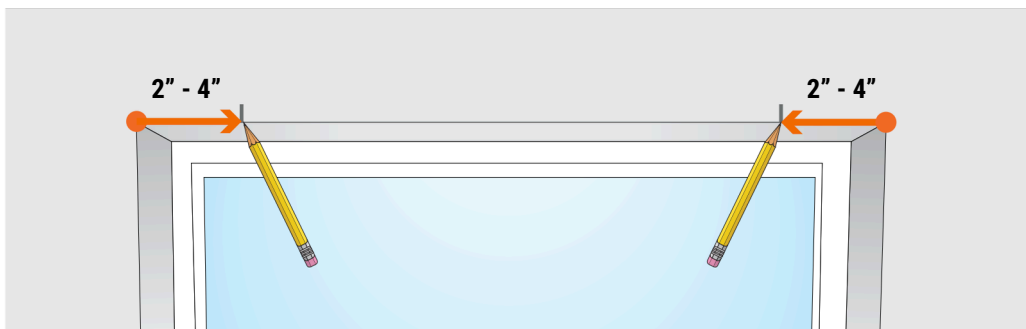

2. Next, you'll need to measure how deep to place your brackets in the window. Starting at one of your marks, measure back at least 2 5/8", and make a mark with your pencil. If you want the front of the cassette to be flush with the wall, measure back 3 1/4" and make a mark. Repeat this step until you've marked the same depth measurement for each bracket.

3. Position a bracket at the top of the window so that the back aligns with your mark. Make sure the front end of the bracket is parallel with the top edge of the window, then use your pencil to mark where the screws will go. Repeat this step until you've marked the screw holes for each bracket.

4. Pre-drill the screw holes with a 5/64" drill bit at your marks for each bracket location. Before you mount the brackets, you may want to erase any pencil marks that remain on the wall or window.

5. Line up your first bracket with the screw holes, and insert two screws to secure the bracket to the mounting surface. Repeat this step for any remaining brackets. When all brackets are secure, the next step is to set the roller shade in the window (see page 5).

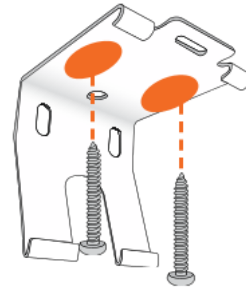
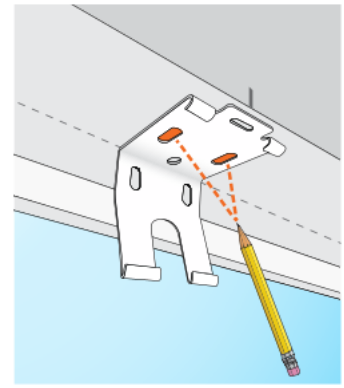
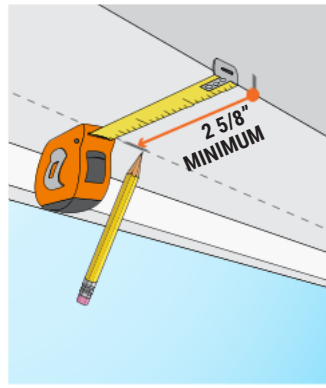

### CASSETTE HEADRAIL - OUTSIDE MOUNT

1. At the top corners of the window, measure inward and mark with your pencil 2" - 4" from each side. If you have additional brackets, make an additional mark for each one, evenly spaced between the outer marks.

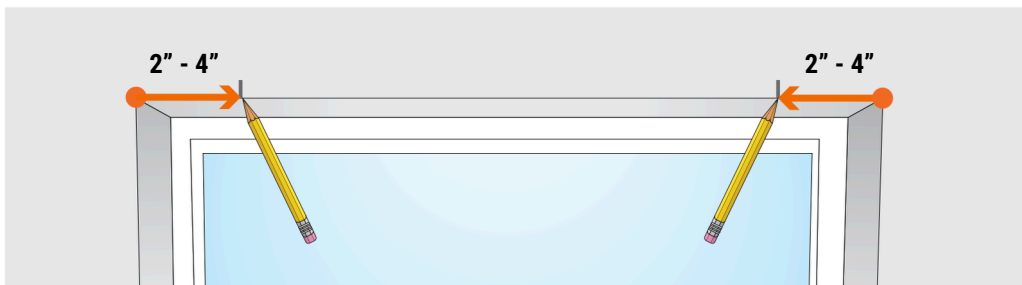

2. From one of these marks, measure upward and mark the height for the bracket placement. The minimum requirement is 1", but if you want the brackets to clear the top of the window, measure and mark at least 2 1/4" above your window. Repeat this until you've marked the same height measurement for each bracket.

3. Position a bracket so that the back is against your mounting surface, and the top is aligned with one of your upper marks. Hold the bracket in place and mark with your pencil where the screws will go. Repeat this until you've marked the screw holes for each bracket.

4. Pre-drill the screw holes with a 5/64" drill bit at your marks for each bracket location. Before you mount the brackets, you may want to erase any pencil marks that remain on the mounting surface.

5. Line up your first bracket with the screw holes, and insert two screws to secure the bracket to the mounting surface. Repeat this step for any remaining brackets. When all brackets are secure, the next step is to set the roller shade in the window (see page 5).

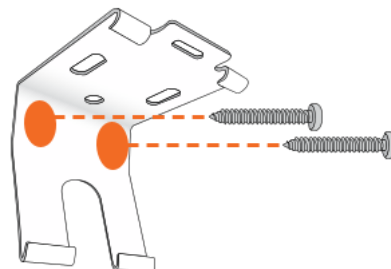
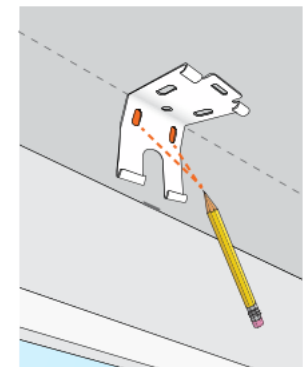
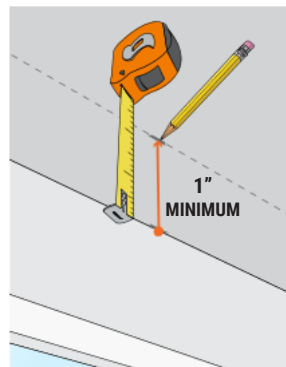

## 2. ATTACHING THE SHADE

**NOTE:** Before you attach the shade to the brackets, check that your brackets are straight and aligned with each other. The screw holes on all brackets are elongated, so making small adjustments is easy.

**Inside Mount:** Use a tape measure to check that each bracket is set to the same depth. If you need to make adjustments, slightly loosen the screws on a bracket and shift it back or forward. Secure the screws when the position is corrected.

**Outside Mount:** Use a tape measure to check that each bracket is set to the same height, and use a level on top of each bracket to make sure they're all straight and aligned. If you need to make adjustments, slightly loosen the screws on a bracket and shift it until it's level and set to the correct height.

### STANDARD EXPOSED ROLL

**NOTE:** The pin bracket has two pinholes, and the idle bracket has two slots.

Make sure to match the pinhole and slot correctly when attaching the shade.

The **ORANGE (#1)** arrow indicates how to attach the shade for inside mount, and the **BLUE (#2)** arrow indicates how to attach the shade for outside mount.

1. While holding the roller shade in your hands, locate the compressible pin on the right end of the shade. Set this pin into one of the plastic rings on the pin bracket.

2. With the pin inserted and compressed, locate the tab on the left end of the shade. Set this tab onto the corresponding slot in the idle bracket as shown.

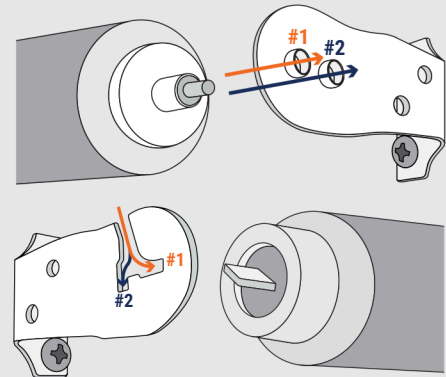

### REVERSE EXPOSED ROLL

**NOTE:** Refer to the "Reverse Roll" section on page 1 to see the correct bracket orientation for inside mount. For outside mount, the idle bracket must face away from the window, so that the "hook" still faces upward. The **ORANGE (#1)** arrow indicates how to attach the shade for inside mount, and the **BLUE (#2)** arrow indicates how to attach the shade for outside mount.

1. While holding the roller shade in your hands, locate the compressible pin on the left end of the shade. Set this pin into one of the plastic rings on the pin bracket.

2. With the pin inserted and compressed, locate the tab on the right end of the shade. Set this tab onto a slot in the idle bracket as shown. The inner slot is for outside mount, and the outer slot is for inside mount.

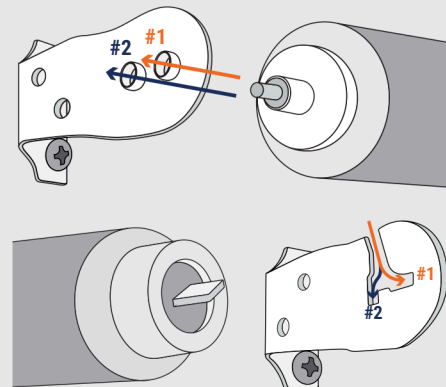

### UNIVERSAL EXPOSED ROLL

**NOTE:** Standard roll shades have a pin on the right end, and reverse roll shades have the pin on the left. The pin end of the shade should be attached first, followed by the opposite end with prongs.

1. While holding the roller shade in your hands, locate which end of the shade has the compressible pin. Slide this pin into the center pinhole on your first bracket.

2. With the pin inserted and compressed, locate the two rectangular prongs on the opposite end of the shade. Set these prongs onto the second bracket through the corresponding slots, as shown.

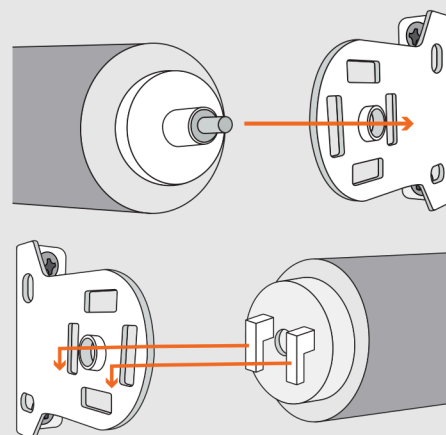

## STANDARD AND LARGE CASSETTE HEADRAIL

1. Grab the cassette and hold it up to your brackets. Set the back edge of the headrail onto the bottom tab of each bracket. While in this position, you can slide the shade left or right until the cassette is centered.
2. When you're ready to secure the headrail, push the headrail back until the top of each bracket snaps onto the top of the cassette.

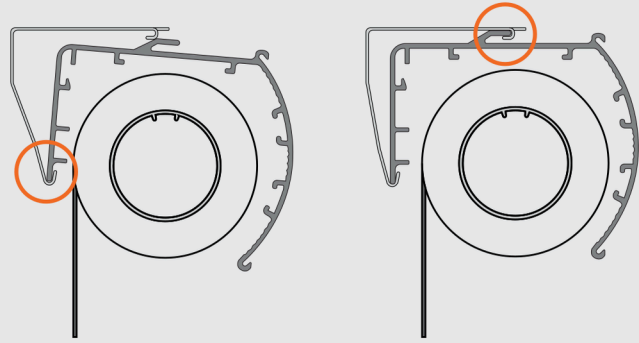

## 3. ADDITIONAL INSTRUCTIONS

### HOW TO OPERATE

**NOTE:** Do not pull on the side of the shade fabric; this can cause the fabric to misalign or become dirty. A cordless roller shade should only be operated by pulling the bottom hem bar. We recommend using two hands when lifting or lowering the shade.

1. To lower the shade, grip the hem bar and gently pull straight down to the desired position.
2. To raise the shade, grip the hem bar and gently tug down to release the lock mechanism. Slowly guide the shade up without releasing your grip, and gently tug down to lock the shade in position.

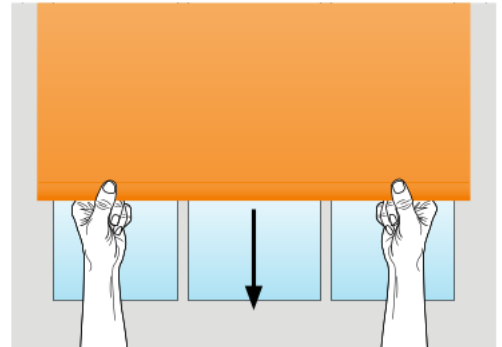

### ADJUSTING TENSION

**NOTE:** You can change the speed of your shade by adjusting the spring tension. If the shade is too slow, increase the tension; if the shade is too fast, decrease tension.

1. Lower the shade about 18" from the top if you need to increase tension, or raise the shade to the top if you need to decrease tension.
2. Remove the shade from the window, but leave your brackets installed.



IDLE BRACKET

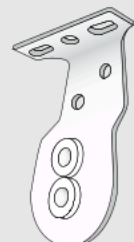

PIN BRACKET

**A. Exposed Roll:** Grip the roller with both hands and disengage the idle end of the shade. Then shift the roller away from the pin bracket.

**B. Cassette Headrail:** Grip the cassette with both hands. While firmly pushing it toward the window, roll the front downward and then lift the cassette away. Remove the covers from each end of the cassette, and then disengage the roller tube from the internal hardware. You may need a flat head screwdriver to compress the pin. To increase tension, carefully roll up the shade with your hands and then reattach it to the brackets. To decrease tension, carefully unroll the shade with your hands and then reattach it to the brackets. Repeat these steps until you've reached the desired tension.

### ATTACHING THE BRACKET COVERS UNIVERSAL BRACKETS - OUTSIDE MOUNT

**NOTE:** Bracket covers are only provided for outside mounted exposed roll shades installed onto universal brackets. These are used for hiding the brackets and the components on each end of the roller shade. 1. Slide a cover onto each bracket until it snaps in position. Use the illustration as your guide.

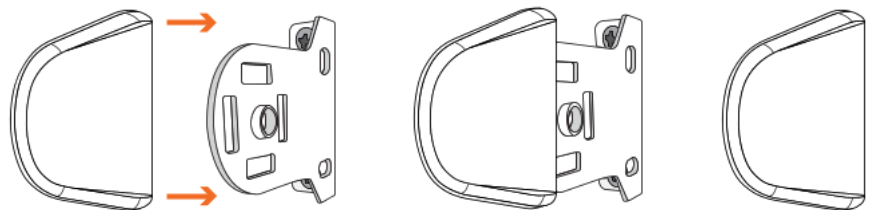



# ROLLER SHADES

## LIFT SYSTEM: CONTINUOUS CORD LOOP



The difficulty level of this installation is ranked at **Level 2. You got this!**

If you have questions or get stuck, call our Customer Care Team at 888-257-1840, or email [customer care@selectblinds.com](mailto:customer care@selectblinds.com).

### HARDWARE AND PARTS INCLUDED

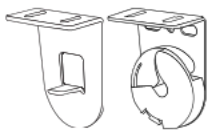

EXPOSED ROLL  
BRACKETS

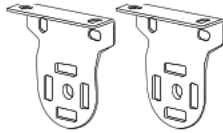

EXPOSED ROLL BRACKETS  
(LARGE SHADES ONLY)

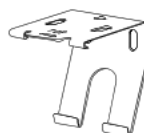

STANDARD CASSETTE  
BRACKETS\*



LARGE CASSETTE  
BRACKETS\*

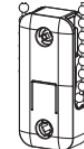

CHAIN  
TENSIONER



TENSIONER  
BRACKET

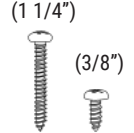

INSTALLATION  
SCREWS

\*The quantity of brackets you receive will depend on the width of your cassette headrail.

### TOOLS REQUIRED



PENCIL



TAPE MEASURE



POWER DRILL



5/64" DRILL BIT



PHILLIPS BIT



PHILLIPS SCREWDRIVER



LEVEL



STEP LADDER

## 1. MOUNTING THE BRACKETS

### MOUNTING EXPOSED ROLL BRACKETS

If your shade is smaller than 72" in width and height, you will receive an **IDLE BRACKET** and a **PIN BRACKET**. If your shade is larger than 72" in width or height, you will receive two **UNIVERSAL BRACKETS**.

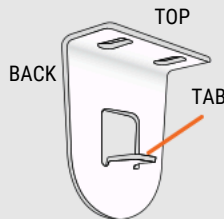

IDLE BRACKET

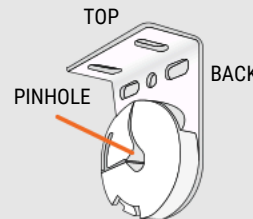

PIN BRACKET

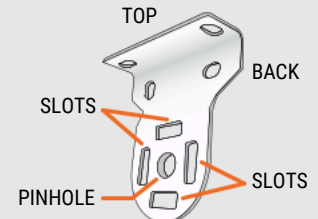

UNIVERSAL BRACKET

**NOTE:** Before you begin installing a shade with idle and pin brackets, it's important to determine which bracket belongs on the left, and which belongs on the right. Use the guide below to determine how your brackets will need to be positioned at the top of the window. The position of the chain loop will not change how the brackets are placed if you're installing a shade with universal brackets.

**Exposed Roll - Left Chain:** If your shade's chain loop is located on the left end of the shade, the idle bracket will be placed on the left side of the window, and the pin bracket will be placed on the right side of the window.

**Exposed Roll - Right Chain:** If your shade's chain loop is located on the right end of the shade, the idle bracket will be placed on the right side of the window, and the pin bracket will be placed on the left side of the window.



LEFT BRACKET

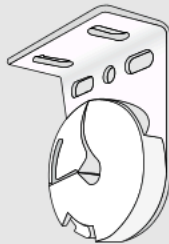

RIGHT BRACKET

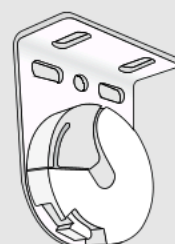

LEFT BRACKET



RIGHT BRACKET

## EXPOSED ROLL - INSIDE MOUNT

**NOTE:** The steps for mounting an exposed roll shade are the same, regardless of the bracket style you received. Before you begin, make sure you've identified your left and right brackets using the guide on page 7.

1. At the top-right corner of the window, measure how deep you wish to place your bracket (at least 2 1/4" required), and make a mark with your pencil. Repeat this step at the top-left corner of the window, using the same depth measurement.
2. Set your right-side bracket in the window so that the back edge aligns with your mark. Hold the bracket in position and use your pencil to mark through the top screw holes. Repeat this step with your left-side bracket.
3. Pre-drill holes with a 5/64" drill bit at your previous marks on each side of the window.
4. Line up each bracket with the holes you drilled, and insert the screws. Once you have secured both brackets, you're ready to mount the shade into the window (see page 11).

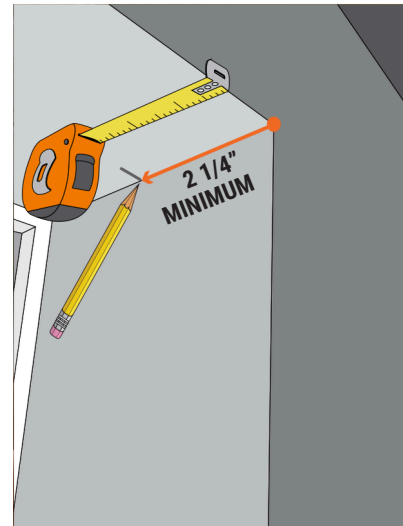

Example shown: Roller with Left Chain - Idle Bracket (Left)

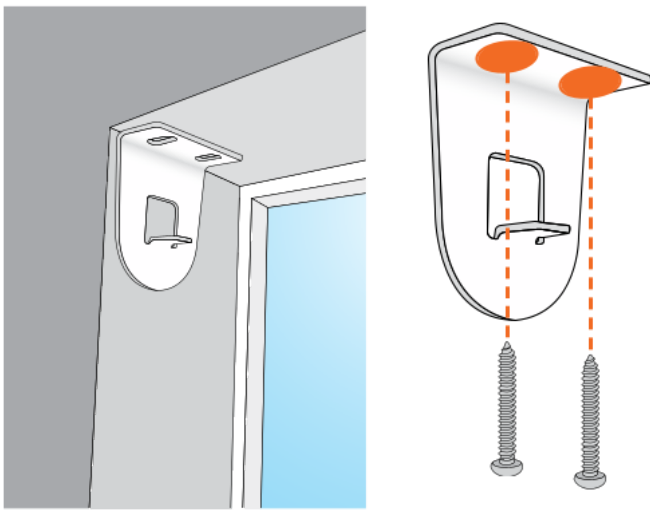

Example shown: Roller with Left Chain - Pin Bracket (Right)

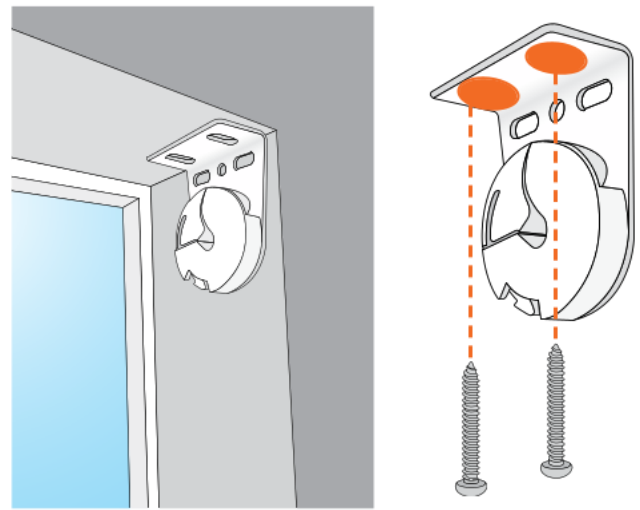

## EXPOSED ROLL - OUTSIDE MOUNT

**NOTE:** The steps for mounting an exposed roll shade are the same, regardless of the bracket style you received. Before you begin, make sure you've identified your left and right brackets using the guide on page 7.

1. At the top-left and top-right corners of the window, measure the height you wish to place your brackets (at least 2" required) and make a mark with your pencil.
2. Determine the difference in width between your shade and your window, and then divide it in half. From your previous marks, measure this distance away from the window, and make another mark with your pencil.

### EXAMPLE:

If your window is 48" wide and your roller shade is 52", the difference is 4". This means we measure and mark 2" away from the window, starting at the previous marks.

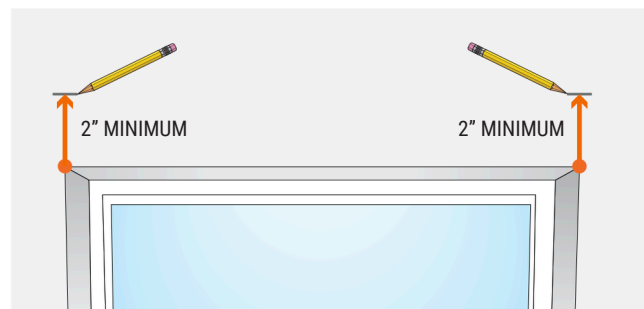



3. Center the right-side bracket at the outermost mark as shown, and use your pencil to mark the screw holes. Repeat this step with your left-side bracket at the outer-left mark. 4. Pre-drill the screw holes with a 5/64" drill bit at your marks on both sides of the window. Before you attach the brackets, you may want to erase any pencil marks that remain on the mounting surface. 5. Line up your right-side bracket with the screw holes, and insert two screws to secure the bracket to the mounting surface. Repeat this step for your left-side bracket. When both brackets are secure, you're ready to mount the shade into the window (see page 11).

Example shown:  
Left Chain - Idle Bracket (Left)

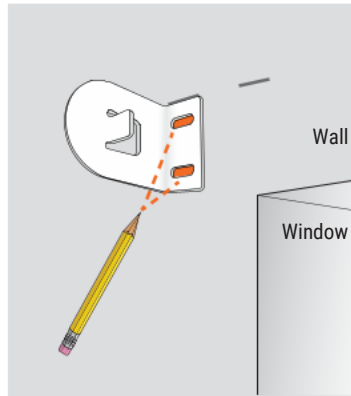

Example shown:  
Left Chain - Pin Bracket (Right)

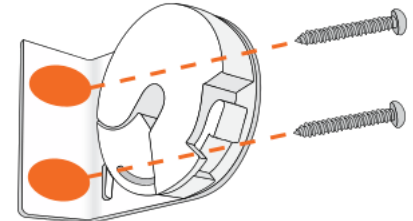
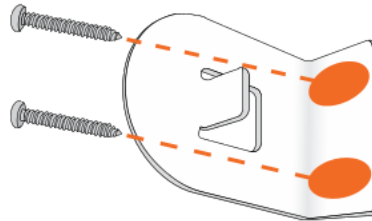
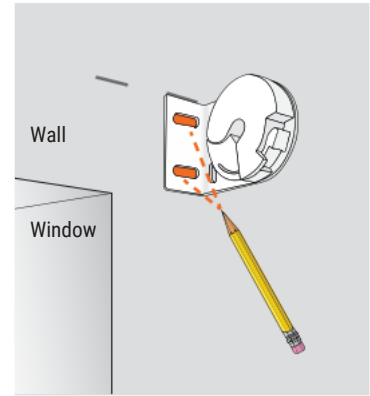

## MOUNTING CASSETTE HEADRAIL BRACKETS

**NOTE:** The roller shade tube is pre-installed in the cassette headrail, which simply snaps onto the provided hardware. You will receive two or more cassette brackets, depending on the width of your shade. **STANDARD CASSETTE BRACKETS** are included for cassette headrails 96" wide or smaller. **LARGE CASSETTE BRACKETS** are included for headrails over 96" wide.

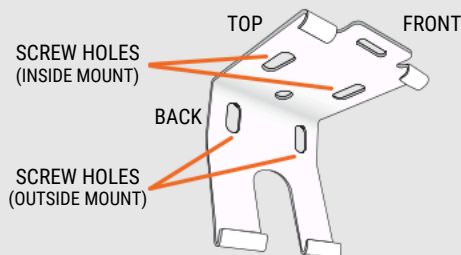

STANDARD CASSETTE BRACKET

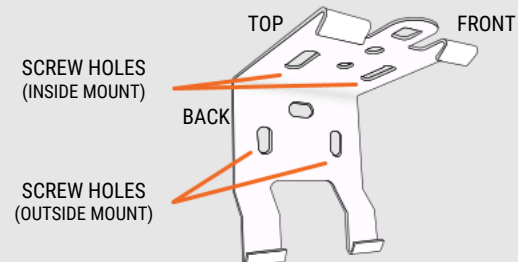

LARGE CASSETTE BRACKET

## CASSETTE HEADRAIL - INSIDE MOUNT

1. At the top corners of the window, measure inward and mark with your pencil 2" - 4" from each side. If you have additional brackets, make an additional mark for each one, evenly spaced between the outer marks.

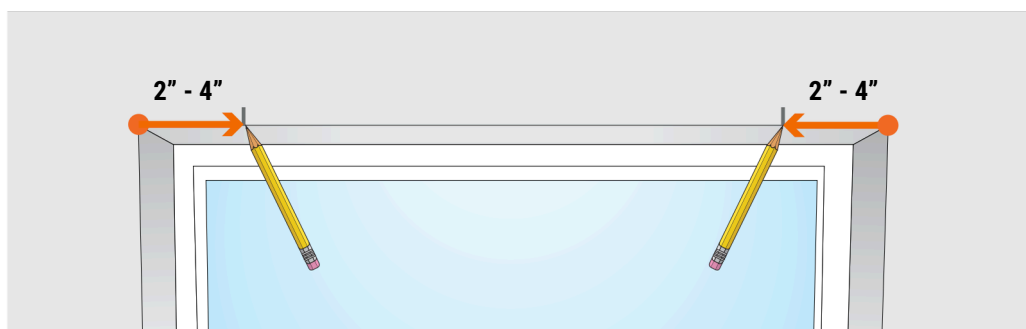

2. Next, you'll need to measure how deep to place your brackets in the window. Starting at one of your marks, measure back at least 2 5/8", and make a mark with your pencil. If you want the front of the cassette to be flush with the wall, measure back 3 1/4" and make a mark. Repeat this step until you've marked the same depth measurement for each bracket.

3. Position a bracket at the top of the window so that the back aligns with your mark. Make sure the front end of the bracket is parallel with the top edge of the window, then use your pencil to mark where the screws will go. Repeat this step until you've marked the screw holes for each bracket.

4. Pre-drill the screw holes with a 5/64" drill bit at your marks for each bracket location. Before you mount the brackets, you may want to erase any pencil marks that remain on the wall or window.

5. Line up your first bracket with the screw holes, and insert two screws to secure the bracket to the mounting surface. Repeat this step for any remaining brackets. When all brackets are secure, you're ready to mount the shade into the window (see page 11).

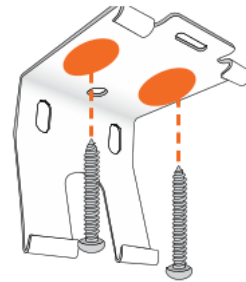
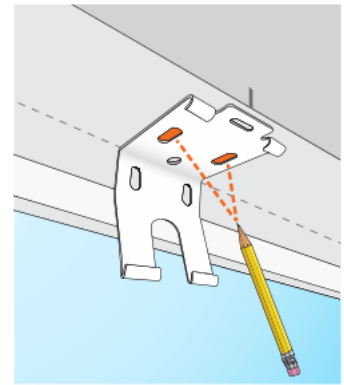
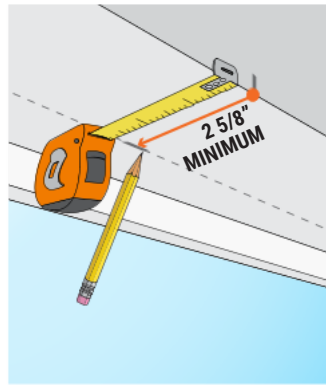

### CASSETTE HEADRAIL - OUTSIDE MOUNT

1. At the top corners of the window, measure inward and mark with your pencil 2" - 4" from each side. If you have additional brackets, make an additional mark for each one, evenly spaced between the outer marks.

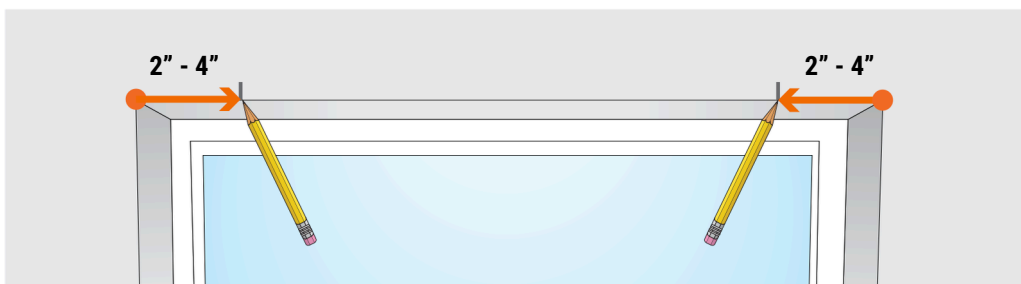

2. From one of these marks, measure upward and mark the height for the bracket placement. The minimum requirement is 1", but if you want the brackets to clear the top of the window, measure and mark at least 2 1/4" above your window. Repeat this until you've marked the same height measurement for each bracket.

3. Position a bracket so that the back is against your mounting surface, and the top is aligned with one of your upper marks. Hold the bracket in place and mark with your pencil where the screws will go. Repeat this until you've marked the screw holes for each bracket.

4. Pre-drill the screw holes with a 5/64" drill bit at your marks for each bracket location. Before you mount the brackets, you may want to erase any pencil marks that remain on the mounting surface.

5. Line up your first bracket with the screw holes, and insert two screws to secure the bracket to the mounting surface. Repeat this step for any remaining brackets. When all brackets are secure, you're ready to mount the shade into the window (see page 11).

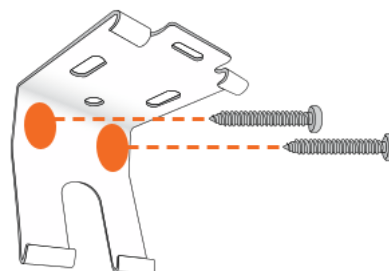
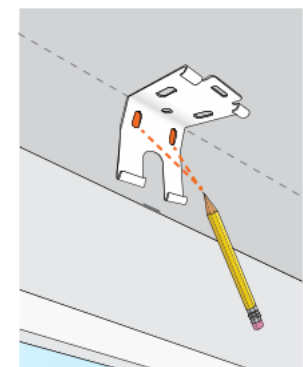
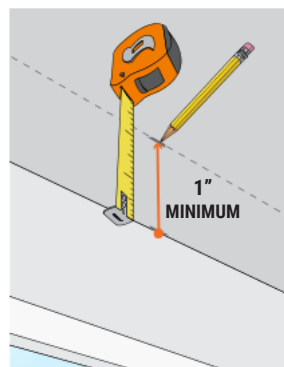

## 2. ATTACHING THE SHADE

**NOTE:** Before you attach the shade to the brackets, check that your brackets are straight and aligned with each other. The screw holes on all brackets are elongated, so making small adjustments is easy.

**Inside Mount:** Use a tape measure to check that each bracket is set to the same depth. If you need to make adjustments, slightly loosen the screws on a bracket and shift it back or forward. Secure the screws when the position is corrected.

**Outside Mount:** Use a tape measure to check that each bracket is set to the same height, and use a level on top of each bracket to make sure they're all straight and aligned. If you need to make adjustments, slightly loosen the screws on a bracket and shift it until it's level and set to the correct height.

**TIP:** Open the latch on the pin bracket before attaching the shade. Pull the lever away from the wheel, then swing the latch open.

### EXPOSED ROLL - LEFT CHAIN LOOP

**NOTE:** If you have a left-side chain loop, start by installing the shade onto the idle bracket on the left side of the window.

1. While holding the roller shade in your hands, locate the gear-shaped hole on the left end of the shade. Slide this hole firmly onto the tab of the idle bracket.
2. Locate the pin on the right end of the shade, and gently set it into the center notch on the pin bracket. Securely snap the latch closed over the pin to finish attaching your roller shade to the brackets.

### EXPOSED ROLL - RIGHT CHAIN LOOP

**NOTE:** If you have a right-side chain loop, start by installing the shade onto the idle bracket on the right side of the window.

1. While holding the roller shade in your hands, locate the gear-shaped hole on the right end of the shade. Slide this hole firmly onto the tab of the idle bracket.
2. Locate the pin on the left end of the shade, and gently set it into the center notch on the pin bracket. Securely snap the latch closed over the pin to finish attaching your roller shade to the brackets.

### UNIVERSAL EXPOSED ROLL

**NOTE:** Standard roll shades have a pin on the right end, and reverse roll shades have the pin on the left. The pin end of the shade should be attached first, followed by the opposite end with prongs.

1. While holding the roller shade in your hands, locate which end of the shade has the compressible pin. Slide this pin into the center pinhole on your first bracket.
2. With the pin inserted and compressed, locate the two rectangular prongs on the opposite end of the shade. Set these prongs onto the second bracket through the corresponding slots, as shown.
3. Refer to page 6 to attach the bracket covers onto each bracket (outside mount only).

PIN BRACKET CLOSED

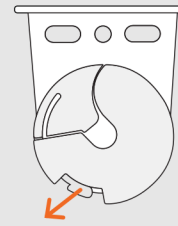

PIN BRACKET OPEN

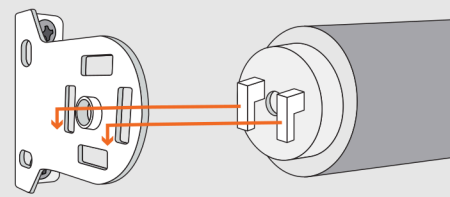
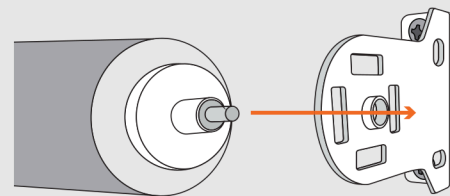
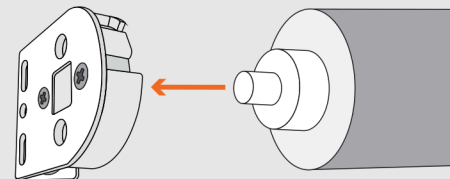
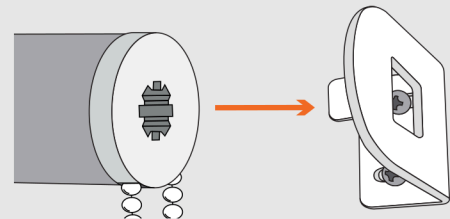
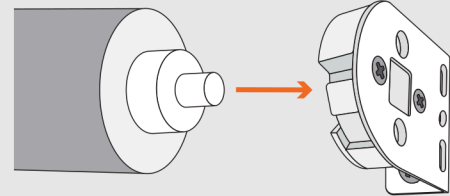
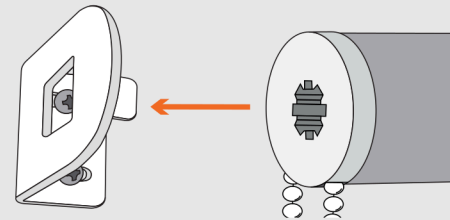
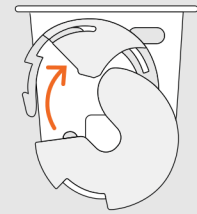

## STANDARD AND LARGE CASSETTE HEADRAIL

1. Grab the cassette and hold it up to your brackets. Set the back edge of the headrail onto the bottom tab of each bracket. While in this position, you can slide the shade left or right until the cassette is centered. 2. When you're ready to secure the headrail, push the headrail back until the top of each bracket snaps onto the top of the cassette.

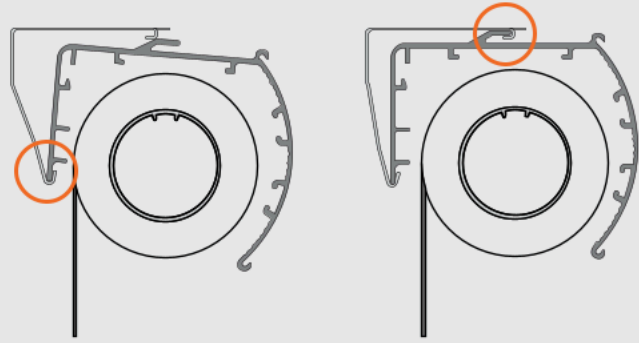

### 3. ADDITIONAL INSTRUCTIONS

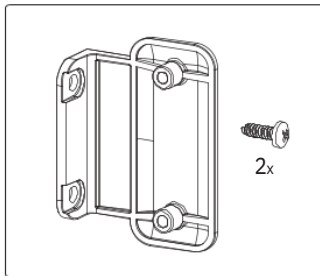
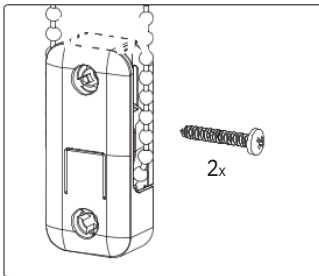

#### WARNING!

The safety device must be applied on chain loops and prevents free-hanging loops in operating chains. Install the safety device at the maximum distance possible from the control mechanism to prevent slack in the loop.

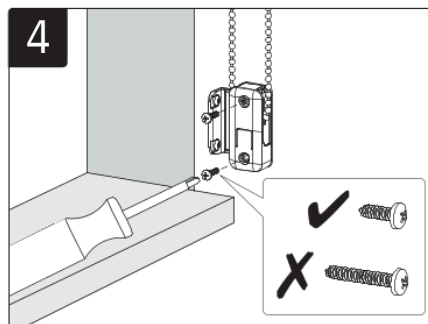
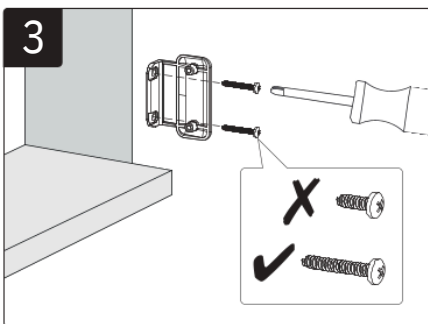
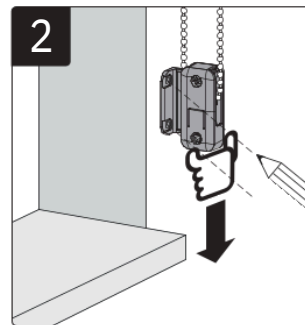
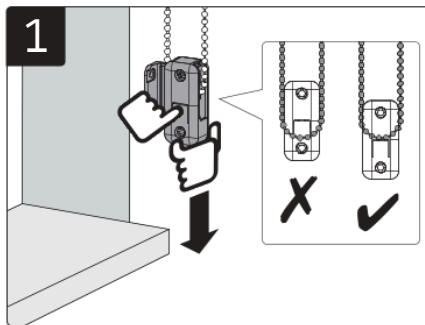
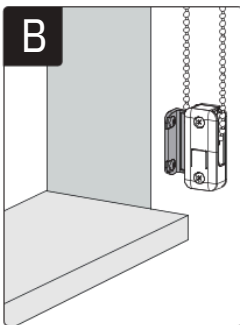
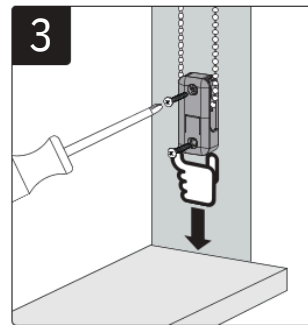
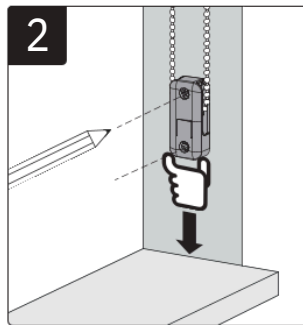
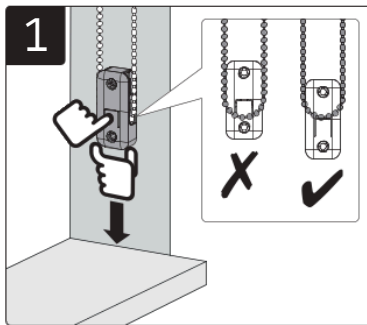
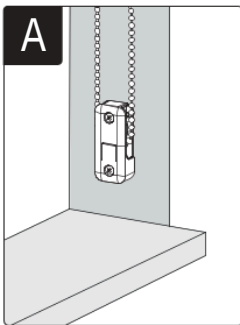
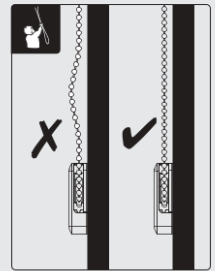

# ROLLER SHADES

## LIFT SYSTEM: MOTORIZATION



The difficulty level of this installation is ranked at **Level 2. You got this!**

If you have questions or get stuck, call our Customer Care Team at 888-257-1840, or email [customercare@selectblinds.com](mailto:customercare@selectblinds.com).

### HARDWARE AND PARTS INCLUDED

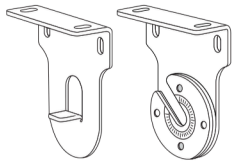

EXPOSED ROLL  
BRACKETS

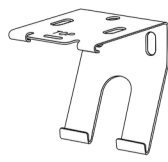

STANDARD CASSETTE  
BRACKETS\*

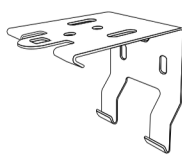

LARGE CASSETTE  
BRACKETS\*

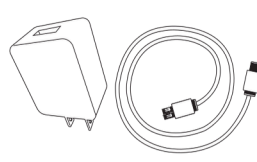

BATTERY CHARGER

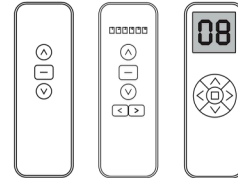

REMOTE CONTROL  
(1, 6, AND 16-CHANNEL)



INSTALLATION  
SCREWS

\*The quantity of brackets you receive will depend on the width of your cassette headrail.

### TOOLS REQUIRED



PENCIL



TAPE MEASURE



POWER DRILL



5/64" DRILL BIT



PHILLIPS BIT



PHILLIPS SCREWDRIVER



LEVEL



STEP LADDER

## 1. MOUNTING THE BRACKETS

### MOUNTING EXPOSED ROLL BRACKETS

The motor is hidden inside the roller tube on the right end of the shade. The **MOTOR BRACKET** goes on the right side of your window, and the **PIN BRACKET** goes on the left side. Regardless of your roll position (standard or reverse roll), the brackets are positioned the same.

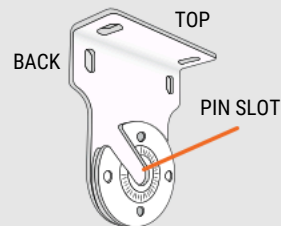

**PIN BRACKET  
(LEFT)**

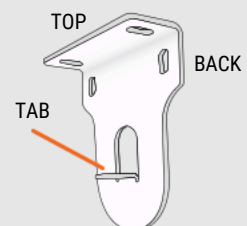

**MOTOR BRACKET  
(RIGHT)**

### EXPOSED ROLL - INSIDE MOUNT

**NOTE:** The steps for mounting an exposed roll shade are the same, regardless of the bracket style you received.

1. At the top-right corner of the window, measure how deep you wish to place your bracket (at least 2 1/4" required), and make a mark with your pencil. Repeat this step at the top-left corner of the window, using the same depth measurement.
2. Set the motor bracket in the window so that the back edge aligns with your mark. Hold the bracket in position and use your pencil to mark through the top screw holes. Repeat this step with your pin bracket on the left side of the window.
3. Pre-drill holes with a 5/64" drill bit at your previous marks on each side of the window.

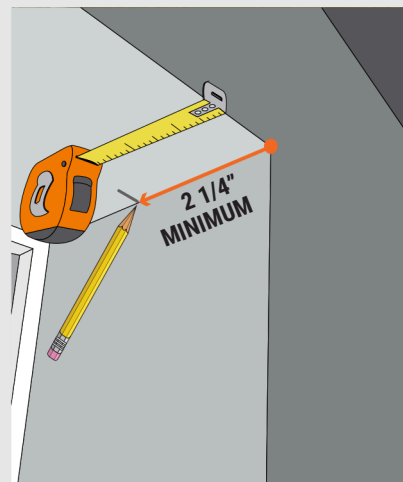

4. Line up each bracket with the holes you drilled, and insert the screws. Once you have secured both brackets, you're ready to mount the shade into the window (see page 16).

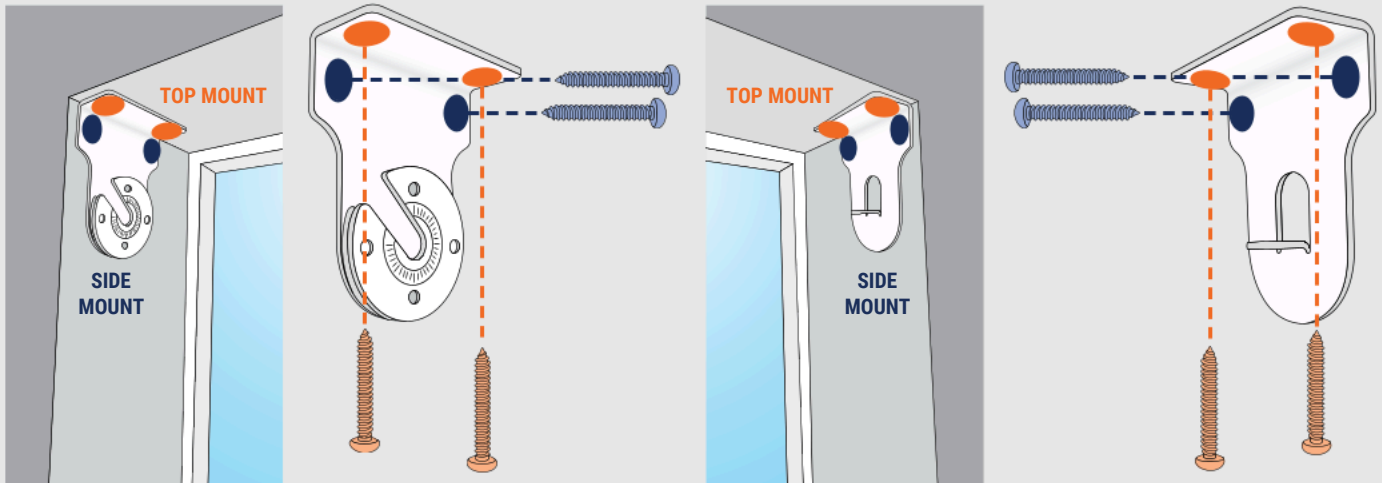

### EXPOSED ROLL - OUTSIDE MOUNT

**NOTE:** The steps for mounting an exposed roll shade are the same, regardless of the bracket style you received.

1. At the top-left and top-right corners of the window, measure the height you wish to place your brackets (at least 2" required) and make a mark with your pencil.
2. Determine the difference in width between your shade and your window, and then divide it in half. From your previous marks, measure this distance away from the window, and make another mark with your pencil.

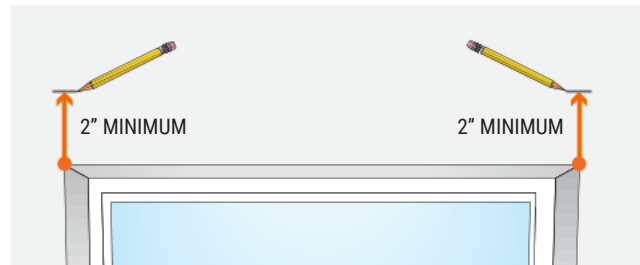

**EXAMPLE:** If your window is 48" wide and your roller shade is 52", the difference is 4". This means we measure and mark 2" away from the window, starting at the previous marks.

3. Center the motor bracket at the outermost mark as shown, and use your pencil to mark the screw holes. Repeat this step with your pin bracket at the outer-left mark.

4. Pre-drill the screw holes with a 5/64" drill bit at your marks on both sides of the window. Before you attach the brackets, you may want to erase any pencil marks that remain on the mounting surface.

5. Line up your motor bracket with the screw holes, and insert two screws to secure the bracket to the mounting surface. Repeat this step for your pin bracket. When both brackets are secure, you're ready to mount the shade into the window (see page 16).

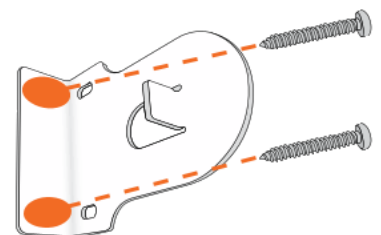
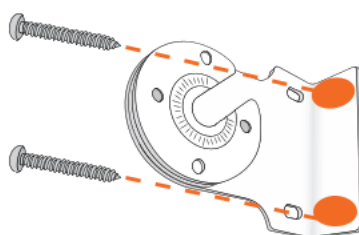
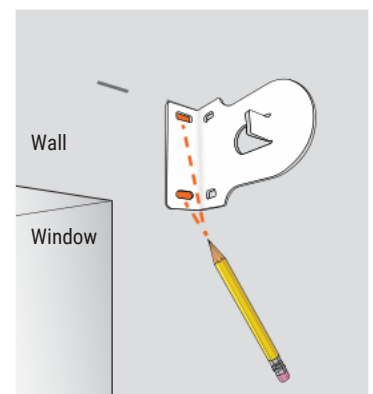
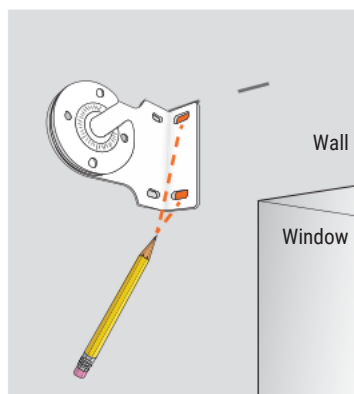



## MOUNTING CASSETTE HEADRAIL BRACKETS

**NOTE:** The roller shade tube is pre-installed in the cassette headrail, which simply snaps onto the provided hardware. You will receive two or more cassette brackets, depending on the width of your shade. **STANDARD CASSETTE BRACKETS** are included for cassette headrails 96" wide or smaller. **LARGE CASSETTE BRACKETS** are included for headrails over 96" wide.

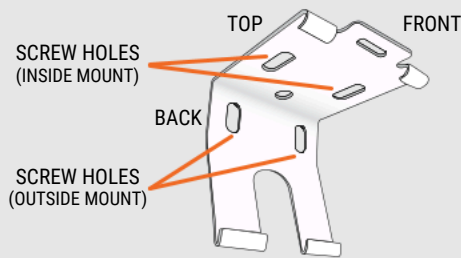

**STANDARD CASSETTE BRACKET**

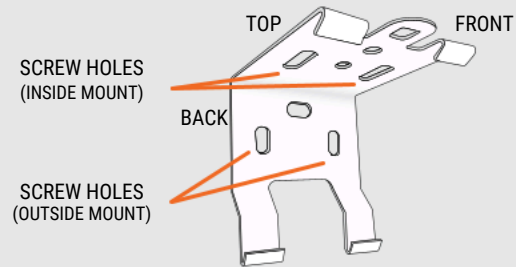

**LARGE CASSETTE BRACKET**

### CASSETTE HEADRAIL - INSIDE MOUNT

1. At the top corners of the window, measure inward and mark with your pencil 2" - 4" from each side. If you have additional brackets, make an additional mark for each one, evenly spaced between the outer marks.

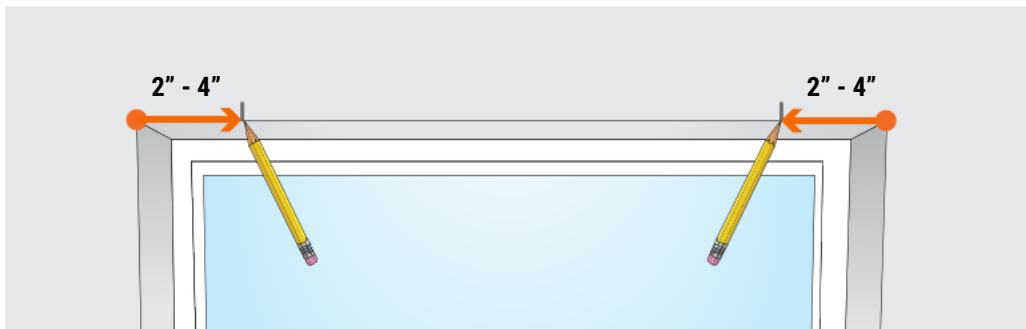

2. Next, you'll need to measure how deep to place your brackets in the window. Starting at one of your marks, measure back at least 2 5/8", and make a mark with your pencil. If you want the front of the cassette to be flush with the wall, measure back 3 1/4" and make a mark. Repeat this step until you've marked the same depth measurement for each bracket.

3. Position a bracket at the top of the window so that the back aligns with your mark. Make sure the front end of the bracket is parallel with the top edge of the window, then use your pencil to mark where the screws will go. Repeat this step until you've marked the screw holes for each bracket.

4. Pre-drill the screw holes with a 5/64" drill bit at your marks for each bracket location. Before you mount the brackets, you may want to erase any pencil marks that remain on the wall or window.

5. Line up your first bracket with the screw holes, and insert two screws to secure the bracket to the mounting surface. Repeat this step for any remaining brackets. When all brackets are secure, you're ready to mount the shade into the window (see page 16).

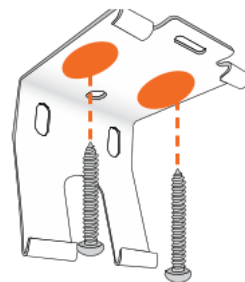
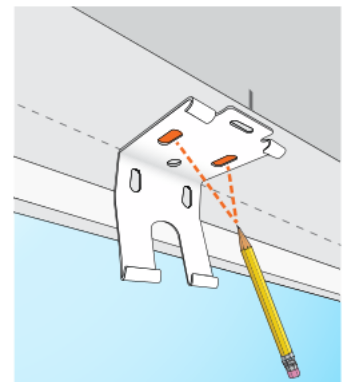
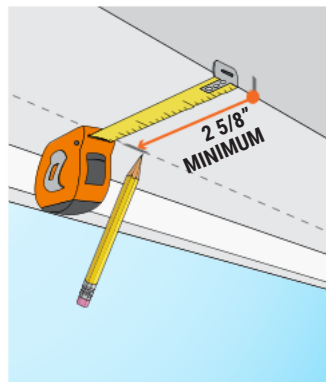

## CASSETTE HEADRAIL - OUTSIDE MOUNT

1. At the top corners of the window, measure inward and mark with your pencil 2" - 4" from each side. If you have additional brackets, make an additional mark for each one, evenly spaced between the outer marks.

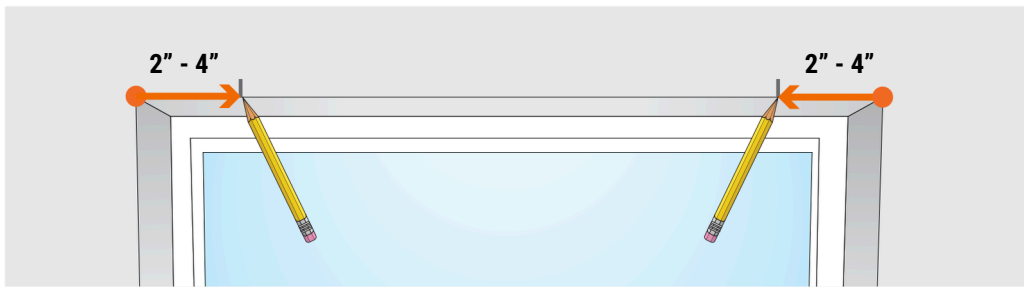

2. From one of these marks, measure upward and mark the height for the bracket placement. The minimum requirement is 1", but if you want the brackets to clear the top of the window, measure and mark at least 2 1/4" above your window. Repeat this until you've marked the same height measurement for each bracket.

3. Position a bracket so that the back is against your mounting surface, and the top is aligned with one of your upper marks. Hold the bracket in place and mark with your pencil where the screws will go. Repeat this until you've marked the screw holes for each bracket.

4. Pre-drill the screw holes with a 5/64" drill bit at your marks for each bracket location. Before you mount the brackets, you may want to erase any pencil marks that remain on the mounting surface.

5. Line up your first bracket with the screw holes, and insert two screws to secure the bracket to the mounting surface. Repeat this step for any remaining brackets. When all brackets are secure, you're ready to mount the shade into the window (see below).

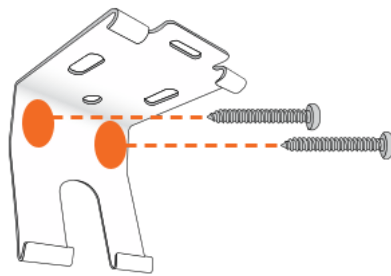
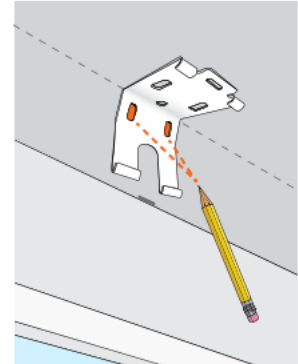
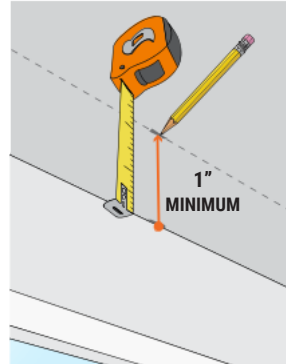

## 2. ATTACHING THE SHADE

**NOTE:** Before you attach the shade to the brackets, check that your brackets are straight and aligned with each other. The screw holes on all brackets are elongated, so making small adjustments is easy.

**Inside Mount:** Use a tape measure to check that each bracket is set to the same depth. If you need to make adjustments, slightly loosen the screws on a bracket and shift it back or forward. Secure the screws when the position is corrected.

**Outside Mount:** Use a tape measure to check that each bracket is set to the same height, and use a level on top of each bracket to make sure they're all straight and aligned. If you need to make adjustments, slightly loosen the screws on a bracket and shift it until it's level and set to the correct height.

### EXPOSED ROLL

1. While holding the roller shade in your hands, locate the gear-shaped hole in the motor head on the right end of the shade. Slide this hole firmly onto the tab of the motor bracket.

2. Locate the pin on the left end of the shade, and gently slide it into the center slot on the pin bracket.

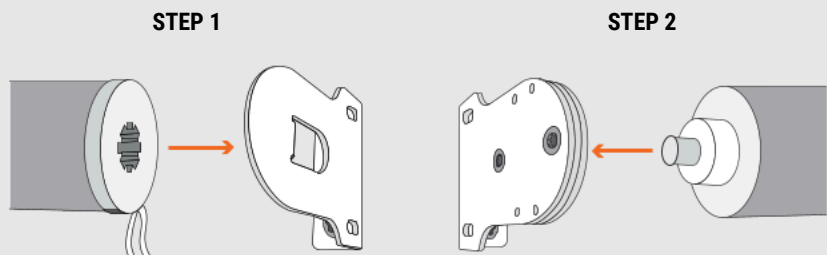

## STANDARD AND LARGE CASSETTE HEADRAIL

1. Grab the cassette and hold it up to your brackets. Set the back edge of the headrail onto the bottom tab of each bracket. While in this position, you can slide the shade left or right until the cassette is centered.
2. When you're ready to secure the headrail, push the headrail back until the top of each bracket snaps onto the top of the cassette.

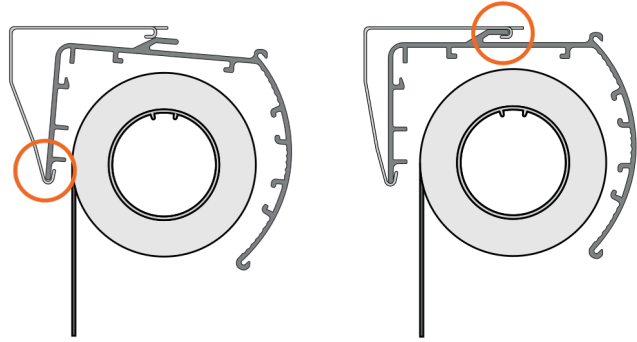

## 3. PROGRAMMING AND USING YOUR REMOTE

**IMPORTANT:** While it is not necessary to follow the steps below, we recommend familiarizing yourself with the basics of programming the motor and your remote to better understand how your motorized shade works. Please note that the batteries in your shade's motor were fully charged at the factory prior to shipment. Your shade's upper and lower limits (when it's fully raised or lowered) have also been pre-set. A channel number has also been assigned to each shade on your remote.

DO NOT attempt to raise or lower your motorized shade with your hands. This may cause permanent damage to the motor, and other components in the headrail, which may not be covered under your warranty.

### OPERATIONAL FUNCTIONS

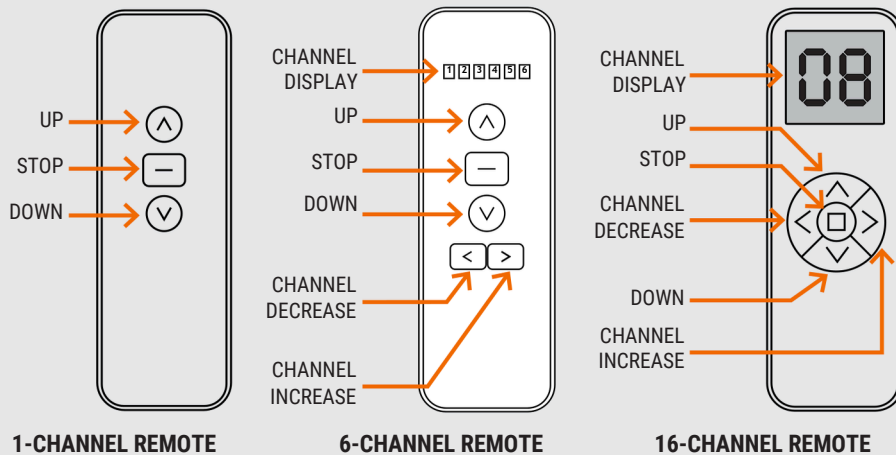

### PROGRAMMING FUNCTIONS

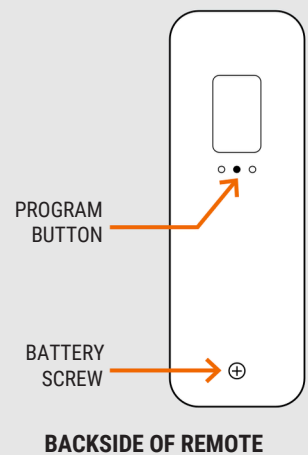

## PAIRING A SINGLE SHADE TO A CHANNEL

1. Press the **CHANNEL INCREASE** or **CHANNEL DECREASE** button on the remote to select a dedicated channel for the first shade you're pairing with the remote.
2. Locate the **MOTOR HEAD** on the left end of the roller tube under the headrail. Press and hold the **PROGRAM** button until you hear a beep and the shade "jogs" quickly up and down.
3. Press the **UP** button on the remote and the shade will jog again.
4. Congrats! Your shade and remote are now paired. Repeat this process for any additional shades you want to pair with the remote, selecting a new channel (if using a multi-channel remote) before you begin.

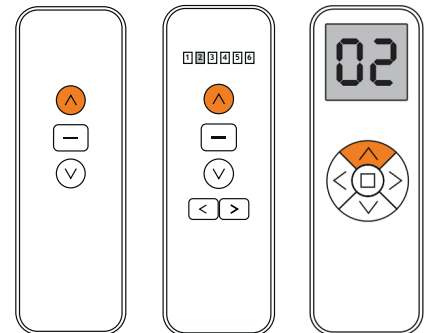
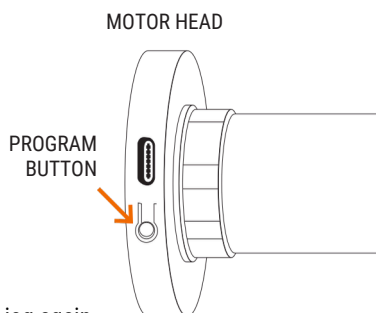

## ADJUSTING THE UPPER/LOWER LIMITS

Your shade's upper and lower limits are already pre-set at the factory, so the following steps are only necessary if you want to change how these settings are configured. The upper limit can ONLY be changed after performing a factory reset (see page 19).

### CHANGING THE UPPER LIMIT

1. Move the shade using the **UP** or **DOWN** buttons, until it is positioned about 6" below the desired upper limit.
2. Press the **PROGRAM** button on the back of the remote. The shade will jog, indicating it's now in programming mode.
3. Press the **UP** button to move the shade to the desired upper limit. Press the **PROGRAM** button on the back of the remote again and the shade will jog.
4. That's it! You've now reset your shade's upper limit, and the motor will exit programming mode automatically.

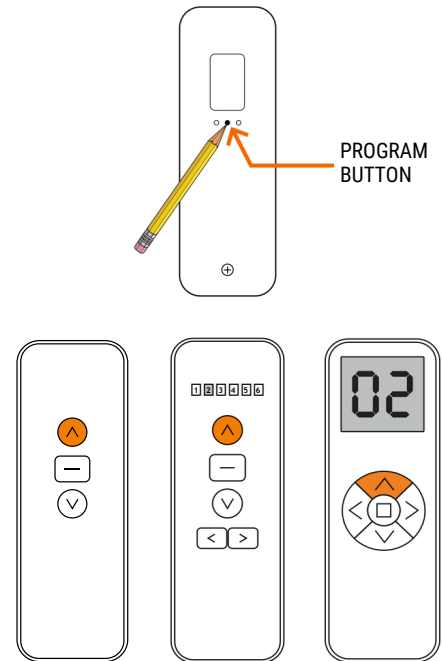

### CHANGING THE LOWER LIMIT

1. Move the shade using the **UP** or **DOWN** buttons, until it is positioned about 6" above the desired lower limit.
2. Press the **PROGRAM** button on the back of the remote. The shade will jog, indicating it's now in programming mode.
3. Press the **DOWN** button to move the shade to the desired lower limit. Press **PROGRAM** on the back of the remote again and the shade will jog.
4. That's it! The lower limit is set, and the motor will exit programming mode automatically.

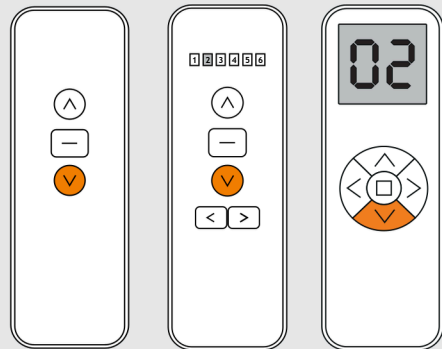

### SETTING INTERMEDIATE POSITIONS

**NOTE:** You can set up to four (4) intermediate positions between the shade's upper and lower limits. Each intermediate position must be at least 6" away from the upper and lower limits, and any other intermediate limits you program.

1. Move the shade using the **UP** or **DOWN** buttons until it's at least 6" away from any other limits.
2. Press the **PROGRAM** button on the back of the remote. The shade will jog, indicating it's now in programming mode.
3. Use the **UP** or **DOWN** button to move the shade to the desired stopping position and press the **PROGRAM** button again. The shade will jog, indicating the new stopping point is now set.
4. Repeat these steps to add up to four intermediate stopping points to your shade.

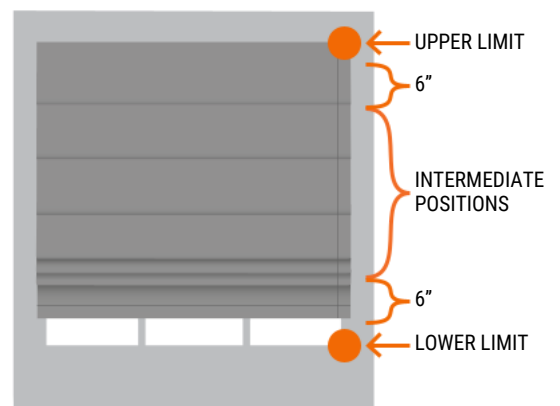

## DELETING LOWER LIMITS AND INTERMEDIATE POSITIONS

**NOTE:** Lower limits and intermediate positions can be deleted and reassigned. Upper limits can only be removed by performing a factory reset.

1. To delete a specific shade position, use the **UP** or **DOWN** buttons to move the shade to the position you want to remove.
2. Press and hold the **PROGRAM** button on the back of the remote for about 7 seconds. The shade will jog once before the 7 seconds and once after. You have now deleted the limit/position from your shade.

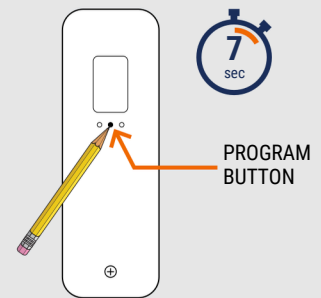

## PERFORMING A FACTORY RESET

1. Press the **PROGRAM** button on the **MOTOR HEAD** four (4) times in a row.
2. Press 4 times and hold on the 4th. Wait for 1 red LED flash with the 1st press, 1 red LED flash with the 2nd press, 2 red LED flashes with the 3rd, and 2 red LED flashes and a motor oscillation with the 4th. After the oscillation the memory is erased.
3. Your shade's memory and all presets have now been erased. To use the shade again, pair it to a channel (see page 5, "Pairing a Single Shade to a Channel"), and then set new upper/lower limits.

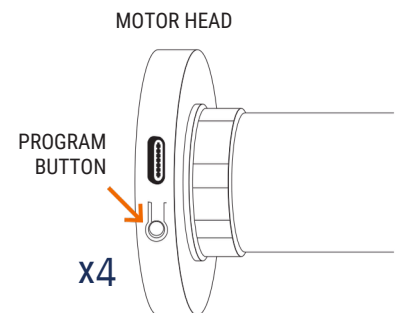

## USING THE REMOTE TO CONTROL YOUR SHADE

1. Press the **UP** or **DOWN** button once to move the shade to the next pre-set position.
2. Press the **UP** or **DOWN** button two times (once per second) and the shade will move to the upper or lower limit position without stopping at any intermediate positions.
3. When the shade is in the top position, the **UP** button becomes non-functional. Likewise, when the shade is in the bottom position, the **DOWN** button becomes non-functional.

## CONTROLLING MULTIPLE SHADES SIMULTANEOUSLY

6 Channel Remote: Press the **CHANNEL INCREASE** button on the remote until all 6 lights on the **CHANNEL DISPLAY** are illuminated. This activates all six channels simultaneously, which allows you to control up to 6 shades at the same time.

16 Channel Remote: Press the **CHANNEL INCREASE** button on the remote until you see "CC" on the **CHANNEL DISPLAY**. This activates all sixteen channels simultaneously, which allows you to control up to 16 shades at the same time.

## RECHARGING THE SHADE BATTERY

**NOTE:** If the shade begins to move at a slower pace, the battery charge may be getting low. Plug the shade into a power outlet and charge the battery for 6 hours.

1. Locate the charger port on the left side of the headrail. Connect the USB-C cable to the provided battery charger.
2. Plug the battery charger into the nearest wall outlet. If the cable isn't long enough to reach an outlet, use an extension cord (not included) to bridge the gap.

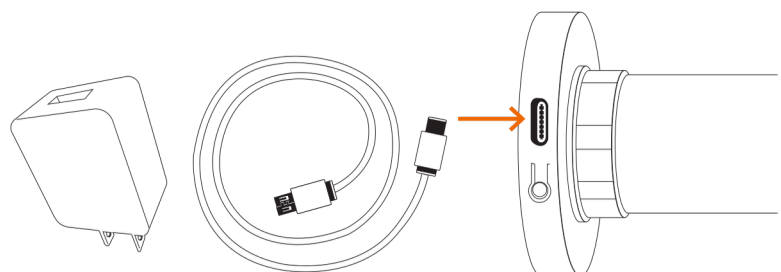

## REPLACING THE REMOTE BATTERY

**NOTE:** The battery used to power your remote is a coin-shaped 3V cell battery (CR2032). Additional batteries are not included.

1. To remove the back cover of the remote, use a small screwdriver to remove the battery screw. Gently slide the back cover up to disengage it, then lift it away from the remote.
2. Remove the old battery from the circuit board by sliding it diagonally out of the bracket holding it down. Place a new 3V cell battery in the bracket with the "+" positive side showing.
3. Replace the back cover of the remote, and secure the battery screw.

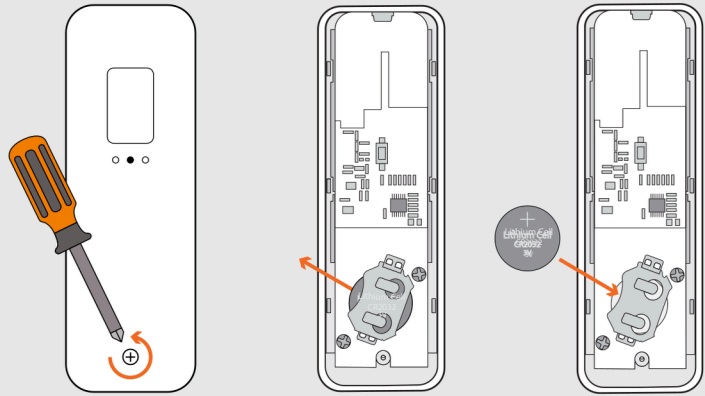

## INSTALLING A WALL MOUNT CARRIER

**NOTE:** A wall mount carrier is included with your remote, but it is optional to install it. If you choose to mount the carrier with the adhesive patch on the back, be sure to clean and dry the mounting surface first.

1. Determine where you'd like to place your remote carrier in the room. It is common to place it near a light switch, or on the wall next to the window.
2. With the carrier in the upright position, insert the provided screws to secure it to our mounting surface. If you're using the adhesive patch, remove the backing and firmly press the carrier to the clean surface for about 30 - 45 seconds.

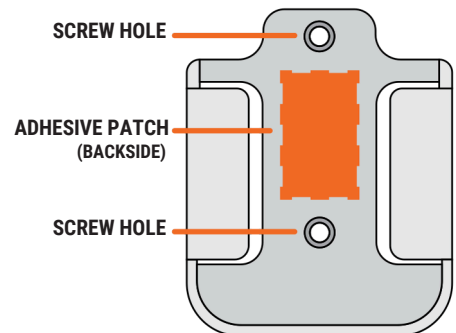

## CLEANING INSTRUCTIONS

**NOTE:** All fabrics are different and some may be easier to clean than others. We recommend cleaning your shades as often as once a month. Here are some general guidelines on how to do so:

1. For regular maintenance, use a duster or a vacuum with a brush attachment and run it over the front and back of the shade.
2. To spot clean stains, use a damp rag with a very mild, gentle detergent or soap. Dab at the affected spots; do NOT rub! Let the dampened area

air-dry and repeat as necessary.

## WARRANTY AND REPLACEMENT

To learn more about our product warranties, please visit: <https://www.selectblinds.com/warranty.html>

For replacement parts, and/or to file a warranty claim for a product that is damaged, defective, or missing parts, please call our Customer Care Team at 888-257-1840, or email [customercare@selectblinds.com](mailto:customercare@selectblinds.com).

## CHILD SAFETY WARNING

### ⚠ WARNING

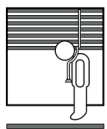

**Corded window blinds and shades can be a strangulation risk or cause serious injury to young children and pets.** When using corded window treatments, use the following tips to keep them safe:

- Move furniture that children can climb on away from the window.
- **NEVER** place a crib by a window!
- Keep cords up and away from your child's reach.
- Always use cord cleats with corded products.
- Secure child-safe tensioners for continuous cord loop chains to the wall or window encasement.



# No-Drill Blinds Headrail



The difficulty level of this installation is ranked at **Level 1**. *A piece of cake!*

If you have questions or get stuck, call our Customer Care Team at 888-257-1840, or email [customer care@selectblinds.com](mailto:customer care@selectblinds.com)

## 1. Preparing the No Drill Blinds Headrail

Pull the lever from below or push down on the mechanism from above to retract the tension boot (See Fig B).

Install the metal strips or padded adhesive tape on opposite sides of the window opening where you'll be installing the No-Drill Blinds Headrail. This is optional and only available on larger products.

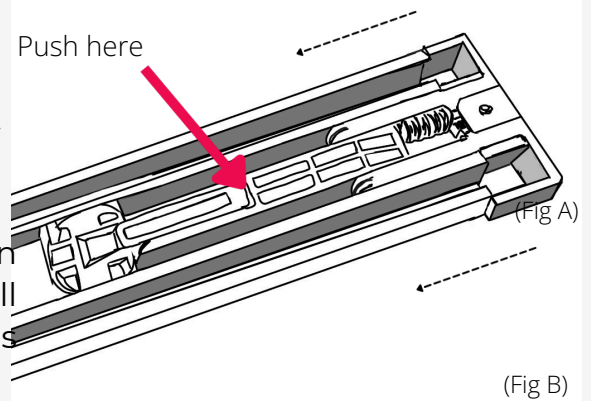

## 2. Installing the No Drill Blinds Headrail

Insert the No-Drill Blinds Headrail into the window opening, make it flush with the top of the window opening, then push on the lever to extend the tension spring and secure the No-Drill Blinds Headrail. (See Fig C)

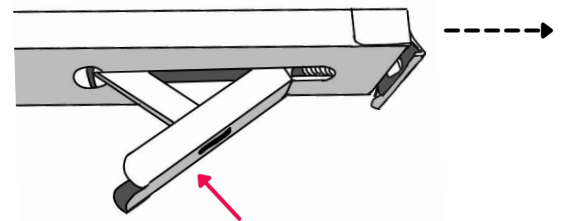

## 3. Installing the Product

Install the product onto the brackets (See Fig D). Test and operate the product to ensure secure installation and smooth functionality.

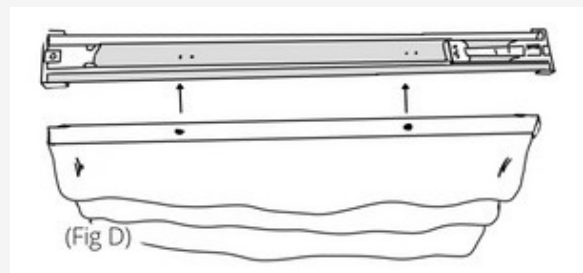

## Uninstalling the No Drill Blinds Headrail

To uninstall the product, follow step 1 by removing the product from the headrail and use a screwdriver to unlatch the lever.

Make sure to hold the No Drill Blinds Headrail in place while unlatching the lever. This will prevent damage to the window or headrail.

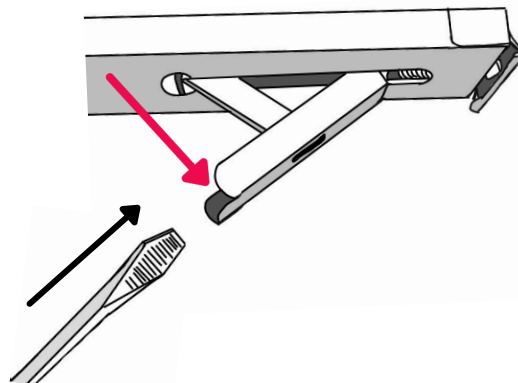

## Tech Tip

If the fixed boot end was accidentally forced out, use a flathead screwdriver to twist the red "droplets" towards the center and then push it back in.

