

# Click2Fit Total Blackout Roller Shades

## Install Guide

### PARTS INCLUDED

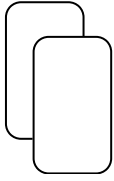

Headrail Light  
Blocking Covers

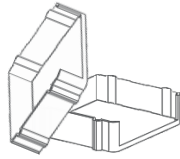

End Caps

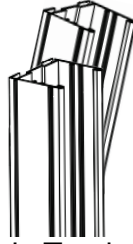

Side Tracks

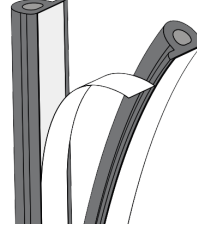

Light Sealing Strip



This is a Level 2 Install.

### Installation

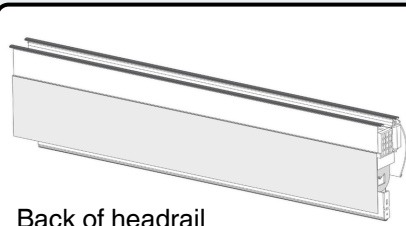

Back of headrail

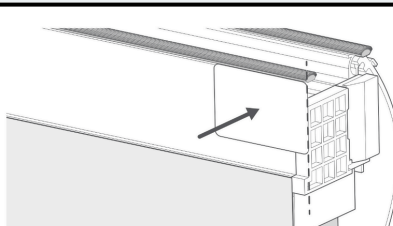

Start by turning the headrail around and attaching the Headrail Light Blocking Covers.

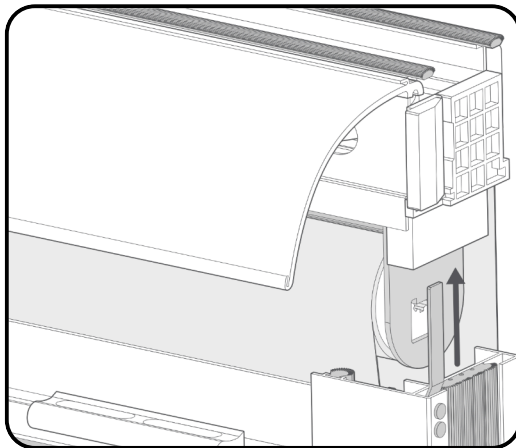

Attach the side rails to the channels on each side of the headrail.

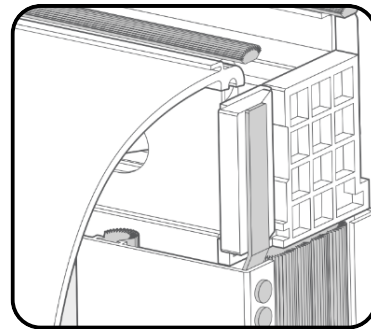

Make sure the support rod is on the outside of the headrail boot.

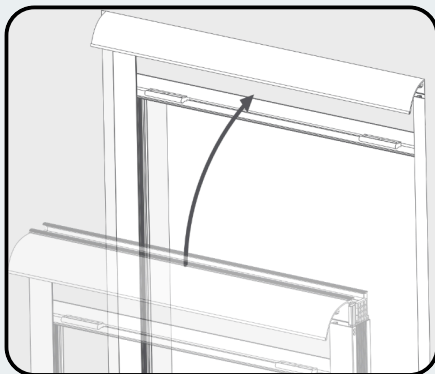

With both rails attached, lift the full assembly into the window.

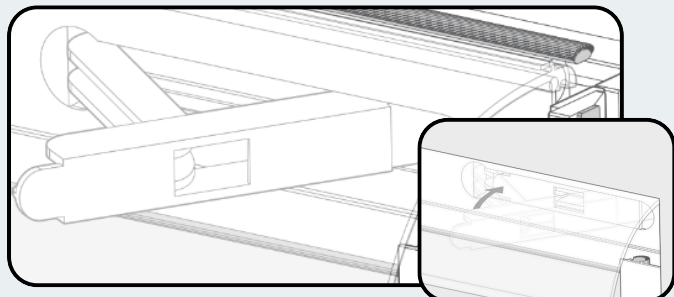

Make sure the lever is not pressed in during installation so the headrail will fit into the opening. Push the lever to click in place while holding the headrail up to the top of the window opening.

# Click2Fit Total Blackout Roller Shades

## Install Guide

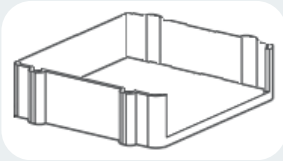

Attach the bottom cap to each of the side tracks to ensure there is no damage to the bottom of the window opening.

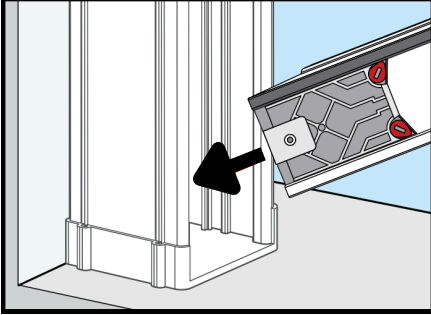

Make sure the side track is set slightly back in the window, about 1/4". Insert the bottom Click2Fit rail with the flange in the front, then rotate it towards you so the bottom lies flat on the bottom of the window sill.

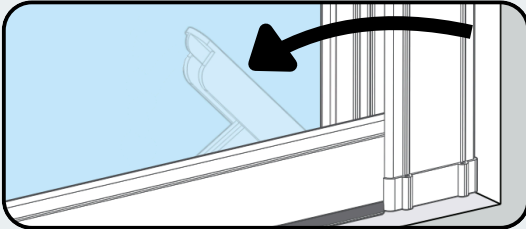

Push the lever down and lock it in place.

Test out the shade and adjust as needed for smooth operation.

**Congratulations! You've just installed your Click2Fit Total Blackout Roller Shades!**

### Optional Installation

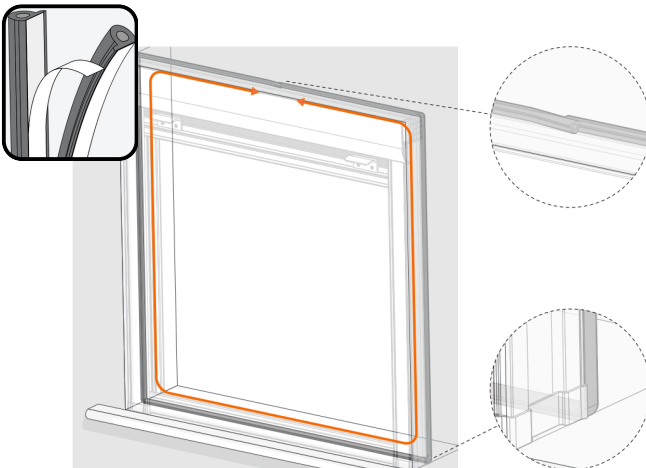

If you have gaps, add the included Light Sealing Strip to the outside edge of the side tracks to block additional light.

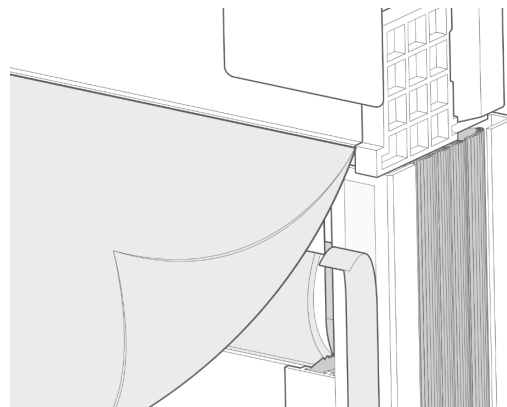

Peel the adhesive strip on the back of the side channels and attach the blackout skirt to block additional light.

**Cleaning:** To clean the shade fabric, use a feather duster or vacuum lightly using a soft brush attachment.