

LEVOLOR®

Roller Shades—Fabric/Solar Cortinas enrollables: en tela / solares

Stores à enroulement automatique – Tissu / solaire

INSTALLATION • OPERATION • CARE
INSTALACIÓN • MANEJO • CUIDADO
INSTALLATION • UTILISATION • ENTRETIEN

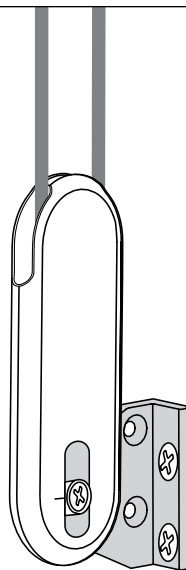
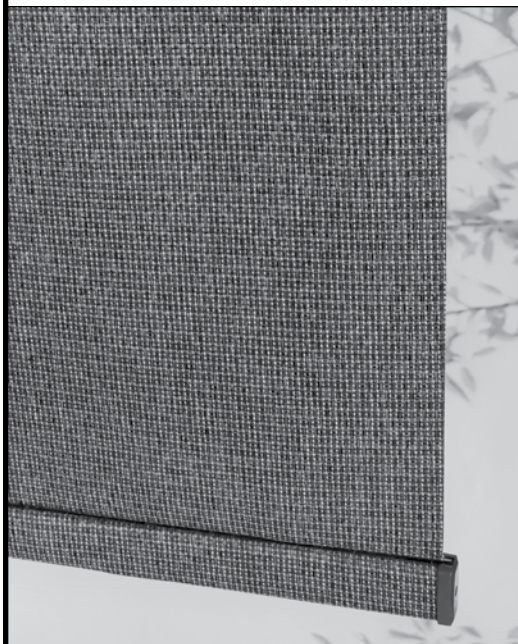

Continuous Cord Loop Lift Control - Roll

Control de elevación del circuito de
cordón continuo: rodillo abierto

Commande de levage avec cordon à
boucle continue – Rouleau ouvert



Young children can **STRANGLE** in cord loops. They can also wrap cords around their neck and **STRANGLE**.

- Always keep cords out of the reach of children.
- Move cribs, playpens and other furniture away from cords. Children can climb furniture to get to cords.

Cord Loop Tension Device

- Attach the tension device on the cord loop to the wall or window casement. See “Install the Tension Device” on page 11. This can prevent children from pulling cord loops around their necks.
- For the shade to operate properly, the cord tensioner must be correctly mounted and secured.
- Fasteners provided in this kit may not be appropriate for all mounting surfaces. Use appropriate anchors for mounting surface conditions.
- Only supplied tension device and hardware should be used. Replacement parts may be obtained by contacting Customer Service at 1-800-538-6567

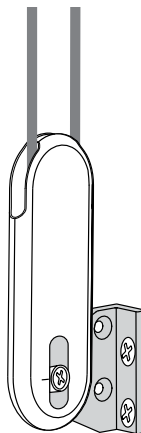
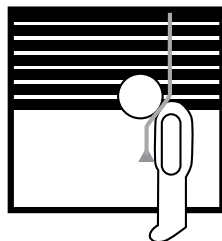

Canadian Residents Only: For more safety information: 1-866-662-0666 or visit www.canada.ca, search "blind cords".



WARNING: Keep all small parts, components and packaging away from children as they pose a potential choking hazard which may result in serious injury or death. Please reference all warning tags and labels in the instructions and on the shade.

Window and Shade Terminology

Mounting Types and Window Terminology	4
---	---

Getting Started

Components Included	5
Tools and Fasteners You May Need	6

Installation

Inside Mount	7–8
Outside Mount	9–10

Installation – Additional Components

Continuous Cord Loop Tension Device	11
Hold-Down Brackets (Optional)	12

Operation

Operating the Shade	12
---------------------------	----

Uninstall

Removing the Shade	13
--------------------------	----

Cleaning and Care..... 14**Additional Information and Support**

Troubleshooting	15
Warranty	15
Customer Service Support	15

WINDOW AND SHADE TERMINOLOGY

Thank you for purchasing LEVOLOR® Roller Shades. With proper installation, operation, and care, your new roller shades will provide years of beauty and performance. Please thoroughly review this instruction booklet before beginning installation.

MOUNTING TYPES AND WINDOW TERMINOLOGY

If the installation brackets are mounted correctly, the rest of the installation process follows easily. To prepare for this important first step, review the mounting types and basic window terminology illustrated below.

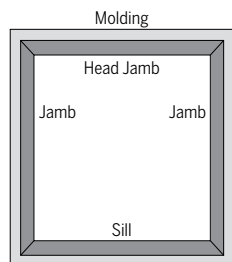

Window Components Terminology

- Collectively, the sill and jambs are called the "window casement" or "frame".

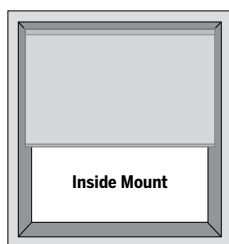

Inside Mount

- Shade fits within window opening.
- Great for windows with beautiful trim.

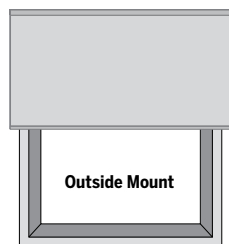

Outside Mount

- Shade mounts outside window opening.
- Increased light control and privacy.

INSTALLATION OVERVIEW

- **Leaving the shade rolled up completely will ease installation.**
- Confirm that the headrail and shade are the proper width and length.
- If installing several sets of shades, be sure to match them with the appropriate window.
- Check the installation surface to ensure that you have suitable fasteners and tools.
- Lay out and organize all parts and components.
- Proper shade direction during installation:
 - For Traditional Roller Shades, fabric will hang off the back of the shade, closest to the window.
 - For Optional Reverse Roller Shades, fabric will hang off the front of the shade.

COMPONENTS INCLUDED IN THE BOX

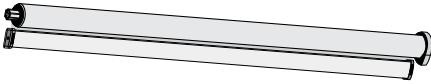

Roller Shade

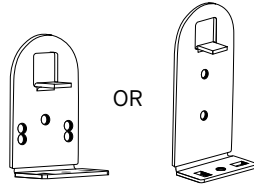

Mounting Brackets
(Bracket determined by
shade size)

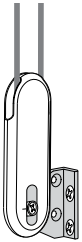

Cord Loop
Tension Device



Hex Head Screws
(2 per Bracket)

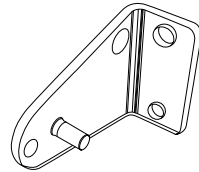

Hold Down Brackets
(optional)

- Shade
- Mounting Brackets
- Installation Hardware and screws

Optional items will be included, if selected at time of shade order.

GETTING STARTED

TOOLS AND FASTENERS YOU MAY NEED (not included)

The tools you will need for installing your shade will vary, depending on the installation surface and mounting bracket type.

Tools typically used for installation include:

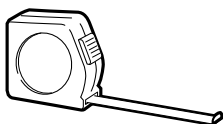

Metal Tape Measure

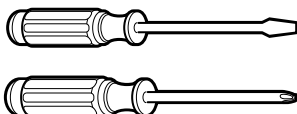

Screwdrivers
(both flat and Phillips head)



1/4" Nutdriver



Safety Glasses

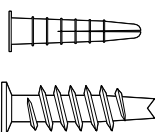

Drywall Anchors



Pencil

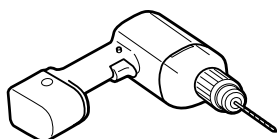

Drill with Bits



Level

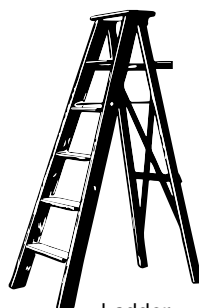

Ladder



CAUTION: Use drywall anchors when mounting into drywall. (Not provided.) Failure to properly anchor shade could cause shade to fall possibly resulting in injury.

INSIDE MOUNT (IM)

STEP 1: MARKING THE BRACKET LOCATIONS

IMPORTANT: Before marking bracket locations, ensure that your bracket placement will not interfere with any components inside the headrail.

- Verify that your window casing has a minimum depth of 1 ½" which allows for a partially recessed headrail mount.
- If flush mount (fully recessed mount) is desired, a minimum mounting depth of 2 ½" is required.
- Place brackets at either end of inside mount frame.
- Mark 1–2" from each jamb for bracket location.
- With a pencil, mark the longer, oblong drill hole locations through the top of the holes of the bracket, 2 holes per bracket.

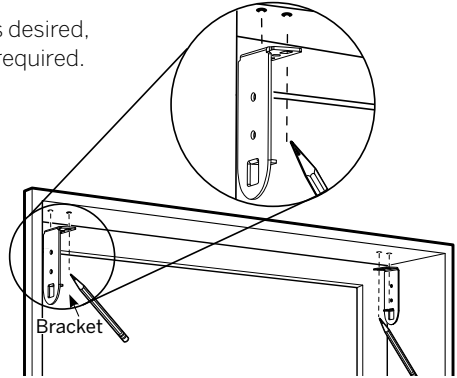

STEP 2: INSTALLING THE BRACKETS

- Pre-drill screw holes using a 1/16" drill bit (wood and metal mounting surfaces only) using pencil marks as a guide.
 - If installing brackets into wood, use supplied screws.
 - If installing into drywall, use anchors in combination with supplied screws.
- While holding the bracket in place, secure the bracket with screws, 2 screws per bracket.
- Ensure all brackets are square with each other.

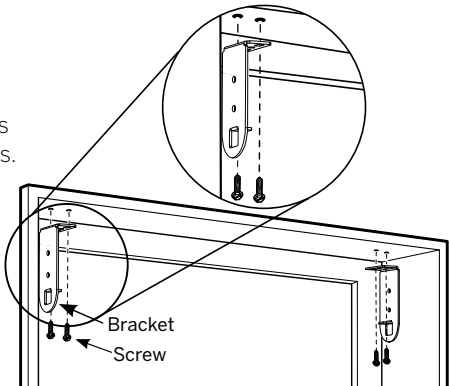

INSTALLATION

INSIDE MOUNT (IM)

STEP 3: INSTALLING THE SHADE

- Place bead-chain side of shade into end bracket first.
- On the other side of shade, compress the spring loaded end plug and secure into opposite bracket.
 - Shade is secure when spring clicks into bracket.
- Slide bracket end caps over brackets for a finished appearance.

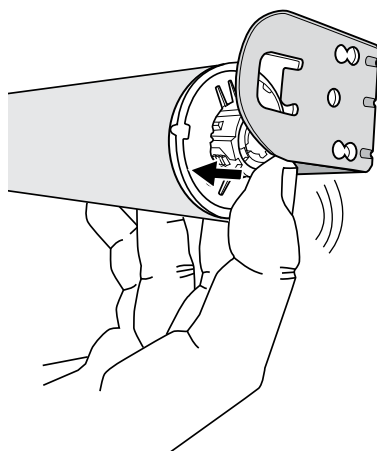
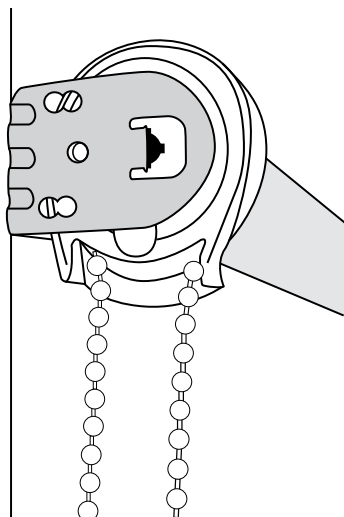

CAUTION: Be sure the brackets are properly engaged before operating the shade. Failure to do so may result in the shade falling and possible injury.

OUTSIDE MOUNT (OM)

STEP 1: MARKING THE BRACKET LOCATIONS

IMPORTANT: The brackets must be flush against a flat mounting surface. Do NOT mount brackets on curved molding.

- Center the headrail over the window opening at the desired height.
- Mark screw locations for each end bracket, 2 holes per bracket.
 - Use a level to ensure all brackets are aligned.

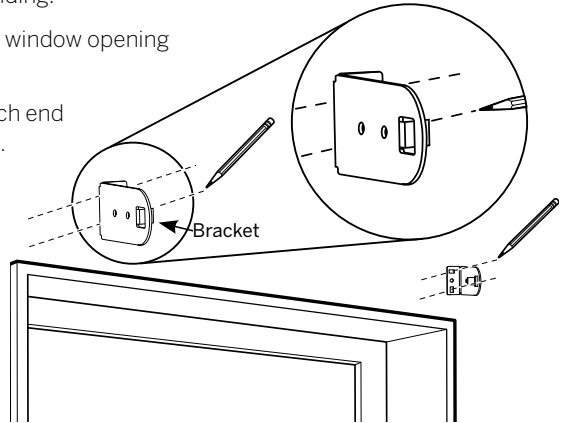

STEP 2: INSTALLING THE BRACKETS

- Pre-drill screw holes using a $\frac{1}{16}$ " drill bit, using pencil marks as a guide.
 - If installing brackets into wood, use supplied screws.
 - If installing into drywall or other, use anchors in combination with supplied screws.
- Screw in brackets at marked locations, 2 screws per bracket.
- Ensure all brackets are square with each other.

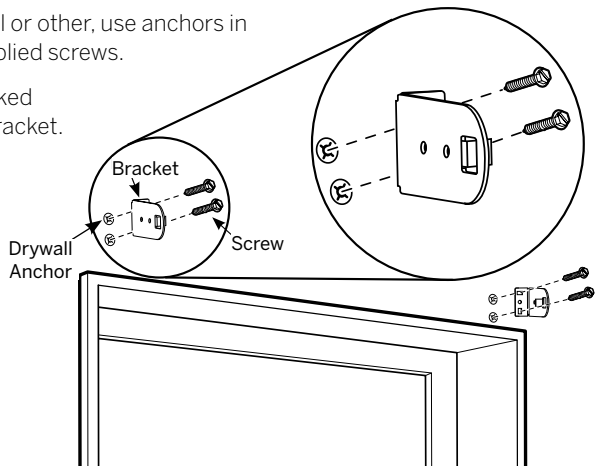

INSTALLATION

OUTSIDE MOUNT (OM)

STEP 3: INSTALLING THE SHADE

- Place side of shade with the bead chain into end bracket first.
- On the other side of shade, press in the spring loaded end plug and secure into opposite bracket.
 - Shade is secure when spring clicks into bracket.
- Slide bracket end caps over brackets for a finished appearance.
 - The wider end cap covers the spring end plug side bracket.
 - The narrower end cap covers the bead chain side bracket.

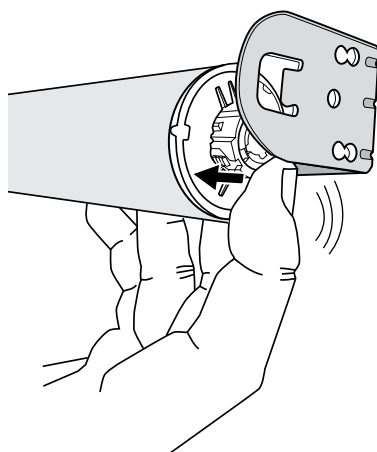
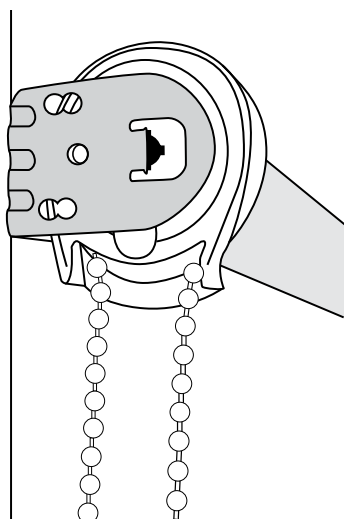

CAUTION: Be sure the bracket and headrail are properly secured before operating the shade. Failure to do so may result in the shade falling and possible injury.

CONTINUOUS CORD LOOP CORD TENSION DEVICE

- Continuous Cord Loop Shades will arrive with the tension device mounted to the shade.
- Use the included screws to secure the hold-down tension device to the mounting surface, ensuring that the cord loop is taut.
- **SEE WARNING LABEL ON SHADE**

Install the Tension Device

IMPORTANT: Before you proceed, you must first slide the cord tensioner to the bottom of the cord loop.

- Insert a small screwdriver, punch, or awl through the screw hole at the bottom of the cord tensioner.
- Move the screw hole down to the indicator line to release the safety mechanism.
- Slide the cord tensioner down to the bottom of the cord loop.
- Attach the cord tensioner according to the instructions provided with the Universal Cord Tensioner Installation Kit.

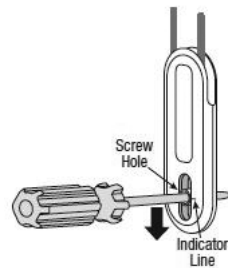

WARNING: It is imperative that the cord tensioner be properly secured to the wall or window frame to reduce children's access to the cord loop. Young children can strangle in cord loops. They can also wrap cords around their necks and strangle.



CAUTION: The shading will not operate properly unless the cord tensioner is secured. A universal Cord Tensioner Installation Kit has been included with your shading. Follow the instructions in the kit to correctly secure the cord tensioner.

INSTALLATION – ADDITIONAL COMPONENTS

HOLD-DOWN BRACKETS (optional)

- Ideal for doors, hold-down brackets prevent shade from swaying. Assemble as shown to each side of bottom rail.
- Position hold-down brackets against wall/frame, mark screw hole locations.
- Screw into marked hole locations.

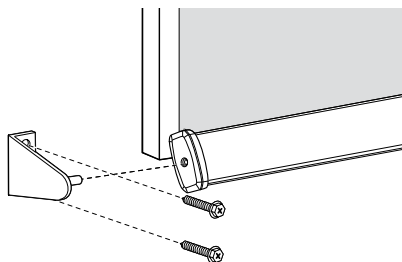

OPERATION

CONTINUOUS CORD LOOP

- Pull the rear cord of the cord loop to lower the shade to the desired height.
- Pull the front cord of the cord loop to raise the shade to the desired height.



WARNING: If the tension device moves up the cord, you have not secured the tension device to the wall or window frame. You must do so for the shade to operate properly and to help protect young children from accidental strangulation.

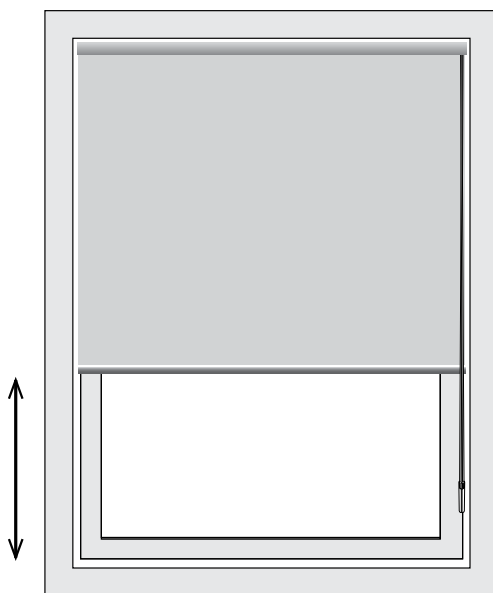

REMOVING THE SHADE

- Fully raise the shade.
- Locate clear, plastic locking ring on spring-loaded end plug.
 - Note – This is the side without the cord loop chain.
 - 1— Rotate ring until to unlock;
 - 2— Press shade toward the mounting bracket;
 - 3— Carefully lower shade from mounting brackets.
- Uninstall remaining brackets if necessary.

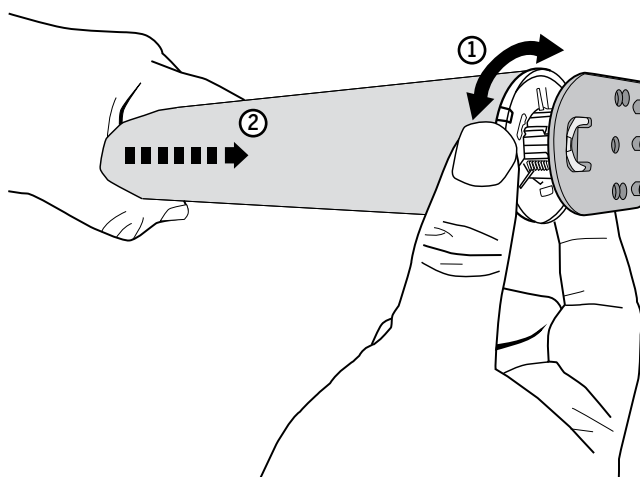

CAUTION: Hold shade firmly when removing. Failure to do so may result in the shade falling and possible injury.

CLEANING AND CARE

CLEANING PROCEDURES

All LEVOLOR Roller Shades have multiple cleaning options.

NOTICE: Avoid contact with window cleaning products. Improper cleaning may void warranty.



DUSTING

Use a feather duster for regular cleaning.



FORCED AIR

Blow away dirt and debris using clean compressed air.



PROFESSIONAL INJECTION/EXTRACTION CLEANING

Call local on-site blind/shade cleaner that injects a cleaning solution into the fabric and extracts the dirty solution at the same time. The service is typically performed at home so you do not need to remove your window treatments.



VACUUMING

Use a low suction vacuum with a brush-type cleaner attachment; stroke lightly over the shade to clean.



SPOT-CLEANING/STAIN REMOVAL AT HOME

Use warm water and a mild soap, like Woolite® or Scotchgard®, if needed. Do not immerse shade in water.

TROUBLESHOOTING TIPS

- Do not lower the shade past the ordered length. (If it is lowered beyond the limit, the tube underneath the roller will be exposed and fabric damage could occur.)

WARRANTY

For complete warranty information visit LEVOLOR.com or call Customer Service at 1-800-LEVOLOR or 1-800-538-6567.

CONTACTING US

To contact LEVOLOR Customer Service regarding any questions or concerns you may have about your new shades, you may reach us at: 1-800-LEVOLOR (8:30 am – 6:30 pm EST)

www.LEVOLOR.com

ADDITIONAL PARTS AND SERVICES

Additional or replacement parts can be ordered, or shades can be repaired or restrung through our repair center. Please contact LEVOLOR customer service through www.LEVOLOR.com for a return authorization number.

LEVOLOR®

Roller Shades—Fabric/Solar

Cortinas enrollables: en tela / solares

Stores à enroulement automatique – Tissu/solaire

INSTALLATION • OPERATION • CARE

INSTALACIÓN • MANEJO • CUIDADO

INSTALLATION • UTILISATION • ENTRETIEN

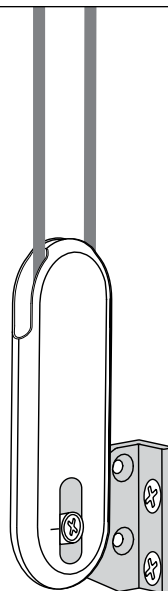

Continuous Cord Loop Lift Control – Standard Valance

Control de elevación del circuito de
cordón continuo: cenefa estándar

Commande de levage avec cordon à
boucle continue – Cantonnière standard



Young children can **STRANGLE** in cord loops. They can also wrap cords around their neck and **STRANGLE**.

- Always keep cords out of the reach of children.
- Move cribs, playpens and other furniture away from cords. Children can climb furniture to get to cords.

Cord Loop Tension Device

- Attach the tension device on the cord loop to the wall or window casement. See “Install the Tension Device” on page 11. This can prevent children from pulling cord loops around their necks.
- For the shade to operate properly, the cord tensioner must be correctly mounted and secured.
- Fasteners provided in this kit may not be appropriate for all mounting surfaces. Use appropriate anchors for mounting surface conditions.
- Only supplied tension device and hardware should be used. Replacement parts may be obtained by contacting Customer Service at 1-800-538-6567.

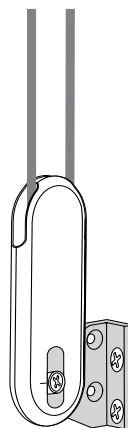
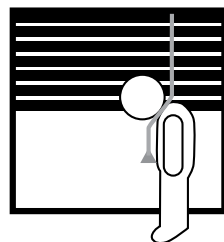

Canadian Residents Only: For more safety information: 1-866-662-0666 or visit www.canada.ca, search "blind cords".



WARNING: Keep all small parts, components and packaging away from children as they pose a potential choking hazard which may result in serious injury or death. Please reference all warning tags and labels in the instructions and on the shade.

Window and Shade Terminology

Mounting Types and Window Terminology	4
---	---

Getting Started

Components Included	5
Tools and Fasteners You May Need	6

Installation

Inside Mount	7–8
Outside Mount	9–10

Installation-Additional Components

Continuous Cord Loop Tension Device	11
Hold-Down Brackets (Optional)	12

Operation

Operating the Shade	12
---------------------------	----

Uninstalling

Removing the Shade	13
--------------------------	----

Cleaning and Care.....14**Additional Information and Support**

Troubleshooting.....	15
Warranty	15
Customer Service Support.....	15

WINDOW AND SHADE TERMINOLOGY

Thank you for purchasing LEVOLOR® Roller Shades. With proper installation, operation, and care, your new roller shade will provide years of beauty and performance. Please thoroughly review this instruction booklet before beginning installation.

MOUNTING TYPES AND WINDOW TERMINOLOGY

If the installation brackets are mounted correctly, the rest of the installation process follows easily. To prepare for this important first step, review the mounting types and basic window terminology illustrated below.

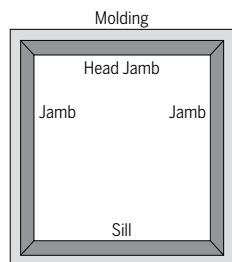

Window Components Terminology

- Collectively, the sill and jambs are called the "window casement" or "frame".

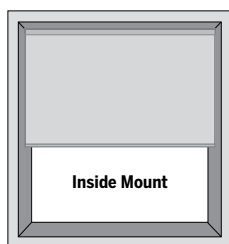

Inside Mount

- Shade fits within window opening.
- Great for windows with beautiful trim.

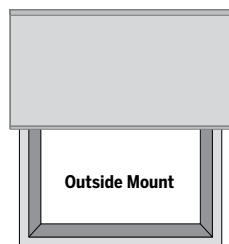

Outside Mount

- Shade mounts outside window opening.
- Increased light control and privacy.

INSTALLATION OVERVIEW

- **Leaving the shade rolled up completely will ease installation.**
- Confirm that the headrail and shade are the proper width and length.
- If installing several sets of shades, be sure to match them with the appropriate window.
- Check the installation surface to ensure that you have suitable fasteners and tools.
- Lay out and organize all parts and components.
- Proper shade direction during installation:
 - For Traditional Roller Shades, fabric will hang off the back of the shade, closest to the window.
 - For Optional Reverse Roller Shades, fabric will hang off the front of the shade.

COMPONENTS INCLUDED IN THE BOX

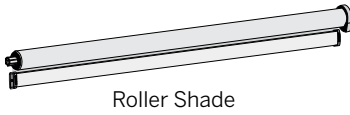

Roller Shade



Valance

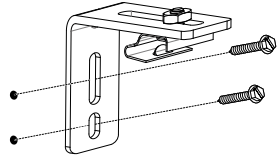

Mounting
Brackets-Valance
(outside mount only)

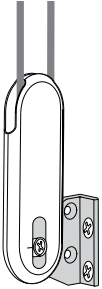

Cord Loop
Tension Device

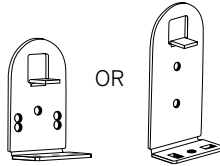

Mounting Brackets
(Bracket determined
by shade size)



Hex Head Screws
(2 per Bracket)

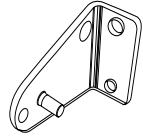

Hold-Down Brackets
(optional)

- Shade
- Mounting Brackets, shade and valance
- Installation Hardware

Optional items will be included, if selected at time of shade order.

GETTING STARTED

TOOLS AND FASTENERS YOU MAY NEED (not included)

The tools you will need for installing your shade will vary, depending on the installation surface and mounting bracket type.

Tools typically used for installation include:

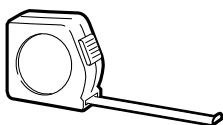

Metal Tape Measure

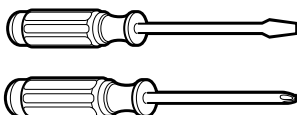

Screwdrivers
(both flat and Phillips head)



1/4" and 3/8" Nutdrivers



Safety Glasses

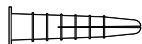

Drywall Anchors



Pencil

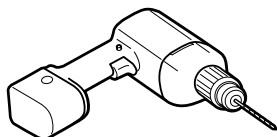

Drill with Bits



Level

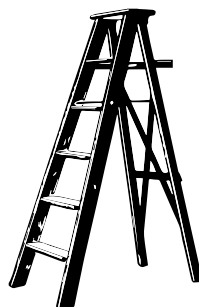

Ladder



CAUTION: Use drywall anchors when mounting into drywall. (Not provided.) Failure to properly anchor shade could cause shade to fall possibly resulting in injury.

INSIDE MOUNT (IM)

STEP 1: MARKING THE BRACKET LOCATIONS

IMPORTANT: Before marking bracket locations, ensure that your bracket placement will not interfere with any components inside the headrail.

- Verify that your window casing has a minimum depth of 1 ½" which allows for a partially recessed headrail mount.
- If flush mount (fully recessed mount) is desired, a minimum mounting depth of 3 ¼" is required.
- Place brackets on inside surface of valance, flush with the edge at either end.
- Mark screw locations for each end bracket onto the valance, 2 holes per bracket.

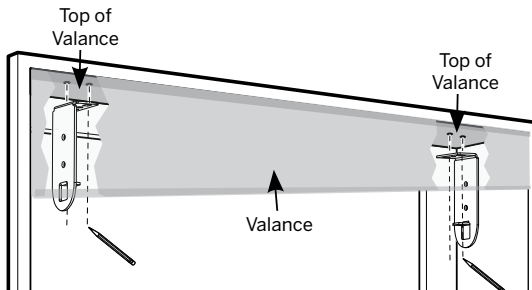

STEP 2: INSTALLING THE BRACKETS

- Put the valance in the window frame and using the marks, pre-drill screw holes through the valance into the frame.
 - If installing brackets into wood, use supplied screws.
 - If installing into drywall, use anchors in combination with supplied screws.
- Screw in brackets through valance into the window frame at marked locations, 2 screws per bracket.
- Ensure all brackets are square with each other.

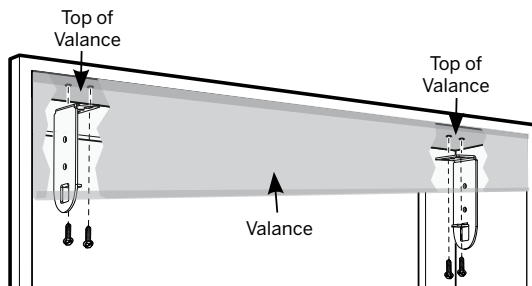

INSTALLATION

INSIDE MOUNT (IM)

STEP 3: INSTALLING THE SHADE

- Place side of shade with the bead chain into end bracket first.
- On the other side of shade, compress the spring loaded end plug and secure into opposite bracket.
 - Shade is secure when spring clicks into bracket.

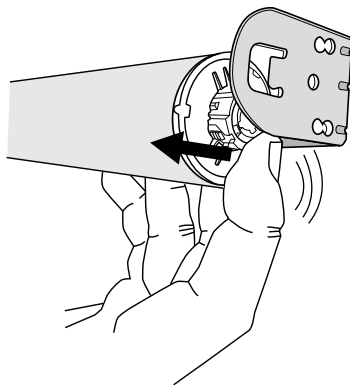
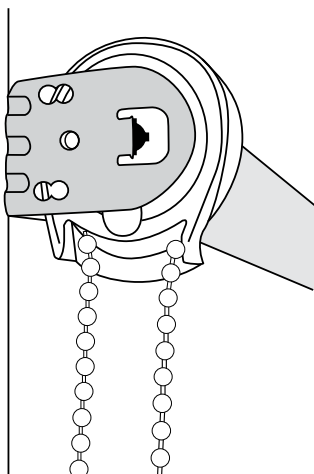

CAUTION: Be sure the brackets are properly engaged before operating the shade. Failure to do so may result in the shade falling and possible injury.

OUTSIDE MOUNT (OM)

STEP 1: MARKING THE BRACKET LOCATIONS

IMPORTANT: The brackets must be flush against a flat mounting surface. Do NOT mount brackets on curved molding.

- Center the headrail over the window opening at the desired height.
- Mark screw locations for each end bracket, 2 holes per bracket.
 - Use a level to ensure all brackets are aligned.

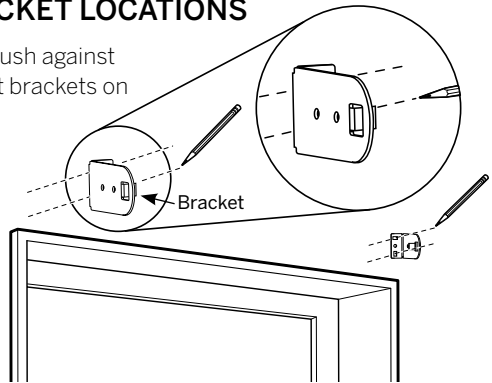

STEP 2: INSTALLING THE SHADE BRACKETS

- Pre-drill screw holes using a $\frac{1}{16}$ " drill bit, using pencil marks as a guide.
 - If installing brackets into wood, use supplied screws.
 - If installing into drywall or other, use anchors in combination with supplied screws.
- Screw in brackets at marked locations, 2 screws per bracket.
- Ensure all brackets are square with each other.

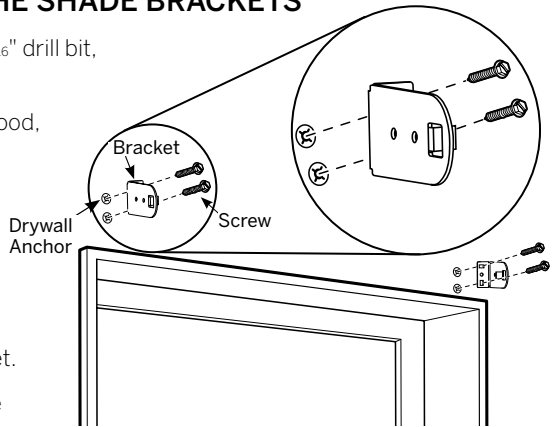

INSTALLATION

OUTSIDE MOUNT (OM)

STEP 3: INSTALLING VALANCE BRACKETS

- Place valance mounting brackets approximately 3" in from either end bracket for the shade.

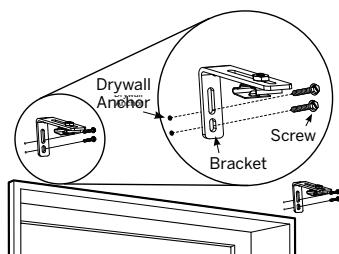
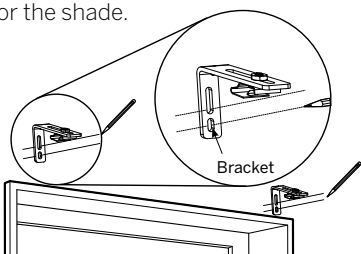

- Mark screw locations for a level valance.
- Screw valance brackets into the wall.

STEP 4: ASSEMBLING VALANCE

- On both ends, attach valance returns.
 - Slide the corner clip onto a return panel.
 - Slide assembled return panel onto the ends of the valance.
- On both ends, attach fabric.
 - Ensuring fabric extends equally over the ends, wrap the fabric around the end of the return panel.
 - Pull tight to remove wrinkles.
 - Remove masking tape and apply to fabric on back of valance.
 - Press the caps into place.

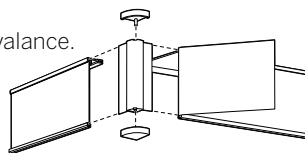

STEP 5: INSTALLING THE SHADE AND VALANCE

- Place side of shade with the bead chain into end bracket first.
- On the other side of shade, press in the spring loaded end plug and secure into opposite bracket.
 - Shade is secure when spring clicks into bracket.
- Align the valance so the top of the valance can slide into valance bracket.

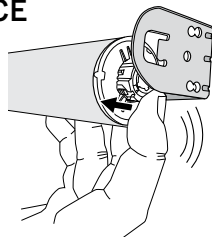
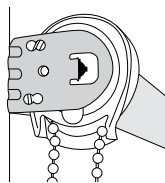

Valance spacing from the wall can be adjusted by loosening hex nut, adjusting, and retightening accordingly.

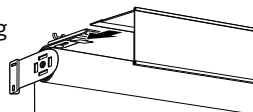

CAUTION: Be sure the bracket and headrail are properly secured before operating the shade. Failure to do so may result in the shade falling and possible injury.

CONTINUOUS CORD LOOP CORD TENSION DEVICE

- Continuous Cord Loop Shades will arrive with the tension device mounted to the shade.
- Use the included screws to secure the hold-down tension device to the mounting surface, ensuring that the cord loop is taut.
- **SEE WARNING LABEL ON SHADE**

Install the Tension Device

IMPORTANT: Before you proceed, you must first slide the cord tensioner to the bottom of the cord loop.

- Insert a small screwdriver, punch, or awl through the screw hole at the bottom of the cord tensioner.
- Move the screw hole down to the indicator line to release the safety mechanism.
- Slide the cord tensioner down to the bottom of the cord loop.
- Attach the cord tensioner according to the instructions provided with the Universal Cord Tensioner Installation Kit.

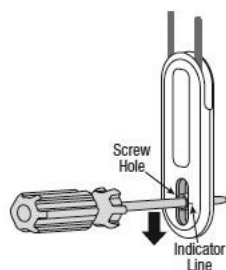

WARNING: It is imperative that the cord tensioner be properly secured to the wall or window frame to reduce children's access to the cord loop. Young children can strangle in cord loops. They can also wrap cords around their necks and strangle.



CAUTION: The shading will not operate properly unless the cord tensioner is secured. A universal Cord Tensioner Installation Kit has been included with your shading. Follow the instructions in the kit to correctly secure the cord tensioner.

INSTALLATION—ADDITIONAL COMPONENTS

HOLD-DOWN BRACKETS (optional)

- Ideal for doors, hold-down brackets prevent shade from swaying. Assemble as shown to each side of bottom rail.
- Position hold-down brackets against wall/frame, mark screw hole locations.
- Screw into marked hole locations.

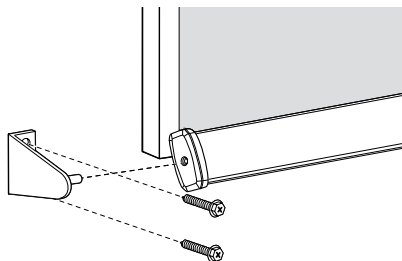

OPERATION

CONTINUOUS CORD LOOP

- Pull the rear cord of the cord loop to lower the shade to the desired height.
- Pull the front cord of the cord loop to raise the shade to the desired height.



WARNING: If the tension device moves up the cord, you have not secured the tension device to the wall or window frame. You must do so for the shade to operate properly and to help protect young children from accidental strangulation.

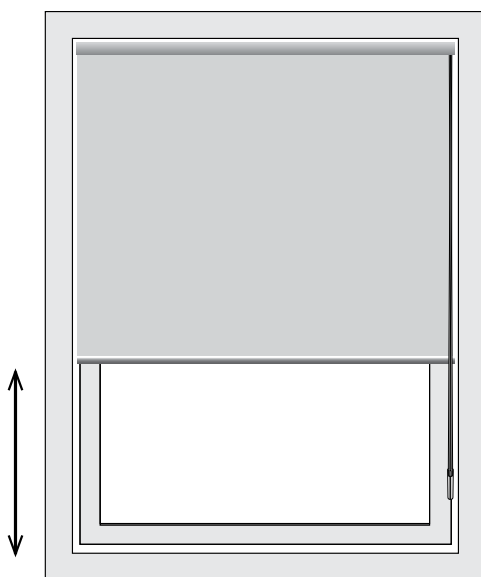

REMOVING THE SHADE

- Fully raise the shade.
- Locate clear, plastic locking ring on spring-loaded end plug.
 - Note—This is the side without the cord loop chain.
 - 1—Rotate ring until to unlock.
 - 2—Press shade toward the mounting bracket.
 - 3—Carefully lower shade from mounting brackets.
- Uninstall remaining brackets if necessary.

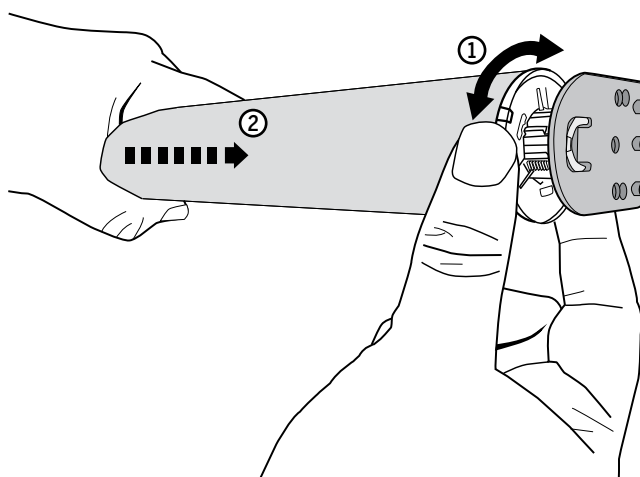

CAUTION: Hold shade firmly when removing. Failure to do so may result in the shade falling and possible injury.

CLEANING AND CARE

CLEANING PROCEDURES

All LEVOLOR Roller Shades have multiple cleaning options.

NOTICE: Avoid contact with window cleaning products. Improper cleaning may void warranty.



DUSTING

Use a feather duster for regular cleaning.



FORCED AIR

Blow away dirt and debris using clean compressed air.



PROFESSIONAL INJECTION/EXTRACTION CLEANING

Call local on-site blind/shade cleaner that injects a cleaning solution into the fabric and extracts the dirty solution at the same time. The service is typically performed at home so you do not need to remove your window treatments.



VACUUMING

Use a low suction vacuum with a brush-type cleaner attachment; stroke lightly over the shade to clean.



SPOT-CLEANING/STAIN REMOVAL AT HOME

Use warm water and a mild soap, like Woolite® or Scotchgard®, if needed. Do not immerse shade in water.

TROUBLESHOOTING TIPS

- Do not lower the shade past the ordered length. (If it is lowered beyond the limit, the tube underneath the roller will be exposed and fabric damage could occur.)

WARRANTY

For complete warranty information visit LEVOLOR.com or call Customer Service at 1-800-LEVOLOR or 1-800-538-6567.

CONTACTING US

To contact LEVOLOR Customer Service regarding any questions or concerns you may have about your new shades, you may reach us at: 1-800-LEVOLOR (8:30 am – 6:30 pm EST)

www.LEVOLOR.com

ADDITIONAL PARTS AND SERVICES

Additional or replacement parts can be ordered, or shades can be repaired or restrung through our repair center. Please contact LEVOLOR customer service through www.LEVOLOR.com for a return authorization number.

LEVOLOR®

Roller Shades—Fabric/Solar/Banded

Cortinas enrollables: en tela / solares / en franjas

Stores à enroulement automatique – Tissu/solaire/rubané

INSTALLATION • OPERATION • CARE

INSTALACIÓN • MANEJO • CUIDADO

INSTALLATION • UTILISATION • ENTRETIEN

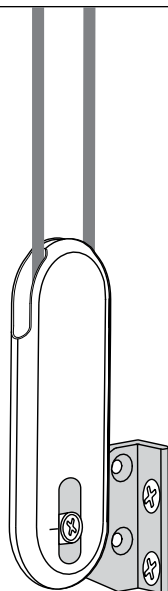
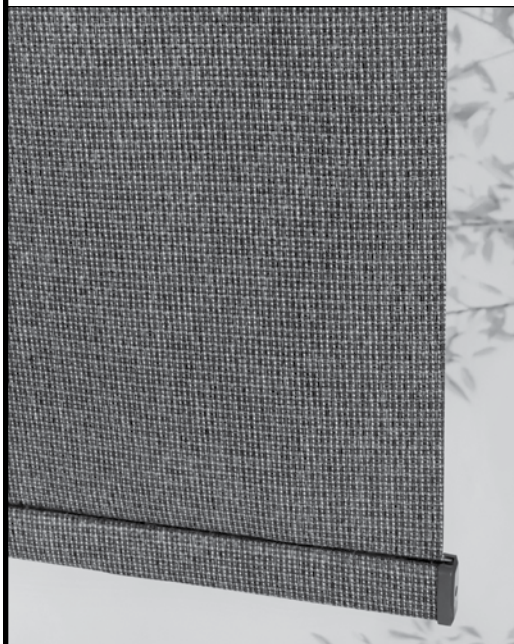

Continuous Cord Loop

Lift Control—Cassette Valance

Control de elevación del circuito de
cordón continuo: cenefa de cassette

Commande de levage avec cordon à
boucle continue – Cantonnière à cassette



Young children can **STRANGLE** in cord loops. They can also wrap cords around their neck and **STRANGLE**.

- Always keep cords out of the reach of children.
- Move cribs, playpens and other furniture away from cords. Children can climb furniture to get to cords.

Cord Loop Tension Device

- Attach the tension device on the cord loop to the wall or window casement. See “Install the Tension Device” on page 11. This can prevent children from pulling cord loops around their necks.
- For the shade to operate properly, the cord tensioner must be correctly mounted and secured.
- Fasteners provided in this kit may not be appropriate for all mounting surfaces. Use appropriate anchors for mounting surface conditions.
- Only supplied tension device and hardware should be used. Replacement parts may be obtained by contacting Customer Service at 1-800-538-6567.

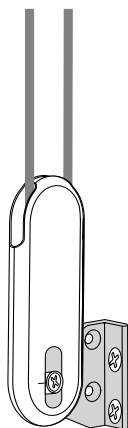
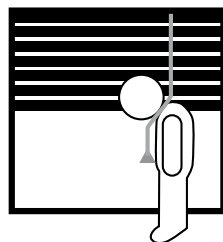

Canadian Residents Only: For more safety information: 1-866-662-0666 or visit www.canada.ca, search "blind cords".



WARNING: Keep all small parts, components and packaging away from children as they pose a potential choking hazard which may result in serious injury or death. Please reference all warning tags and labels in the instructions and on the shade.

Window and Shade Terminology

Mounting Types and Window Terminology	4–5
---	-----

Getting Started

Components Included	6
---------------------------	---

Tools and Fasteners You May Need	7
--	---

Installation

Inside Mount	8–9
--------------------	-----

Outside Mount	10
---------------------	----

Installation—Additional Components

Cord Tension Device	11
---------------------------	----

Hold-Down Brackets (Optional)	12
-------------------------------------	----

Operation

Operating the Shade	12
---------------------------	----

Uninstall

Removing the Shade	13
--------------------------	----

Cleaning and Care	14
--------------------------------	----

Additional Information and Support

Troubleshooting	15
-----------------------	----

Warranty	15
----------------	----

Customer Service Support	15
--------------------------------	----

WINDOW AND SHADE TERMINOLOGY

Thank you for purchasing LEVOLOR® Roller Shades. With proper installation, operation, and care, your new roller shade will provide years of beauty and performance. Please thoroughly review this instruction booklet before beginning installation.

MOUNTING TYPES AND WINDOW TERMINOLOGY

If the installation brackets are mounted correctly, the rest of the installation process follows easily. To prepare for this important first step, review the mounting types and basic window terminology illustrated below.

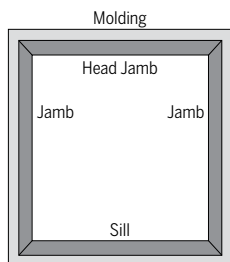

Window Components Terminology

- Collectively, the sill and jambs are called the "window casement" or "frame".

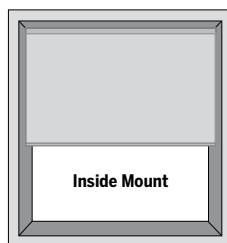

Inside Mount

- Shade fits within window opening.
- Great for windows with beautiful trim.

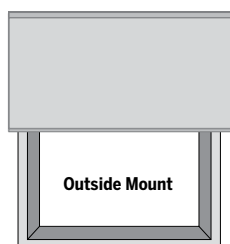

Outside Mount

- Shade mounts outside window opening.
- Increased light control and privacy.

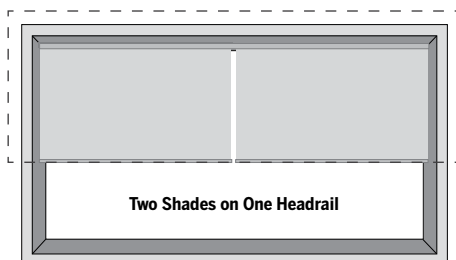

Two Shades on One Headrail

- Provides the clean appearance of a single shade with the ability to operate each shade independently.
- Can be mounted inside or outside.

INSTALLATION OVERVIEW

- **Leaving the shade rolled up completely will ease installation.**
- Confirm that the headrail and shade are the proper width and length.
- If installing several sets of shades, be sure to match them with the appropriate window.
- Check the installation surface to ensure that you have suitable fasteners and tools.
- Lay out and organize all parts and components.

Installation Brackets	
Your order will include the correct number of installation brackets for your shade width, as shown in the table below	
Shade Width (inches)	Number of Brackets per Shade
Up to 36	2
36 to 54	3
54 to 72	4
72 to 108	5
108 to 144	6
2-on-1 Headrail Shades	2 additional brackets provided

GETTING STARTED

COMPONENTS INCLUDED IN THE BOX



Roller Shade – Fabric/Solar



Roller Shade – Banded

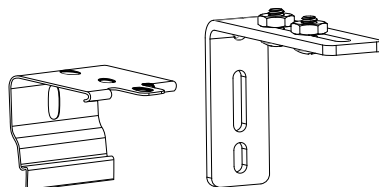

Mounting Brackets
(L bracket only required on outside mount)

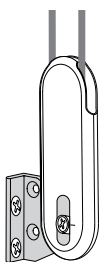

Cord Loop
Tension Device



Hex Head Screws
(2 per Bracket)

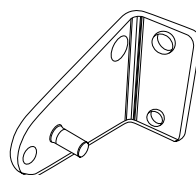

Hold Down Brackets
(optional)

- Shade
- Mounting Brackets
- Installation Hardware

Optional items will be included, if selected at time of shade order.

TOOLS AND FASTENERS YOU MAY NEED (not included)

The tools you will need for installing your shade will vary, depending on the installation surface and mounting bracket type.

Tools typically used for installation include:

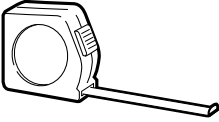

Metal Tape Measure

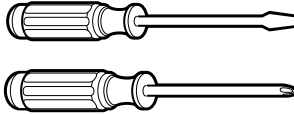

Screwdrivers
(both flat and Phillips head)



1/4" and 3/8" Nutdriver



Safety Glasses

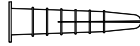

Drywall Anchors



Pencil

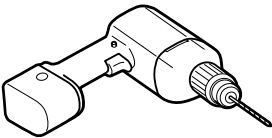

Drill with Bits



Level

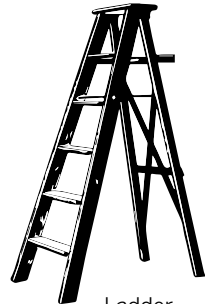

Ladder



CAUTION: Use drywall anchors when mounting into drywall. (Not provided.) Failure to properly anchor shade could cause shade to fall possibly resulting in injury.

INSTALLATION

INSIDE MOUNT (IM)

STEP 1: MARKING THE BRACKET LOCATIONS

IMPORTANT: Before marking bracket locations, ensure that your bracket placement will not interfere with any components inside the headrail.

- Verify that your window casing has a minimum depth of 1 ¼" which allows for a partially recessed headrail mount.
- If flush mount (fully recessed mount) is desired, a minimum mounting depth of 3" is required.
- Mark approximately 1" from each jamb for bracket location.
- Mark screw locations for each end bracket, 2 holes per bracket.
- If more than two installation brackets come with your order, space additional bracket(s) evenly between the two end brackets, no more than 30" apart.

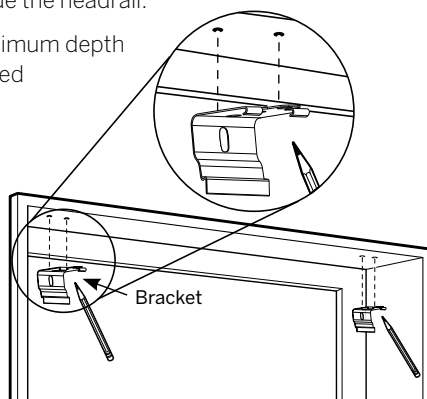

STEP 2: INSTALLING THE BRACKETS

- Pre-drill screw holes.
 - If installing brackets into wood, use supplied screws.
 - If installing into drywall, use anchors in combination with supplied screws.
- Screw in brackets at marked locations, 2 screws per bracket.
- Ensure all brackets are square with each other.

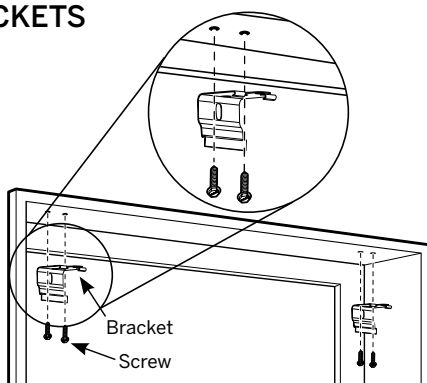

INSIDE MOUNT (IM)

STEP 3: INSTALLING THE SHADE

- Hook the top, middle rib of the cassette valance onto all of the bracket hooks.
- Rotate the back of the cassette valance firmly upwards and toward the window until the groove at the bracket snaps into place.

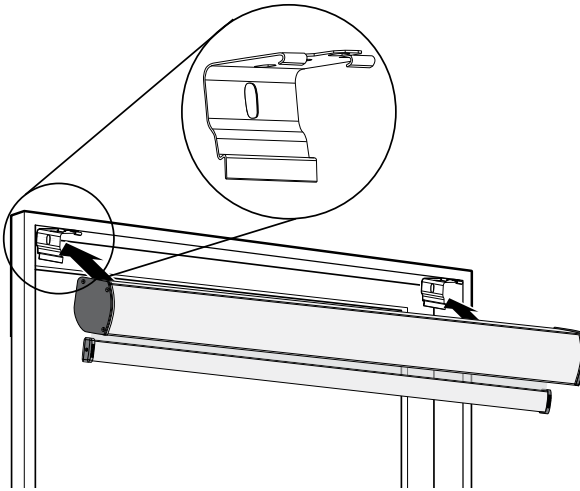

CAUTION: Be sure the brackets are properly engaged before operating the shade. Failure to do so may result in the shade falling and possible injury.

INSTALLATION

OUTSIDE MOUNT (OM)

STEP 1: MARKING THE BRACKET LOCATIONS

IMPORTANT: The brackets must be flush against a flat mounting surface. Do NOT mount brackets on curved molding.

- Center the headrail over the window opening at the desired height.
- Mark screw locations for each L bracket approximately 3" from end of cassette, 2 holes per bracket.
 - Use a level to ensure all brackets will be in alignment.
- If more than two installation brackets come with your order, space additional bracket(s) evenly between the two end brackets, no more than 30" apart.

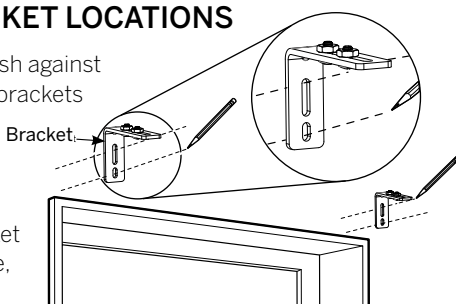

STEP 2: INSTALLING THE BRACKETS

- Pre-drill screw holes using a $\frac{1}{16}$ " drill bit, using pencil marks as a guide.
 - If installing brackets into wood, use supplied screws.
 - If installing into drywall, use anchors in combination with supplied screws.
- Screw in L brackets at marked locations, 2 screws per bracket.
- Ensure all brackets are square with each other.
- Attach cassette mounting bracket to L bracket using screws and hex nuts.
 - Make sure the release tab is always mounted on the bottom.

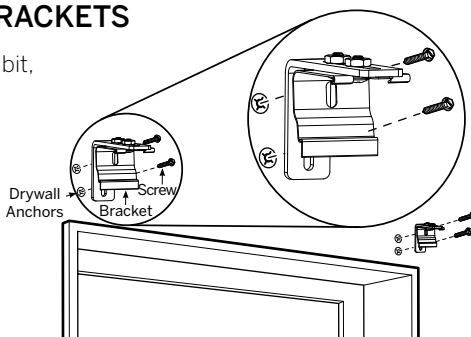

STEP 3: INSTALLING THE SHADE

- Hook the top, middle rib of the cassette valance onto all of the bracket hooks.
- Rotate the back of the cassette valance firmly upwards and toward the window until the groove at the bracket snaps into place.

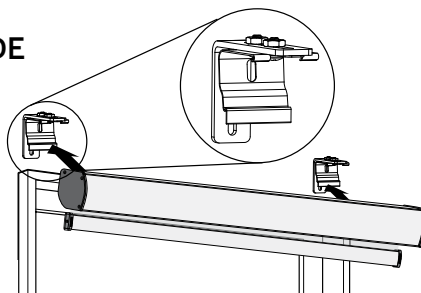

CAUTION: Be sure the bracket and headrail are properly secured before operating the shade. Failure to do so may result in the shade falling and possible injury.

CONTINUOUS CORD LOOP CORD TENSION DEVICE

- Continuous Cord Loop Shades will arrive with the tension device mounted to the shade.
- Use the included screws to secure the hold-down tension device to the mounting surface, ensuring that the cord loop is taut.
- **SEE WARNING LABEL ON SHADE**

INSTALL THE TENSION DEVICE

IMPORTANT: Before you proceed, you must first slide the cord tensioner to the bottom of the cord loop.

- Insert a small screwdriver, punch, or awl through the screw hole at the bottom of the cord tensioner.
- Move the screw hole down to the indicator line to release the safety mechanism.
- Slide the cord tensioner down to the bottom of the cord loop.
- Attach the cord tensioner according to the instructions provided with the Universal Cord Tensioner Installation Kit.

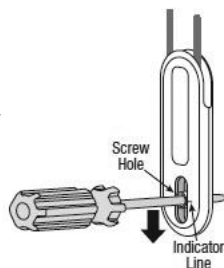

WARNING: It is imperative that the cord tensioner be properly secured to the wall or window frame to reduce children's access to the cord loop. Young children can strangle in cord loops. They can also wrap cords around their necks and strangle.



CAUTION: The shading will not operate properly unless the cord tensioner is secured. A universal Cord Tensioner Installation Kit has been included with your shading. Follow the instructions in the kit to correctly secure the cord tensioner.

INSTALLATION—ADDITIONAL COMPONENTS

HOLD-DOWN BRACKETS (optional)

- Ideal for doors, hold-down brackets prevent shade from swaying. Assemble as shown to each side of bottom rail.
- Position hold-down brackets against wall / frame, mark screw hole locations.
- Screw into marked hole locations.

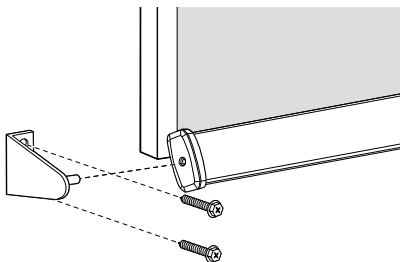

OPERATION

CONTINUOUS CORD LOOP

- Pull the rear cord of the cord loop to lower the shade to the desired height.
- Pull the front cord of the cord loop to raise the shade to the desired height.



WARNING: If the tension device moves up the cord, you have not secured the tension device to the wall or window frame. You must do so for the shade to operate properly and to help protect young children from accidental strangulation.

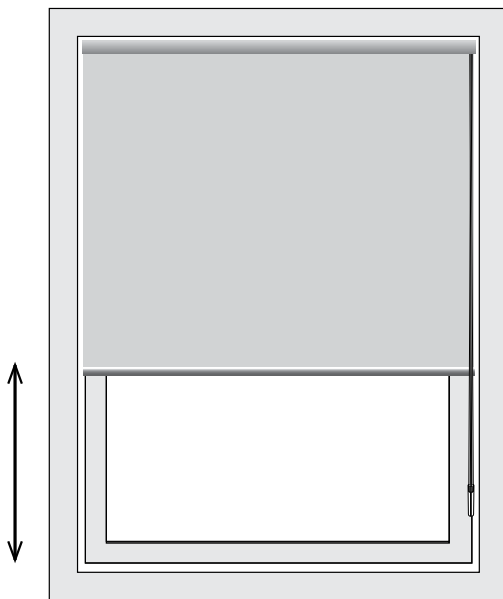

REMOVING THE SHADE

- Fully raise the shade.
- While holding the headrail, use a flathead screwdriver to engage the release tab on the bottom of all of the installation brackets.
- Rotate the bottom of the shade away from the window, fully releasing it from the brackets.
- Uninstall remaining brackets if necessary.

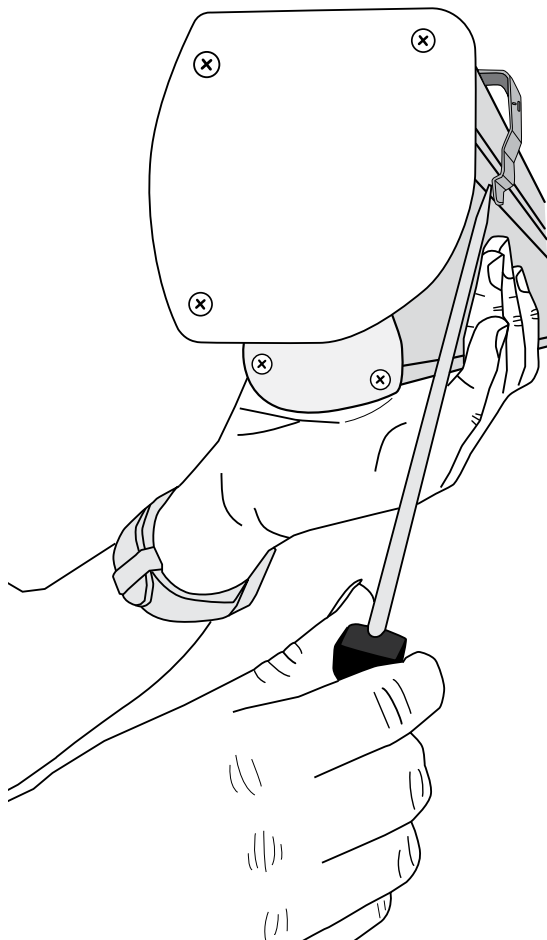

CAUTION: Hold shade firmly when removing. Failure to do so may result in the shade falling and possible injury.

CLEANING AND CARE

CLEANING PROCEDURES

All LEVOLOR Roller Shades have multiple cleaning options.

NOTICE: Avoid contact with window cleaning products. Improper cleaning may void warranty.



DUSTING

Use a feather duster for regular cleaning.



FORCED AIR

Blow away dirt and debris using clean compressed air.



PROFESSIONAL INJECTION/EXTRACTION CLEANING

Call local on-site blind/shade cleaner that injects a cleaning solution into the fabric and extracts the dirty solution at the same time. The service is typically performed at home so you do not need to remove your window treatments.



VACUUMING

Use a low suction vacuum with a brush-type cleaner attachment; stroke lightly over the shade to clean.



SPOT-CLEANING/STAIN REMOVAL AT HOME

Use warm water and a mild soap, like Woolite® or Scotchgard®, if needed. Do not immerse shade in water.

TROUBLESHOOTING TIPS

- Do not lower the shade past the ordered length. (If it is lowered beyond the limit, the tube underneath the roller will be exposed and fabric damage could occur.)

WARRANTY

For complete warranty information visit LEVOLOR.com or call Customer Service at 1-800-LEVOLOR or 1-800-538-6567.

CONTACTING US

To contact LEVOLOR Customer Service regarding any questions or concerns you may have about your new shades, you may reach us at: 1-800-LEVOLOR (8:30 am – 6:30 pm EST)

www.LEVOLOR.com

ADDITIONAL PARTS AND SERVICES

Additional or replacement parts can be ordered, or shades can be repaired or restrung through our repair center. Please contact LEVOLOR customer service through www.LEVOLOR.com for a return authorization number.

LEVOLOR®

Roller Shades—Fabric/Solar Cortinas enrollables: en tela / solares Stores à enroulement automatique – Tissu/solaire

INSTALLATION • OPERATION • CARE
INSTALACIÓN • MANEJO • CUIDADO
INSTALLATION • UTILISATION • ENTRETIEN

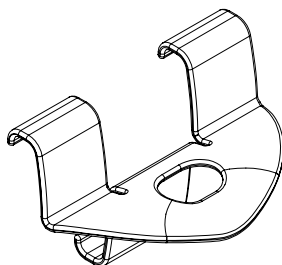
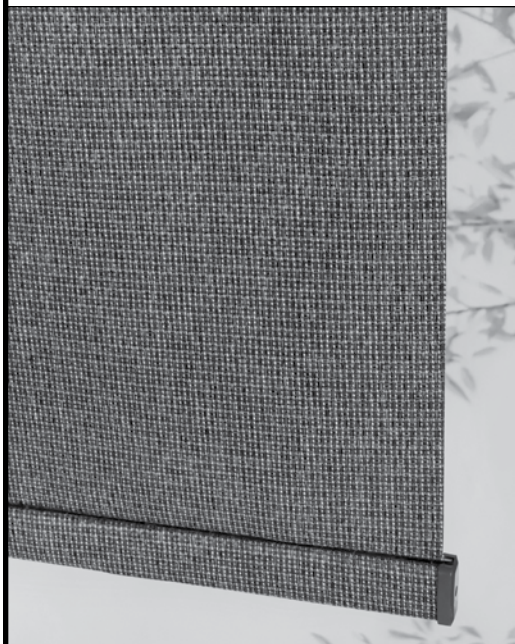

Cordless Lift Control—Open Roll

Control de elevación sin cordón: rodillo abierto
Commande de levage sans cordon – Rouleau ouvert

CONTENTS

Window and Shade Terminology

Mounting Types and Window Terminology	3-4
---	-----

Getting Started

Components Included	5
Tools and Fasteners You May Need	6

Installation

Inside Mount	7-8
Outside Mount	9-10

Installation—Additional Components

Cordless Operating Handle(s)	11
Hold-Down Brackets (Optional)	11

Operation

Operating the Shade	12
---------------------------	----

Uninstall

Removing the Shade	13
--------------------------	----

Cleaning and Care..... 14

Additional Information and Support

Troubleshooting	15
Warranty	15
Customer Service Support	15

WINDOW AND SHADE TERMINOLOGY

Thank you for purchasing LEVOLOR® Roller Shades. With proper installation, operation, and care, your new roller shade will provide years of beauty and performance. Please thoroughly review this instruction booklet before beginning installation.

MOUNTING TYPES AND WINDOW TERMINOLOGY

If the installation brackets are mounted correctly, the rest of the installation process follows easily. To prepare for this important first step, review the mounting types and basic window terminology illustrated below.

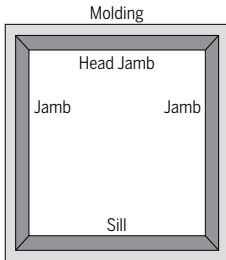

Window Components Terminology

- Collectively, the sill and jambs are called the "window casement" or "frame".

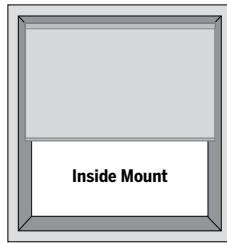

Inside Mount

- Shade fits within window opening.
- Great for windows with beautiful trim.

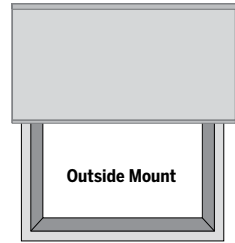

Outside Mount

- Shade mounts outside window opening.
- Increased light control and privacy.

WINDOW AND SHADE TERMINOLOGY

INSTALLATION OVERVIEW

- **Leaving the shade rolled up completely will ease installation.**
- Confirm that the headrail and shade are the proper width and length.
- If installing several sets of shades, be sure to match them with the appropriate window.
- Check the installation surface to ensure that you have suitable fasteners and tools.
- Lay out and organize all parts and components.
- Proper shade direction during installation:
 - For Traditional Roller Shades, fabric will hang off the back of the shade, closest to the window.
 - For Optional Reverse Roller Shades, fabric will hang off the front of the shade.

Installation Brackets	
Your order will include the correct number of installation brackets for your shade width, as shown in the table below	
Shade Width (inches)	Number of Brackets per Shade
Up to 36	2
36 to 54	3
54 to 72	4
72 to 108	5
108 to 144	6
2-on-1 Headrail Shades	2 additional brackets provided

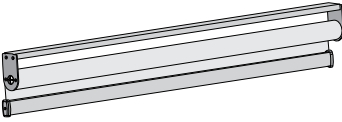
COMPONENTS INCLUDED IN THE BOX

Roller Shade

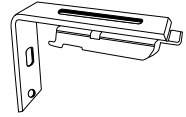
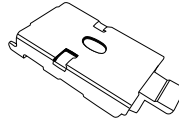

Mounting Brackets
(L bracket only required
on outside mount)



Hex Head Screws

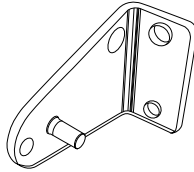

Hold Down Brackets
(optional)

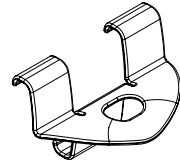

Cordless Handle
(optional)

- Shade
- Mounting Brackets
- Installation Hardware

Optional items will be included, if selected at time of shade order.

GETTING STARTED

TOOLS AND FASTENERS YOU MAY NEED (not included)

The tools you will need for installing your shade will vary, depending on the installation surface and mounting bracket type.

Tools typically used for installation include:

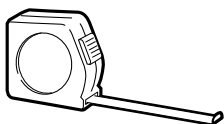

Metal Tape Measure

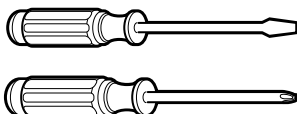

Screwdrivers
(both flat and Phillips head)



1/4" Nutdriver



Safety Glasses

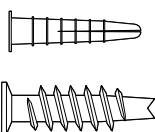

Drywall Anchors



Pencil

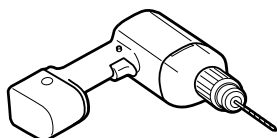

Drill with Bits



Level

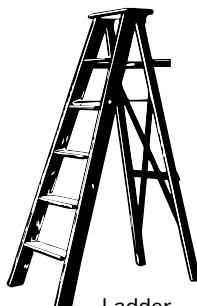

Ladder



CAUTION: Use drywall anchors when mounting into drywall. (Not provided.) Failure to properly anchor shade could cause shade to fall possibly resulting in injury.

INSIDE MOUNT (IM)

STEP 1: MARKING THE BRACKET LOCATIONS

IMPORTANT: Before marking bracket locations, ensure that your bracket placement will not interfere with any components inside the headrail.

- Verify that your window casing has a minimum depth of 1 ½" which allows for a partially recessed headrail mount.
- If flush mount (fully recessed mount) is desired, a minimum mounting depth of 2 ½" is required.
- Place brackets at either end of inside mount frame.
- Mark screw location for each end bracket.
- If more than two installation brackets come with your order, space additional bracket(s) evenly between the two end brackets, no more than 30" apart.

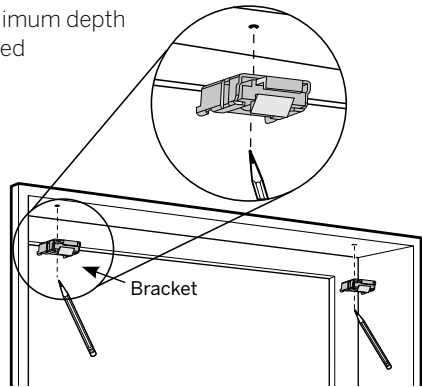

STEP 2: INSTALLING THE BRACKETS

- Pre-drill screw holes.
 - If installing brackets into wood, used supplied screws.
 - If installing into drywall, use anchors in combination with supplied screws.
- Screw in brackets at marked locations.
- Ensure all brackets are square with each other.

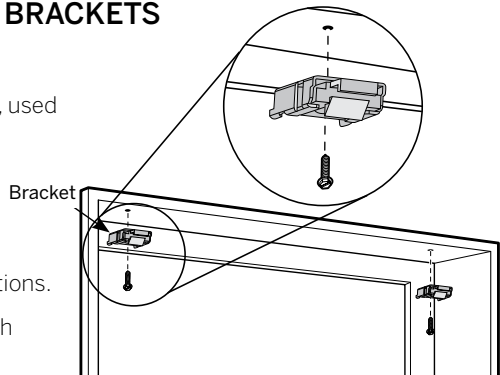

INSTALLATION

INSIDE MOUNT (IM)

STEP 3: INSTALLING THE SHADE

- Attach open edge of the headrail into metal grooves.
- Rotate shade away from window, into brackets.
 - Bracket should snap securely into headrail grooves.

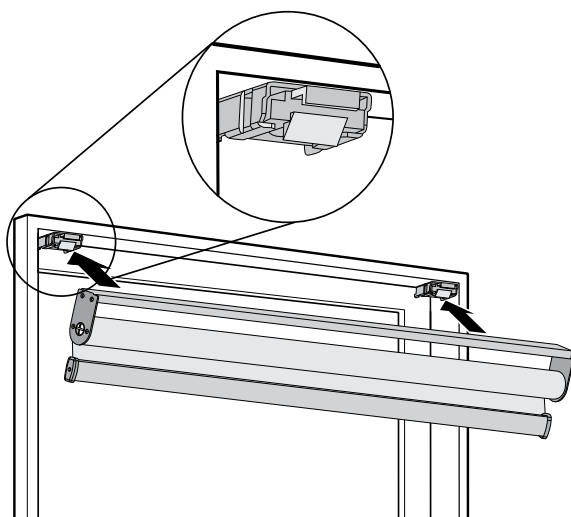

CAUTION: Be sure the brackets are properly engaged before operating the shade. Failure to do so may result in the shade falling and possible injury.

OUTSIDE MOUNT (OM)

STEP 1: MARKING THE BRACKET LOCATIONS

IMPORTANT: The brackets must be flush against a flat mounting surface. Do NOT mount brackets on curved molding.

- Center the shade over the window opening at the desired height.
- Mark screw location for each end bracket, 2 holes per bracket.
 - Use a level to ensure all brackets are aligned.

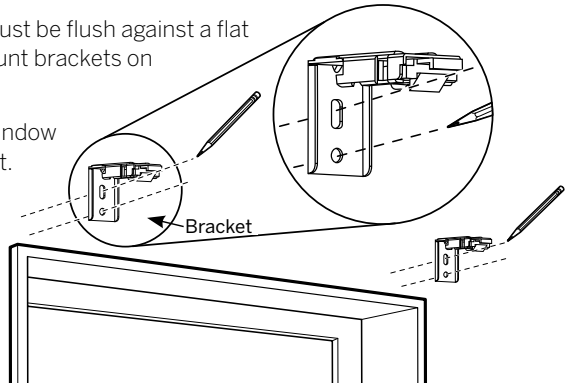

- If more than two installation brackets come with your order, space additional bracket(s) evenly between the two end brackets, no more than 30" apart.

STEP 2: INSTALLING THE SHADE BRACKETS

- Pre-drill screw holes using a $\frac{1}{16}$ " drill bit, using pencil marks as a guide.
 - If installing brackets into wood, use supplied screws.
 - If installing into drywall, use anchors in combination with supplied screws.
- Screw in brackets at marked locations, 2 screws per bracket.
- Ensure all brackets are square with each other.

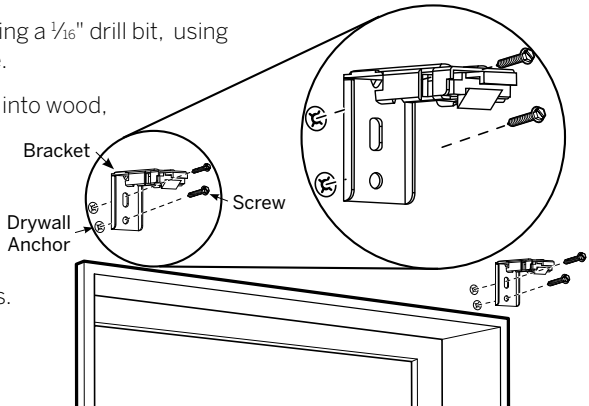

INSTALLATION

OUTSIDE MOUNT (OM)

STEP 3: INSTALLING THE SHADE

- Attach open edge of the headrail into metal grooves of installation bracket.
- Rotate shade away from window, into brackets.
 - Shade is secure when it snaps securely into headrail grooves.

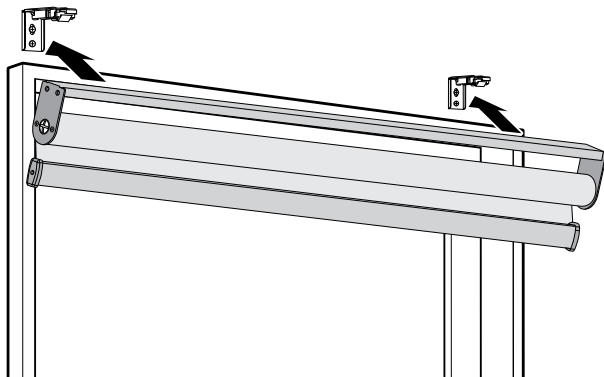

CAUTION: Be sure the bracket and headrail are properly secured before operating the shade. Failure to do so may result in the shade falling and possible injury.

INSTALL BOTTOM RAIL OPERATING HANDLE(S)

- Locate optional bottom rail handle that arrived with your shade.
- Insert front lip of the bottom rail handle into the top of the bottom rail of the shade. The handle will snap into place.
 - Optional bottom rail tassel will come attached to shade.

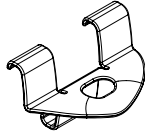

Roller Shade
Bottom Rail Clip



Roller Shade
Tassel

HOLD-DOWN BRACKETS (optional)

- Ideal for doors, hold-down brackets prevent shade from swaying. Assemble as shown to each side of bottom rail.
- Position hold down brackets against wall / frame, mark screw hole locations.
- Screw into marked hole locations.

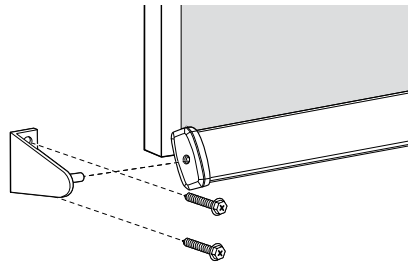

OPERATION

CORDLESS

- Pull the bottom rail of shade towards bottom of window frame to the desired height.
 - Optional bottom rail handles may be used.
- Gently pull bottom rail and release shade, and it will raise fully unless stopped at a new height.

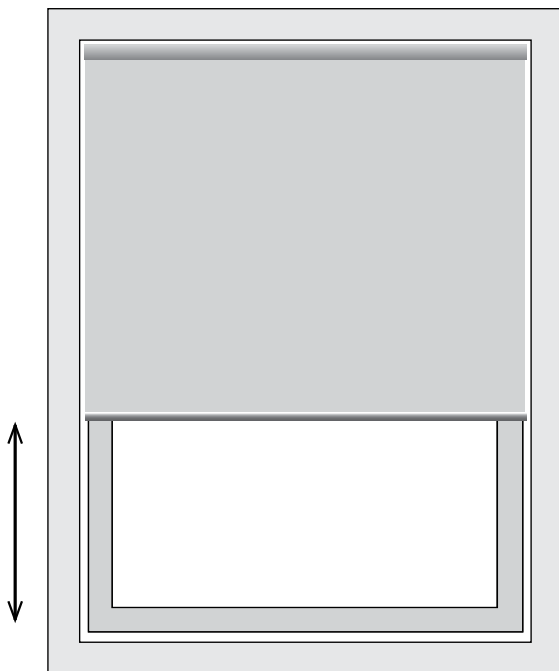

REMOVING THE SHADE

- Fully raise the shade.
- Press in the clear tab on the shade bracket.
- Release one edge of the headrail from the bracket.
- Rotate the shade to release the other edge of the headrail from the bracket.
- Uninstall remaining brackets if necessary.

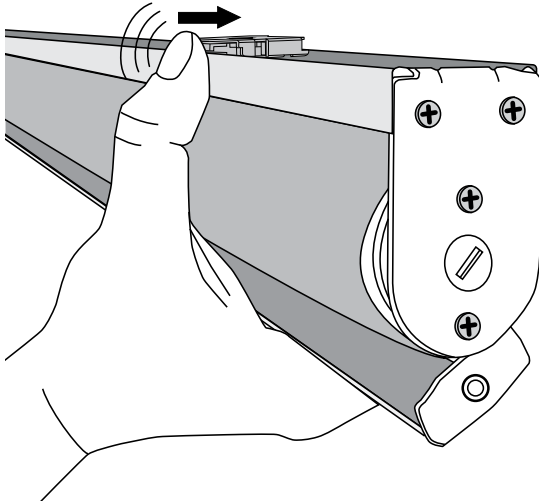

CAUTION: Hold shade firmly when removing. Failure to do so may result in the shade falling and possible injury.

CLEANING AND CARE

CLEANING PROCEDURES

All LEVOLOR Roller Shades have multiple cleaning options.

NOTICE: Avoid contact with window cleaning products. Improper cleaning may void warranty.



DUSTING

Use a feather duster for regular cleaning.



FORCED AIR

Blow away dirt and debris using clean compressed air.



PROFESSIONAL INJECTION/EXTRACTION CLEANING

Call local on-site blind/shade cleaner that injects a cleaning solution into the fabric and extracts the dirty solution at the same time. The service is typically performed at home so you do not need to remove your window treatments.



VACUUMING

Use a low suction vacuum with a brush-type cleaner attachment; stroke lightly over the shade to clean.



SPOT-CLEANING/STAIN REMOVAL AT HOME

Use warm water and a mild soap, like Woolite® or Scotchgard®, if needed. Do not immerse shade in water.

TROUBLESHOOTING TIPS

- Do not lower the shade past the ordered length. (If it is lowered beyond the limit, the tube underneath the roller will be exposed and fabric damage could occur.)

WARRANTY

For complete warranty information visit LEVOLOR.com or call Customer Service at 1-800-LEVOLOR or 1-800-538-6567.

CONTACTING US

To contact LEVOLOR Customer Service regarding any questions or concerns you may have about your new shades, you may reach us at: 1-800-LEVOLOR (8:30 am – 6:30 pm EST)

www.LEVOLOR.com

ADDITIONAL PARTS AND SERVICES

Additional or replacement parts can be ordered, or shades can be repaired or restrung through our repair center. Please contact LEVOLOR customer service through www.LEVOLOR.com for a return authorization number.

LEVOLOR®

Roller Shades–Fabric/Solar
Cortinas enrollables: en tela / solares
Stores à enroulement automatique – Tissu/solaire

INSTALLATION • OPERATION • CARE
INSTALACIÓN • MANEJO • CUIDADO
INSTALLATION • UTILISATION • ENTRETIEN

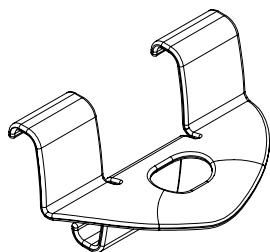
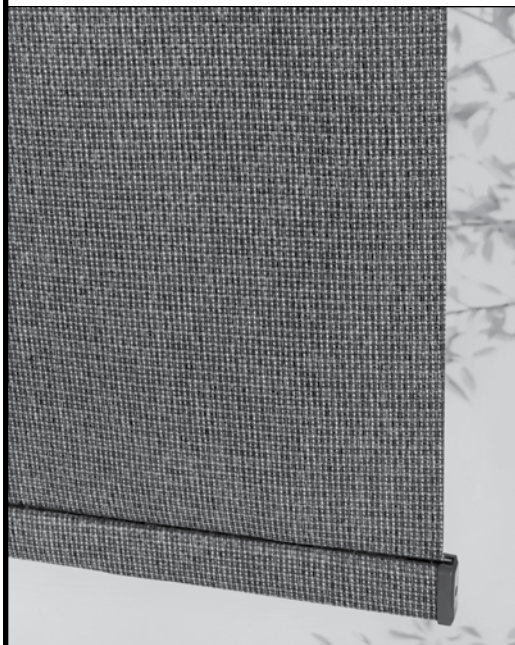

Cordless Lift Control–Standard Valance
Control de elevación sin cordón: cenefa estándar
Commande de levage sans cordon –
Cantonnière standard

CONTENTS

Window and Shade Terminology

Mounting Types and Window Terminology 3–4

Getting Started

Components Included 5

Tools and Fasteners You May Need 6

Installation

Inside Mount 7–8

Outside Mount 9–10

Installation–Additional Components

Hold-Down Brackets (Optional) 11

Operation

Operating the Shade 12

Uninstall

Removing the Shade 13

Cleaning and Care

..... 14

Additional Information and Support

Troubleshooting 15

Warranty 15

Customer Service Support 15

WINDOW AND SHADE TERMINOLOGY

Thank you for purchasing LEVOLOR® Roller Shades. With proper installation, operation, and care, your new roller shade will provide years of beauty and performance. Please thoroughly review this instruction booklet before beginning installation.

MOUNTING TYPES AND WINDOW TERMINOLOGY

If the installation brackets are mounted correctly, the rest of the installation process follows easily. To prepare for this important first step, review the mounting types and basic window terminology illustrated below.

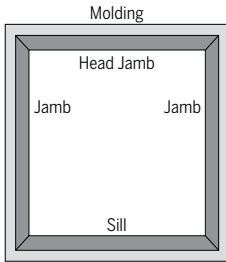

Window Components Terminology

- Collectively, the sill and jambs are called the "window casement" or "frame".

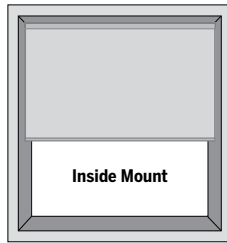

Inside Mount

- Shade fits within window opening.
- Great for windows with beautiful trim.

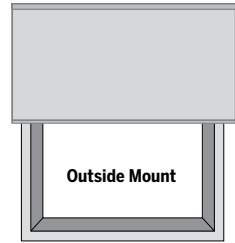

Outside Mount

- Shade mounts outside window opening.
- Increased light control and privacy.

WINDOW AND SHADE TERMINOLOGY

INSTALLATION OVERVIEW

- **Leaving the shade rolled up completely will ease installation.**
- Confirm that the headrail and shade are the proper width and length.
- If installing several sets of shades, be sure to match them with the appropriate window.
- Check the installation surface to ensure that you have suitable fasteners and tools.
- Lay out and organize all parts and components.
- Proper shade direction during installation:
 - For Traditional Roller Shades, fabric will hang off the back of the shade, closest to the window.
 - For Optional Reverse Roller Shades, fabric will hang off the front of the shade.

Installation Brackets	
Your order will include the correct number of installation brackets for your shade width, as shown in the table below	
Shade Width (inches)	Number of Brackets per Shade
Up to 36	2
36 to 54	3
54 to 72	4
72 to 108	5
2-on-1 Headrail Shades	2 additional brackets provided

COMPONENTS INCLUDED IN THE BOX

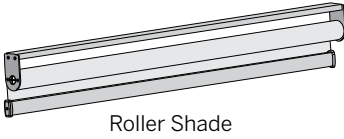

Roller Shade



Valance

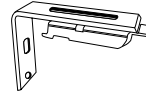
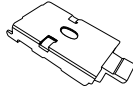

Mounting Brackets
(L bracket only required
on outside mount)

Hex Head Screws

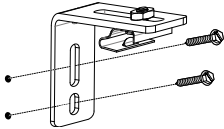

Mounting Brackets-Valance
(outside mount only)

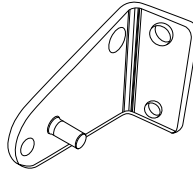

Hold Down Brackets
(optional)

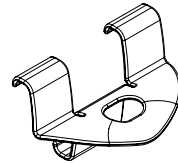

Cordless Handle
(optional)

- Shade
- Mounting Brackets, Shade and Valance
- Installation Hardware

Optional items will be included, if selected at time of shade order.

GETTING STARTED

TOOLS AND FASTENERS YOU MAY NEED (not included)

The tools you will need for installing your shade will vary, depending on the installation surface and mounting bracket type.

Tools typically used for installation include:

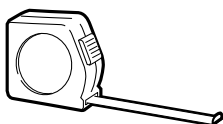

Metal Tape Measure

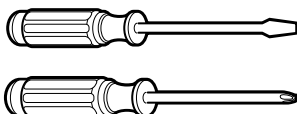

Screwdrivers
(both flat and Phillips head)



1/4" and 3/8" Nutdrivers



Safety Glasses

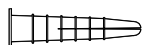

Drywall Anchors



Pencil

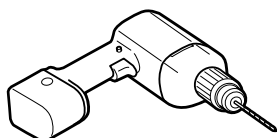

Drill with Bits



Level



Ladder



CAUTION: Use drywall anchors when mounting into drywall. (Not provided.) Failure to properly anchor shade could cause shade to fall possibly resulting in injury.

INSIDE MOUNT (IM)

STEP 1: MARKING THE BRACKET LOCATIONS

IMPORTANT: Before marking bracket locations, ensure that your bracket placement will not interfere with any components inside the headrail.

- Verify that your window casing has a minimum depth of 1 ½" which allows for a partially recessed headrail mount.
- If flush mount (fully recessed mount) is desired, a minimum mounting depth of 3 ¼" is required.
- Place brackets on inside surface of valance, flush with the edge at either end.
- Mark screw locations for each end bracket onto the valance.

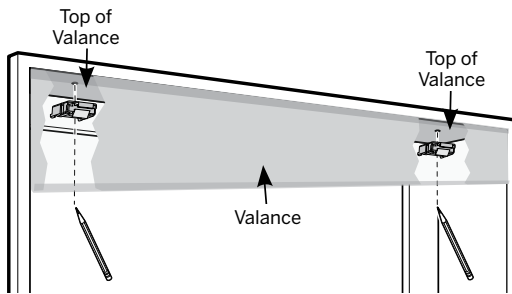

STEP 2: INSTALLING THE BRACKETS

- Put the valance in the window frame and using the marks, pre-drill screw holes through the valance into the frame.
 - If installing brackets into wood, use supplied screws.
 - If installing into drywall, use anchors in combination with supplied screws.
- Screw in brackets through valance into the window frame at marked locations.
- Ensure all brackets are square with each other.

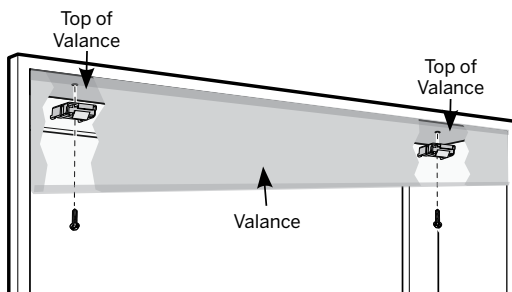

INSTALLATION

INSIDE MOUNT (IM)

STEP 3: INSTALLING THE SHADE

- Attach open edge of the headrail into metal grooves.
 - Bracket should snap securely into headrail grooves.

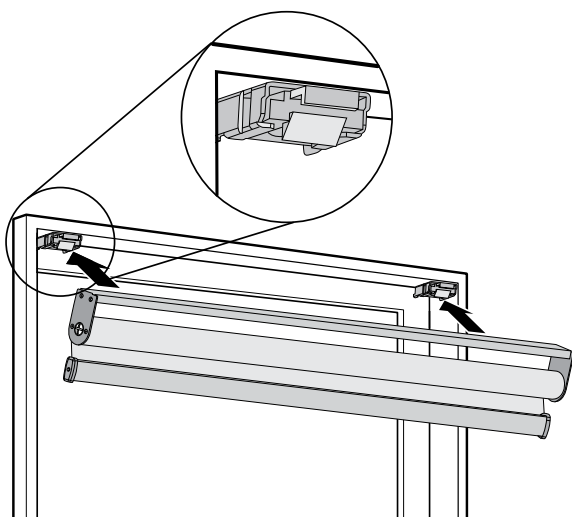

CAUTION: Be sure the brackets are properly engaged before operating the shade. Failure to do so may result in the shade falling and possible injury.

OUTSIDE MOUNT (OM)

STEP 1: MARKING THE BRACKET LOCATIONS

IMPORTANT: The brackets must be flush against a flat mounting surface. Do NOT mount brackets on curved molding.

- Center the shade over the window opening at the desired height.
- Mark screw location for each end bracket, 2 holes per bracket.
 - Use a level to ensure all brackets are aligned.

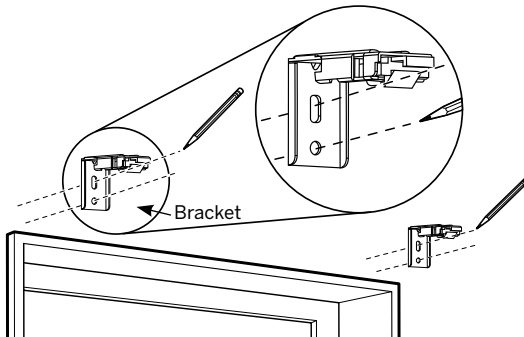

STEP 2: INSTALLING THE SHADE BRACKETS

- Pre-drill screw holes using a $\frac{1}{16}$ " drill bit, using pencil marks as a guide.
 - If installing brackets into wood, used supplied screws.
 - If installing into drywall, use anchors in combination with supplied screws.
- Screw in brackets at marked locations, 2 screws per bracket.
- Ensure all brackets are square with each other.

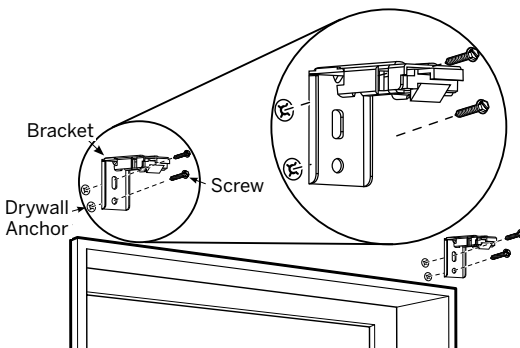

INSTALLATION

OUTSIDE MOUNT (OM)

STEP 3: INSTALLING VALANCE BRACKETS

- Place valance mounting brackets approximately 3" in from either end bracket for the shade.

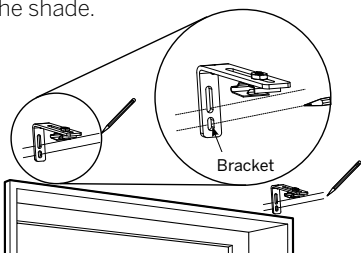

- Mark screw locations for a level valance.

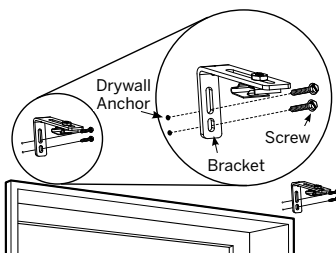

- Screw valance brackets into the wall.

STEP 4: ASSEMBLING VALANCE

- On both ends, attach valance returns.
 - Slide the corner clip onto a return panel.
 - Slide assembled return panel onto the ends of the valance.
- On both ends, attach fabric.
 - Ensuring fabric extends equally over the ends, wrap the fabric around the end of the return panel.
 - Pull tight to remove wrinkles.
 - Remove masking tape and apply to fabric on back of valance.
 - Press the caps into place.

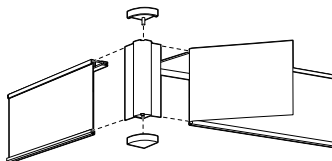

STEP 5: INSTALLING THE SHADE AND VALANCE

- Attach open edge of the headrail into metal grooves.
 - Bracket should snap securely into headrail grooves.
- Align the valance so the top of the valance can slide into valance bracket.
 - Valance spacing from the wall can be adjusted by loosening hex nut, adjusting, and retightening.

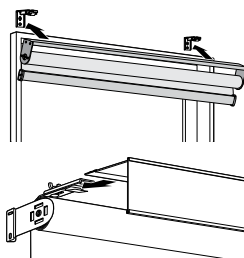

CAUTION: Be sure the bracket and headrail are properly secured before operating the shade. Failure to do so may result in the shade falling and possible injury.

INSTALL BOTTOM RAIL OPERATING HANDLE(S)

- Locate optional bottom rail handle that arrived with your shade.
- Insert front lip of the bottom rail handle into the top of the bottom rail of the shade. The handle will snap into place.
 - Optional bottom rail tassel will come attached to shade.

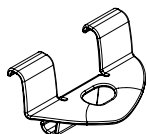

Roller Shade
Bottom Rail Clip



Roller Shade
Tassel

HOLD-DOWN BRACKETS (optional)

- Ideal for doors, hold-down brackets prevent shade from swaying. Assemble as shown to each side of bottom rail.
- Position hold down brackets against wall / frame, mark screw hole locations.
- Screw into marked hole locations.

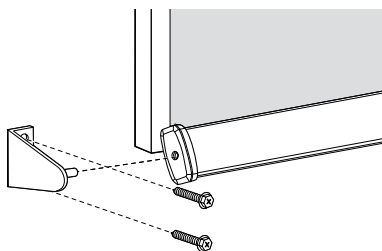

OPERATION

CORDLESS

- Pull the bottom rail of shade towards bottom of window frame to the desired height.
 - Optional bottom rail handles may be used.
- Gently pull bottom rail and release shade, and it will raise fully unless stopped at a new height.

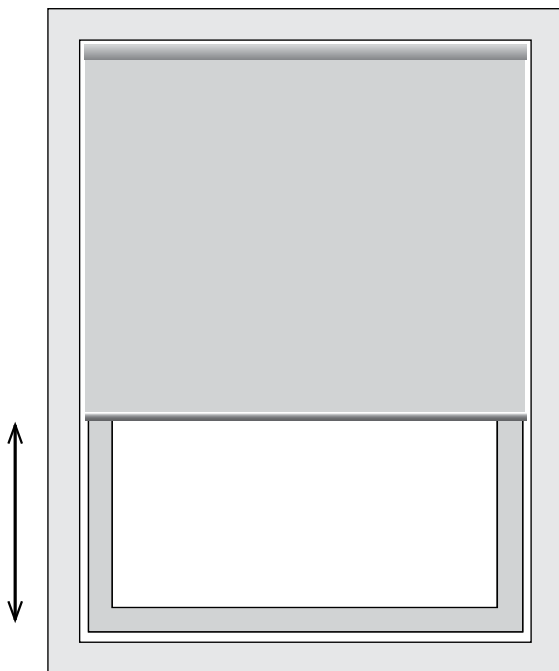

REMOVING THE SHADE

- Fully raise the shade.
- Press in the clear tab on the shade bracket.
- Release one edge of the headrail from the bracket.
- Rotate the shade to release the other edge of the headrail from the bracket.
- Uninstall remaining brackets if necessary.

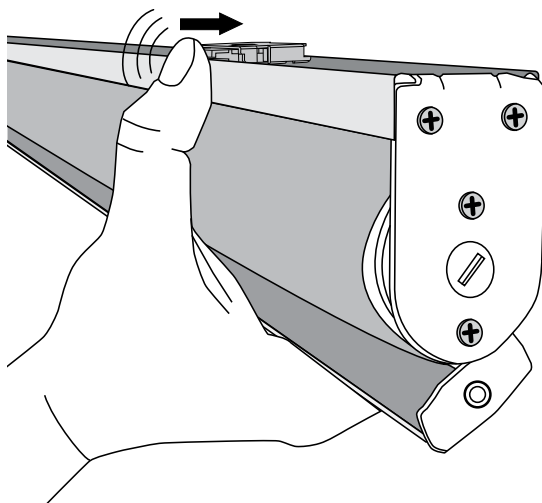

CAUTION: Hold shade firmly when removing. Failure to do so may result in the shade falling and possible injury.

CLEANING AND CARE

CLEANING PROCEDURES

All LEVOLOR Roller Shades have multiple cleaning options.

NOTICE: Avoid contact with window cleaning products. Improper cleaning may void warranty.



DUSTING

Use a feather duster for regular cleaning.



FORCED AIR

Blow away dirt and debris using clean compressed air.



PROFESSIONAL INJECTION/EXTRACTION CLEANING

Call local on-site blind/shade cleaner that injects a cleaning solution into the fabric and extracts the dirty solution at the same time. The service is typically performed at home so you do not need to remove your window treatments.



VACUUMING

Use a low suction vacuum with a brush-type cleaner attachment; stroke lightly over the shade to clean.



SPOT-CLEANING/STAIN REMOVAL AT HOME

Use warm water and a mild soap, like Woolite® or Scotchgard®, if needed. Do not immerse shade in water.

TROUBLESHOOTING TIPS

- Do not lower the shade past the ordered length. (If it is lowered beyond the limit, the tube underneath the roller will be exposed and fabric damage could occur.)

WARRANTY

For complete warranty information visit LEVOLOR.com or call Customer Service at 1-800-LEVOLOR or 1-800-538-6567.

CONTACTING US

To contact LEVOLOR Customer Service regarding any questions or concerns you may have about your new shades, you may reach us at: 1-800-LEVOLOR (8:30 am – 6:30 pm EST)

www.LEVOLOR.com

ADDITIONAL PARTS AND SERVICES

Additional or replacement parts can be ordered, or shades can be repaired or restrung through our repair center. Please contact LEVOLOR customer service through www.LEVOLOR.com for a return authorization number.

LEVOLOR®

Roller Shades–Fabric/Solar/Banded
Cortinas enrollables: en tela / solares / en franjas
Stores à enroulement automatique – Tissu/solaire/rubané

INSTALLATION • OPERATION • CARE
INSTALACIÓN • MANEJO • CUIDADO
INSTALLATION • UTILISATION • ENTRETIEN

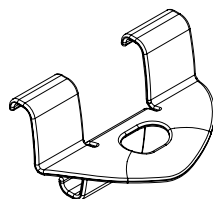
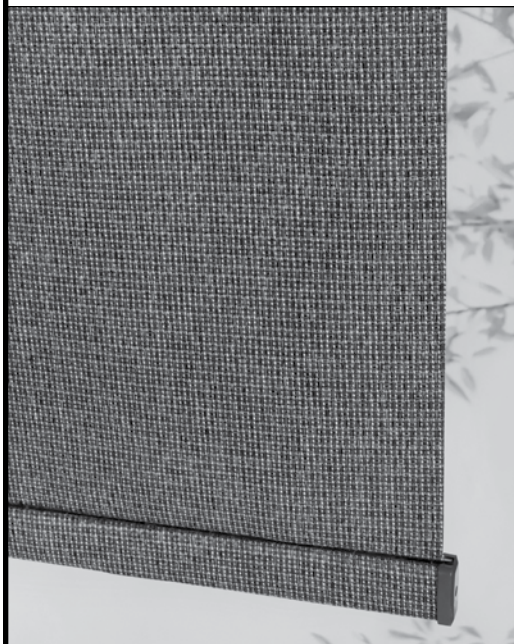

Cordless Handle Fabric/Solar
Manija sin cordón En tela / solar
Poignée sans cordon Tissu/solaire

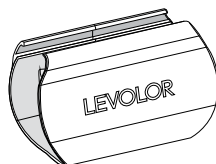

Cordless Handle Banded
Manija sin cordón En franjas
Poignée sans cordon Rubané

Cordless Lift Control–Cassette Valance
Control de elevación sin cordón: cenefa de cassette
Commande de levage sans cordon – Cantonnière à cassette

CONTENTS

Window and Shade Terminology

Mounting Types and Window Terminology	3–4
---	-----

Getting Started

Components Included	5
Tools and Fasteners You May Need	6

Installation

Inside Mount	7–8
Outside Mount	9–10

Installation–Additional Components

Hold-Down Brackets (Optional)	11
-------------------------------------	----

Operation

Operating the Shade	12
---------------------------	----

Uninstall

Removing the Shade	13
--------------------------	----

Cleaning and Care..... 14

Additional Information and Support

Troubleshooting	15
Warranty	15
Customer Service Support.....	15

CANADIAN RESIDENTS ONLY

- Control operation systems vary by country. Call 1-866-937-1875 for more information.
- For all safety related inquiries, call 1-866-662-0666 or visit www.canada.ca, search "blind cords".



WARNING STRANGULATION HAZARD –

Young children can be strangled by cords. Immediately remove this product if a cord longer than 22 cm or a loop exceeding 44 cm around becomes accessible..



WARNING: Keep all small parts, components and packaging away from children as they pose a potential choking hazard which may result in serious injury or death. Please reference all warning tags and labels in the instructions and on the shade.

WINDOW AND SHADE TERMINOLOGY

Thank you for purchasing LEVOLOR® Roller Shades. With proper installation, operation, and care, your new roller shade will provide years of beauty and performance. Please thoroughly review this instruction booklet before beginning installation.

MOUNTING TYPES AND WINDOW TERMINOLOGY

If the installation brackets are mounted correctly, the rest of the installation process follows easily. To prepare for this important first step, review the mounting types and basic window terminology illustrated below.

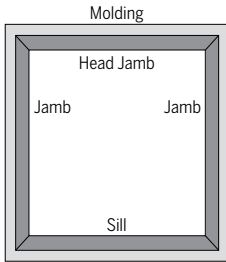

Window Components Terminology

- Collectively, the sill and jambs are called the "window casement" or "frame".

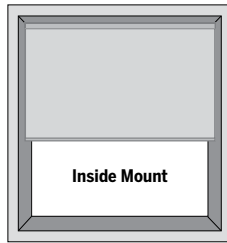

Inside Mount

- Shade fits within window opening.
- Great for windows with beautiful trim.

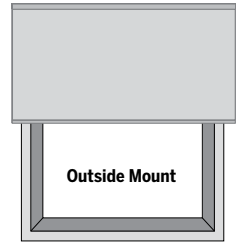

Outside Mount

- Shade mounts outside window opening.
- Increased light control and privacy.

WINDOW AND SHADE TERMINOLOGY

INSTALLATION OVERVIEW

- **Leaving the shade rolled up completely will ease installation.**
- Confirm that the headrail and shade are the proper width and length.
- If installing several sets of shades, be sure to match them with the appropriate window.
- Check the installation surface to ensure that you have suitable fasteners and tools.
- Lay out and organize all parts and components.

Installation Brackets	
Your order will include the correct number of installation brackets for your shade width, as shown in the table below	
Shade Width (inches)	Number of Brackets per Shade
Up to 36	2
36 to 54	3
54 to 72	4
72 to 108	5
2-on-1 Headrail Shades	2 additional brackets provided

COMPONENTS INCLUDED IN THE BOX



Roller Shade – Fabric/Solar



Roller Shade – Banded

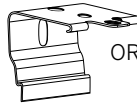

OR

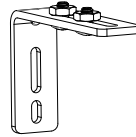

Mounting Brackets
(L Bracket only required
on outside mount)



Hex Head Screws
(2 per Bracket)

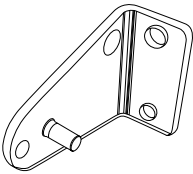

Hold-Down Brackets
(optional)

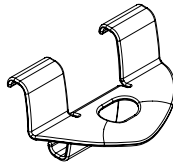

Cordless Handle – Fabric/Solar
(optional)



Cordless Handle – Banded
(optional)

- Shade
- Mounting Brackets
- Installation Hardware

Optional items will be included, if selected at time of shade order.

GETTING STARTED

TOOLS AND FASTENERS YOU MAY NEED (not included)

The tools you will need for installing your shade will vary, depending on the installation surface and mounting bracket type.

Tools typically used for installation include:

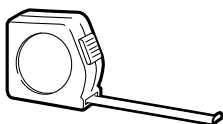

Metal Tape Measure

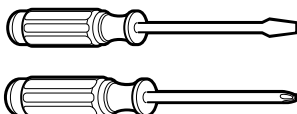

Screwdrivers
(both flat and Phillips head)



1/4" and 3/8" Nutdrivers



Safety Glasses

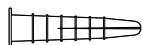

Drywall Anchors



Pencil

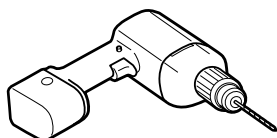

Drill with Bits



Level

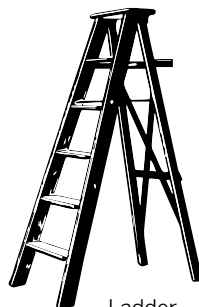

Ladder



CAUTION: Use drywall anchors when mounting into drywall. (Not provided.) Failure to properly anchor shade could cause shade to fall possibly resulting in injury.

INSIDE MOUNT (IM)

STEP 1: MARKING THE BRACKET LOCATIONS

IMPORTANT: Before marking bracket locations, ensure that your bracket placement will not interfere with any components inside the headrail.

- Verify that your window casing has a minimum depth of 1 ¾" which allows for a partially recessed headrail mount.
- If flush mount (fully recessed mount) is desired, a minimum mounting depth of 3" is required.
- Mark approximately 1" from each jamb for bracket location.
- Mark screw locations for each end bracket, 2 holes per bracket.
- If more than two installation brackets come with your order, space additional bracket(s) evenly between the two end brackets, no more than 30" apart.

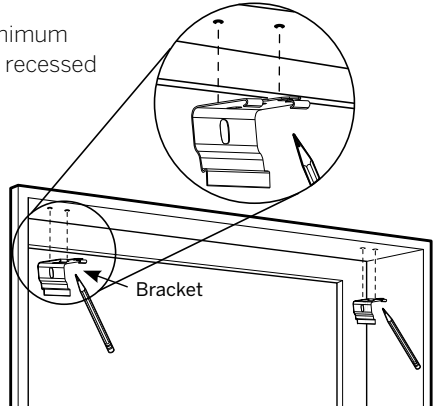

STEP 2: INSTALLING THE BRACKETS

- Pre-drill screw holes.
 - If installing brackets into wood, used supplied screws.
 - If installing into drywall, use anchors in combination with supplied screws.
- Screw in brackets at marked locations, 2 screws per bracket.
- Ensure all brackets are square with each other.

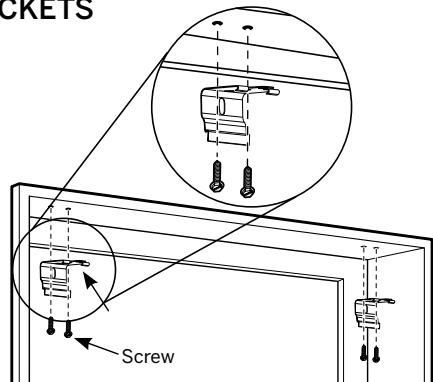

INSTALLATION

INSIDE MOUNT (IM)

STEP 3: INSTALLING THE SHADE

- Hook the top, middle rib of the cassette valance onto all of the bracket hooks.
- Rotate the back of the cassette valance firmly upwards and toward the window until the groove at the bracket snaps into place.

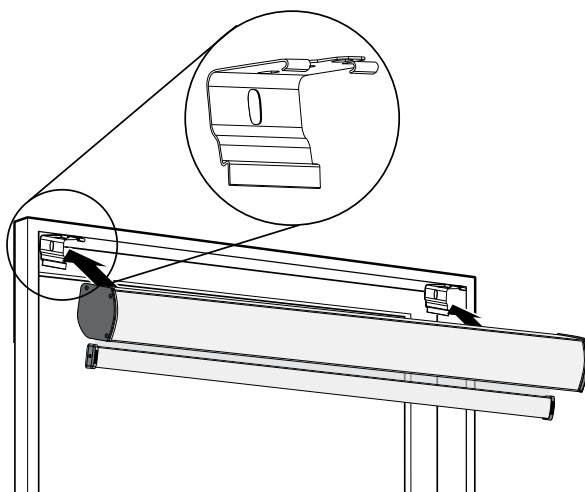

CAUTION: Be sure the brackets are properly engaged before operating the shade. Failure to do so may result in the shade falling and possible injury.

OUTSIDE MOUNT (OM)

STEP 1: MARKING THE BRACKET LOCATIONS

IMPORTANT: The brackets must be flush against a flat mounting surface. Do NOT mount brackets on curved molding.

- Center the shade over the window opening at the desired height.
- Mark screw locations for each L bracket approximately 3" from end of cassette, 2 holes per bracket.
 - Use a level to ensure all brackets are aligned.

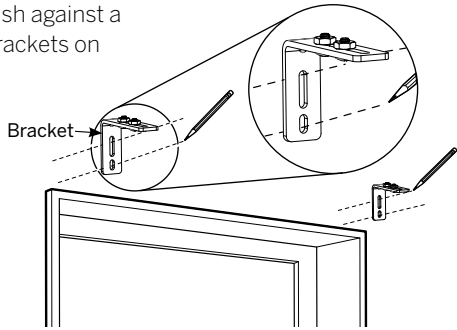

- If more than two installation brackets come with your order, space additional bracket(s) evenly between the two end brackets, no more than 30" apart.

STEP 2: INSTALLING THE BRACKETS

- Pre-drill screw holes using a $\frac{1}{16}$ " drill bit, using pencil marks as a guide.
 - If installing brackets into wood, use supplied screws.
 - If installing into drywall, use anchors in combination with supplied screws.
- Screw in L brackets at marked locations, 2 screws per bracket.
- Ensure all L brackets are square with each other.
- Attach cassette mounting bracket to L bracket using screws and hex nuts.
 - Make sure the release tab is always mounted on the bottom.

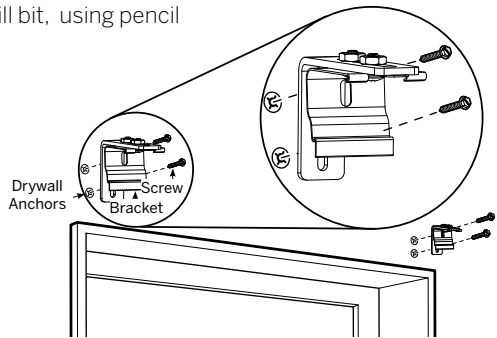

INSTALLATION

OUTSIDE MOUNT (OM)

STEP 3: INSTALLING THE SHADE

- Hook the top, middle rib of the cassette valance onto all of the bracket hooks.
- Rotate the back of the cassette valance firmly upwards and toward the window until the groove at the bracket snaps into place.

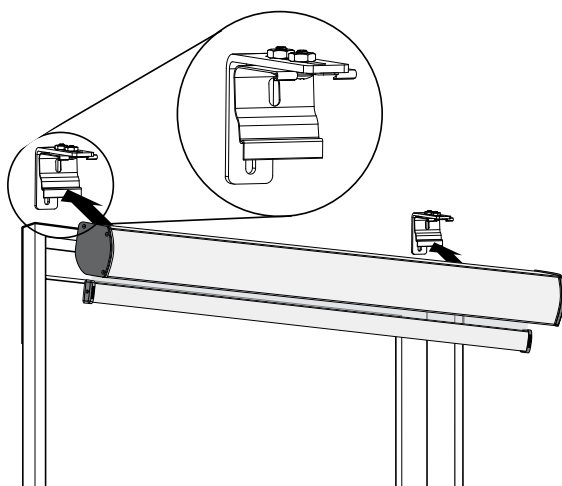

CAUTION: Be sure the bracket and headrail are properly secured before operating the shade. Failure to do so may result in the shade falling and possible injury.

INSTALL BOTTOM RAIL OPERATING HANDLE(S)

- For Fabric/Solar shades, insert front lip of the optional bottom rail handle into the top of the bottom rail of the shade. The handle will snap into place.
 - For Fabric/Solar shades, optional Tassel will come attached to shade.
 - For Banded shades, Bottom Rail Handle will come attached to shade.

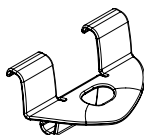

Fabric/Solar
Handle



Tassel



Banded Handle

HOLD-DOWN BRACKETS (optional)

- Ideal for doors, hold-down brackets prevent shade from swaying. Assemble as shown to each side of bottom rail.
- Position hold-down brackets against wall / frame, mark screw hole locations.
- Screw into marked hole locations.

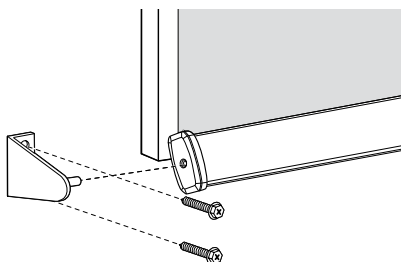

OPERATION

CORDLESS

- Pull the bottom rail of shade towards bottom of window frame to the desired height.
 - Optional bottom rail handles may be used.
- Gently pull bottom rail and release shade, and it will raise fully unless stopped at a new height.

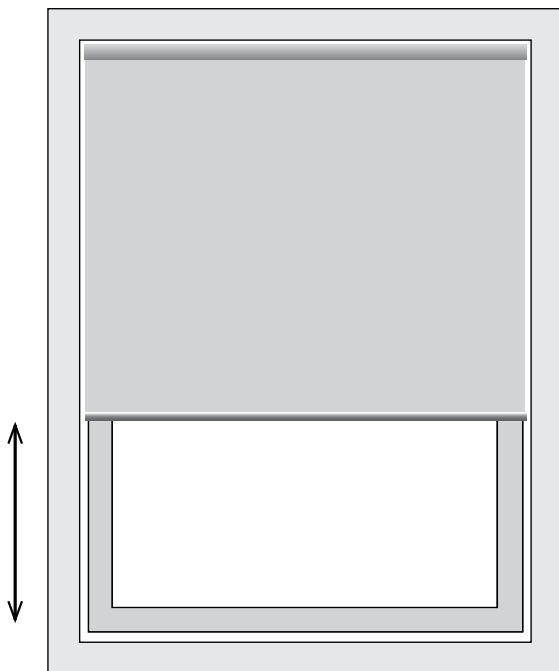

REMOVING THE SHADE

- Fully raise the shade.
- Press in the clear tab on the shade bracket.
- Release one edge of the headrail from the bracket.
- Rotate the shade to release the other edge of the headrail from the bracket.
- Uninstall remaining brackets if necessary.

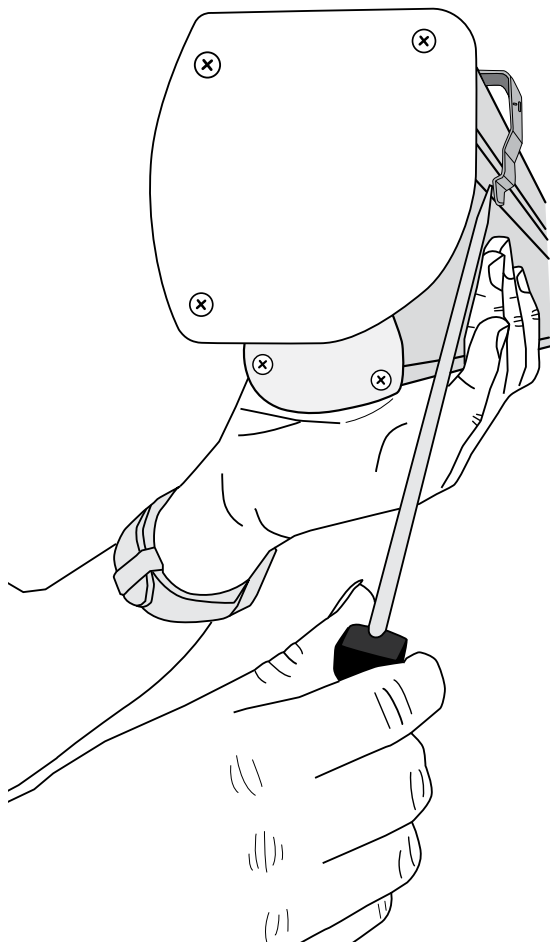

CAUTION: Hold shade firmly when removing. Failure to do so may result in the shade falling and possible injury.

CLEANING AND CARE

CLEANING PROCEDURES

All LEVOLOR Roller Shades have multiple cleaning options.

NOTICE: Avoid contact with window cleaning products. Improper cleaning may void warranty.



DUSTING

Use a feather duster for regular cleaning.



FORCED AIR

Blow away dirt and debris using clean compressed air.



PROFESSIONAL INJECTION/EXTRACTION CLEANING

Call local on-site blind/shade cleaner that injects a cleaning solution into the fabric and extracts the dirty solution at the same time. The service is typically performed at home so you do not need to remove your window treatments.



VACUUMING

Use a low suction vacuum with a brush-type cleaner attachment; stroke lightly over the shade to clean.



SPOT-CLEANING/STAIN REMOVAL AT HOME

Use warm water and a mild soap, like Woolite® or Scotchgard®, if needed. Do not immerse shade in water.

TROUBLESHOOTING TIPS

- Do not lower the shade past the ordered length. (If it is lowered beyond the limit, the tube underneath the roller will be exposed and fabric damage could occur.)

WARRANTY

For complete warranty information visit LEVOLOR.com or call Customer Service at 1-800-LEVOLOR or 1-800-538-6567.

CONTACTING US

To contact LEVOLOR Customer Service regarding any questions or concerns you may have about your new shades, you may reach us at: 1-800-LEVOLOR (8:30 am – 6:30 pm EST)

www.LEVOLOR.com

ADDITIONAL PARTS AND SERVICES

Additional or replacement parts can be ordered, or shades can be repaired or restrung through our repair center. Please contact LEVOLOR customer service through www.LEVOLOR.com for a return authorization number.

PROCEDIMIENTOS DE LIMPIEZA

Todas las persianas enrollables LEVOLOR tienen múltiples opciones de limpieza.

AVISO: evite el contacto con productos de limpieza de ventanas. La limpieza inadecuada puede anular la garantía.



LIMPIEZA DE POLVO

Use un plumero para la limpieza periódica.



VENTILACIÓN FORZADA

Elimine el polvo y la suciedad usando aire comprimido limpio.



LIMPIEZA PROFESIONAL DE INYECCIÓN/EXTRACCIÓN

Llame a un limpiador local de persianas/pantallas a domicilio que inyecte una solución de limpieza en la tela y extraiga la solución sucia al mismo tiempo. El servicio generalmente se realiza en el hogar, por lo que no es necesario que quite las decoraciones de la ventana.



ASPIRADO

Use una aspiradora de succión baja con un accesorio limpiador tipo cepillo; frote suavemente sobre la pantalla para limpiar.



LIMPIEZA/ELIMINACIÓN DE MANCHAS EN EL HOGAR

Use agua tibia y un jabón suave, como Woolite® o Scotchgard®, si es necesario. No sumerja la persiana en agua.

INFORMACIÓN ADICIONAL

GARANTÍA

Para obtener información completa sobre la garantía, visite LEVOLOR.com o llame al Departamento de Servicio al Cliente al 1-800-LEVOLOR o 1-800-538-6567.

CÓMO PONERSE EN CONTACTO CON NOSOTROS

Para ponerse en contacto con el Departamento de Servicio al Cliente de LEVOLOR con respecto a cualquier pregunta o inquietud que pueda tener sobre sus nuevas persianas, puede comunicarse con nosotros al 1-800-LEVOLOR (de 9:00 a.m. a 6:00 p.m., hora estándar del Este)

www.LEVOLOR.com