

Installation - Day/Night with Continuous Chain

Read the instructions carefully before assembling and using the product.
Assembling process can be completed by non-professionals. For indoor use only.

WARNING

- Young children can strangle in the loop of pull cords, chains and tapes, and cords that operate window coverings.
- To avoid strangulation and entanglement, keep cords out of the reach of young children. Cords may become wrapped around a child's neck
- Move beds, cots and furniture away from window covering cords.
- Do not tie cords together.
Make sure cords do not twist together and form a loop.

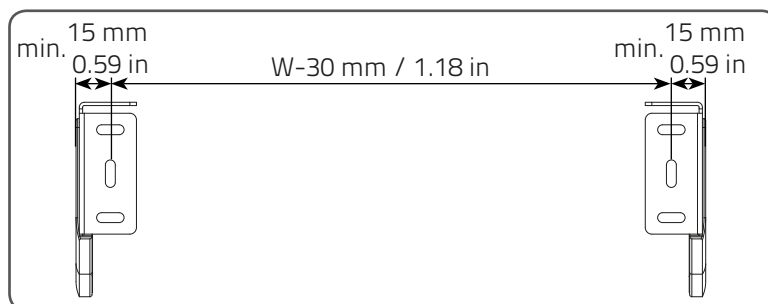
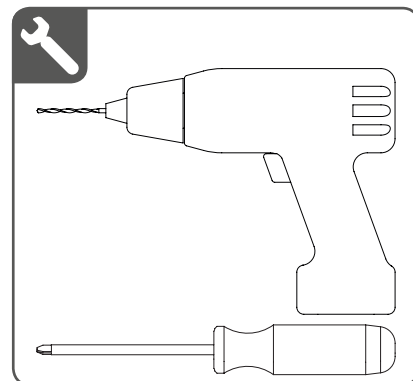
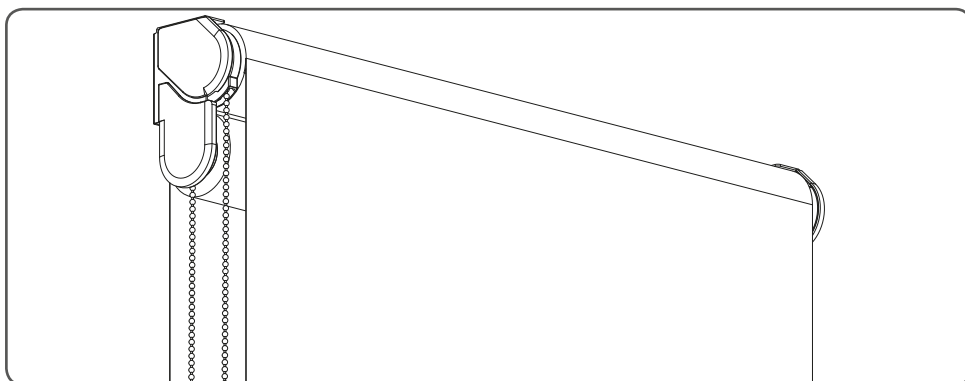
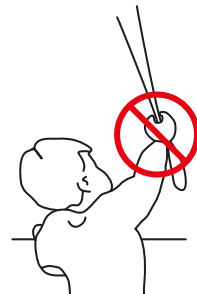

Step One:

- Attach the upper set of end caps before installing the brackets
- Align the pins on the inside of the end cap with the holes on the brackets as shown and press together

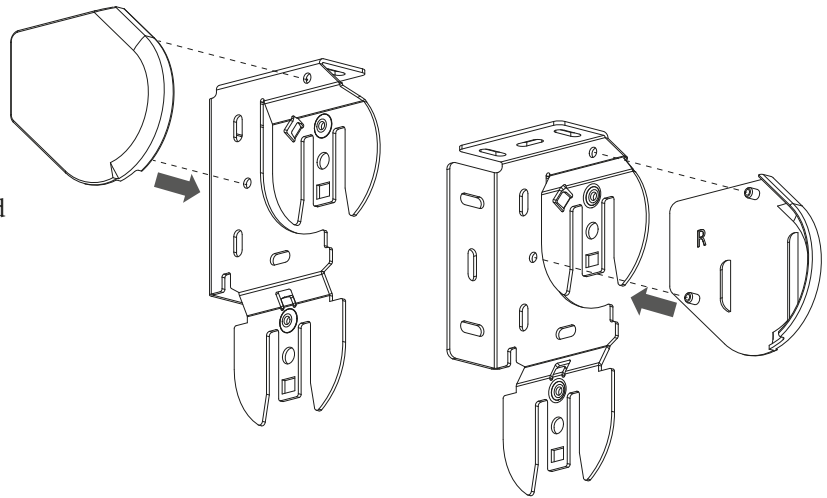

Outside Mount

Step Two:

- Use the brackets to mark the screw locations
- On outside mount, make your marks so the distance from the outside edge of the bracket to the outside edge of the other bracket equals your ordered width

Note: Brackets must be level to each other for the shade to operate properly (for both inside mount and outside mount).

Inside Mount

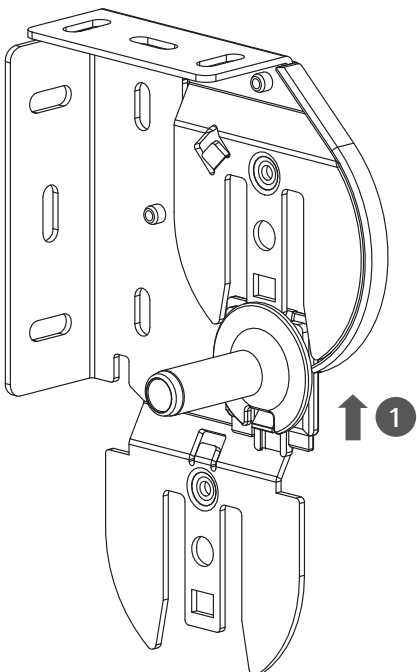
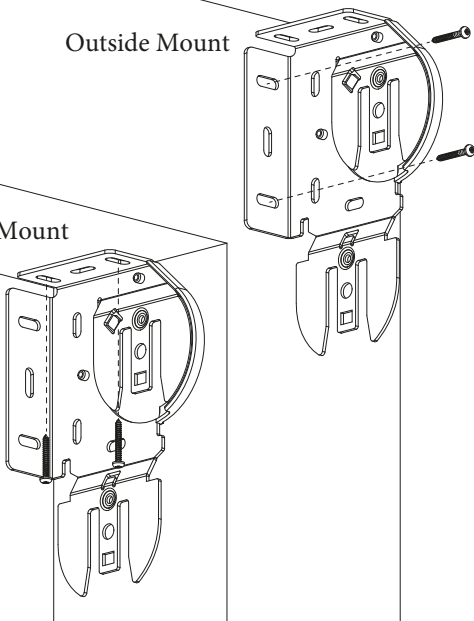

Step Three:

- The idle side attachment should be on the bracket opposite of the chain on the shade
- Simply click into the bracket if it is not already attached

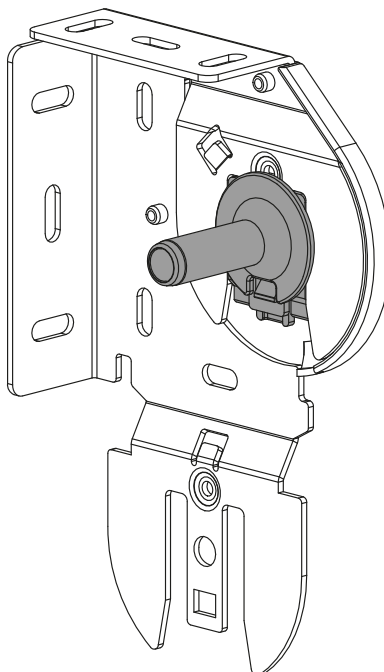

Step Four:

- Slide the idle side of the shade onto the idle pin

Note: The end plug is already installed on the idle side in the tube of the shade

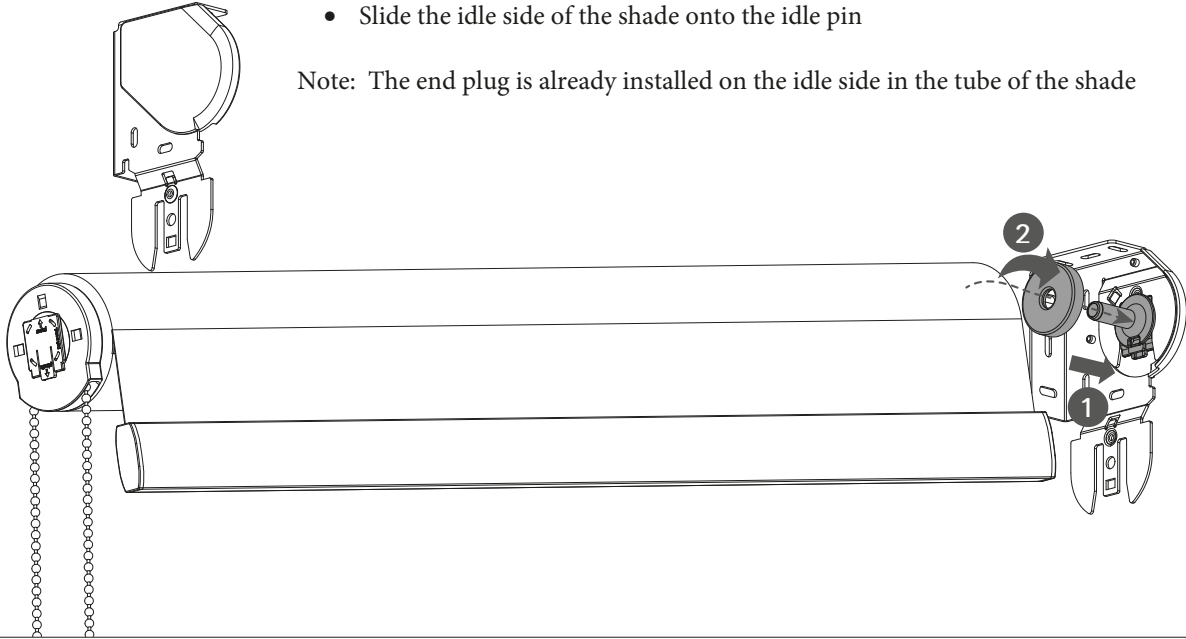

Step Five:

- Click the control side of the shade into bracket

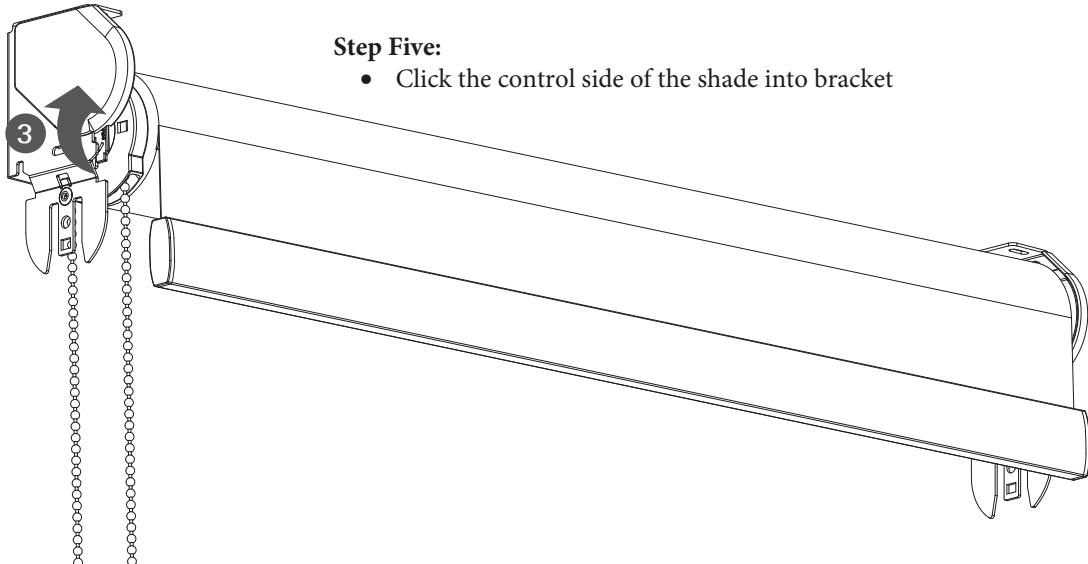

Step Six:

- Adjust the clutch so chain points to front to allow clearance to install the bottom/back shade

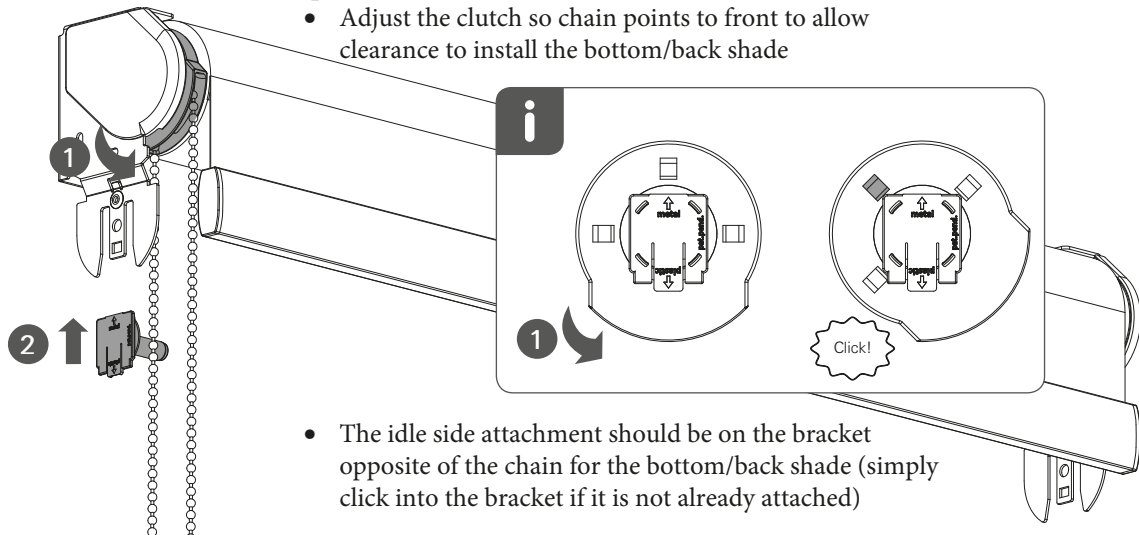

- The idle side attachment should be on the bracket opposite of the chain for the bottom/back shade (simply click into the bracket if it is not already attached)

Step Seven:

- Slide the idle side of the shade onto the idle pin

Note: The end plug is already installed on the idle side in the tube of the shade

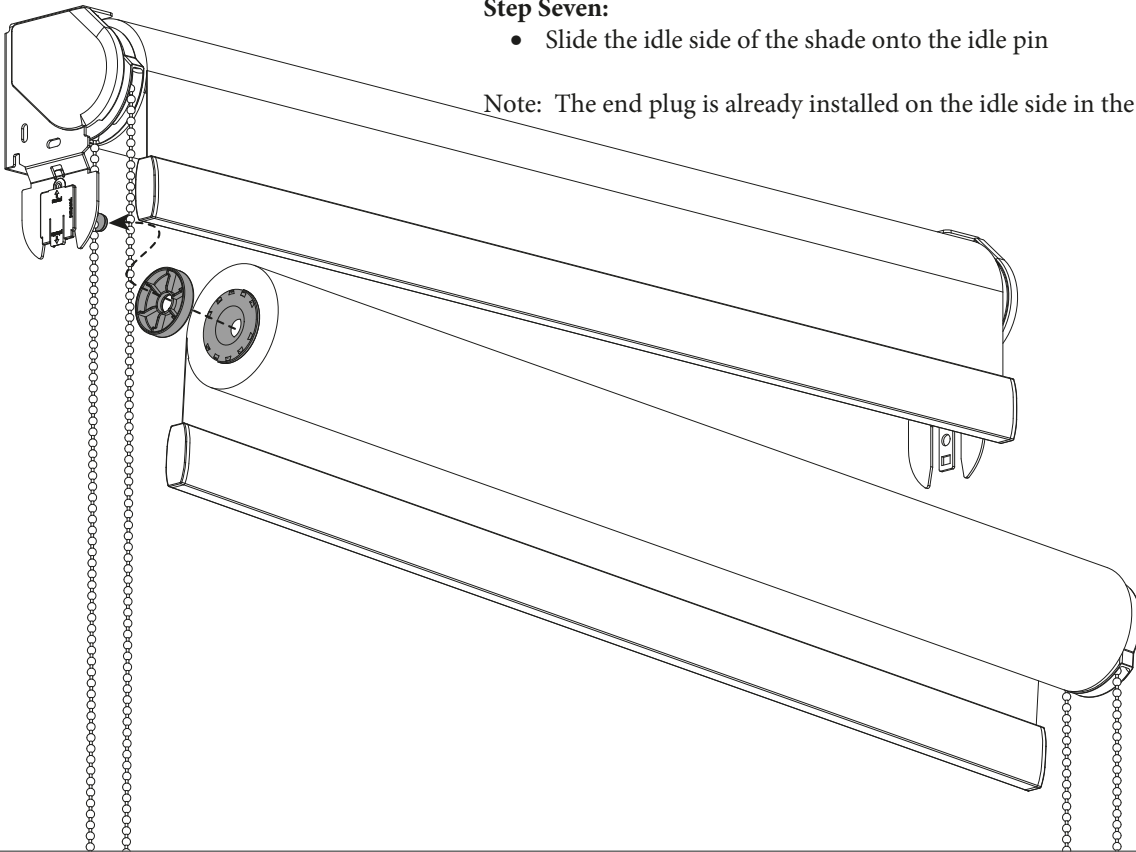

Step Eight:

- Click the control side of the shade into bracket

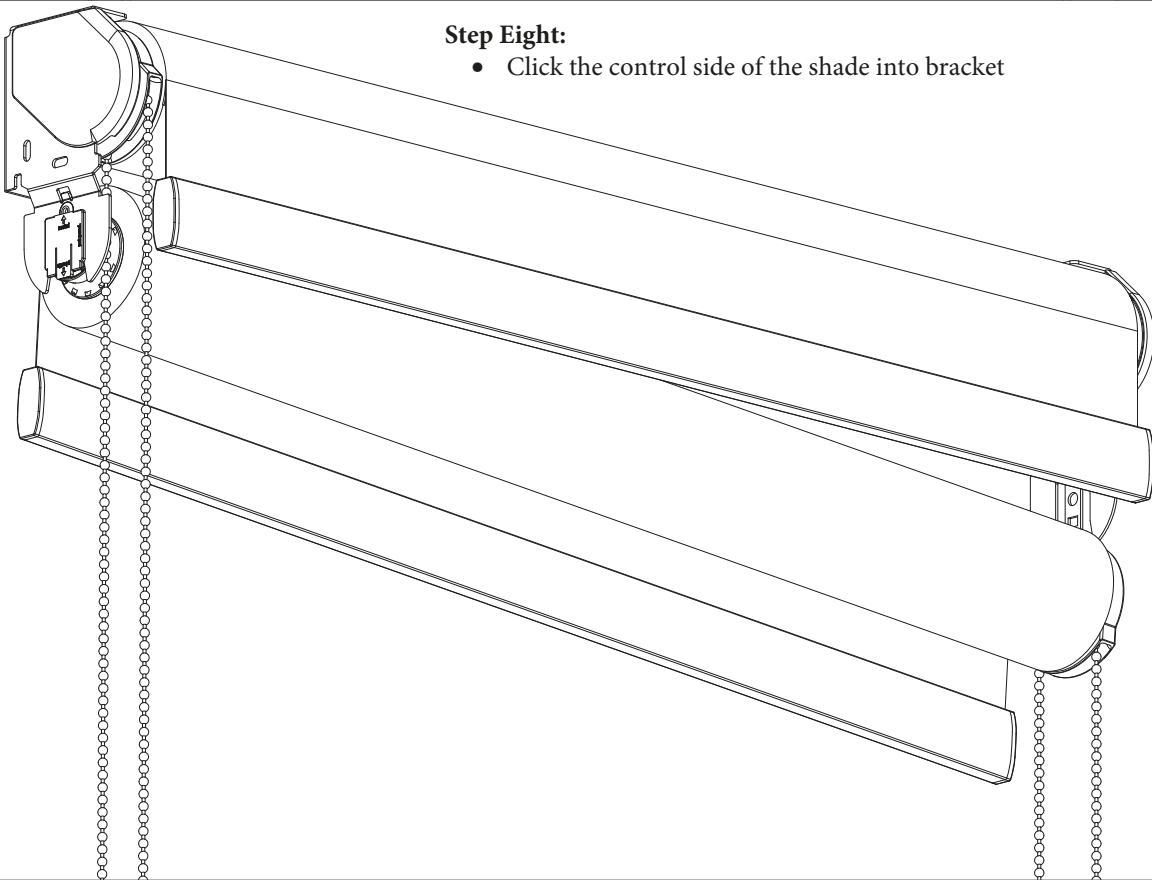

Step Nine:

- Attach the lower set of end caps to the brackets

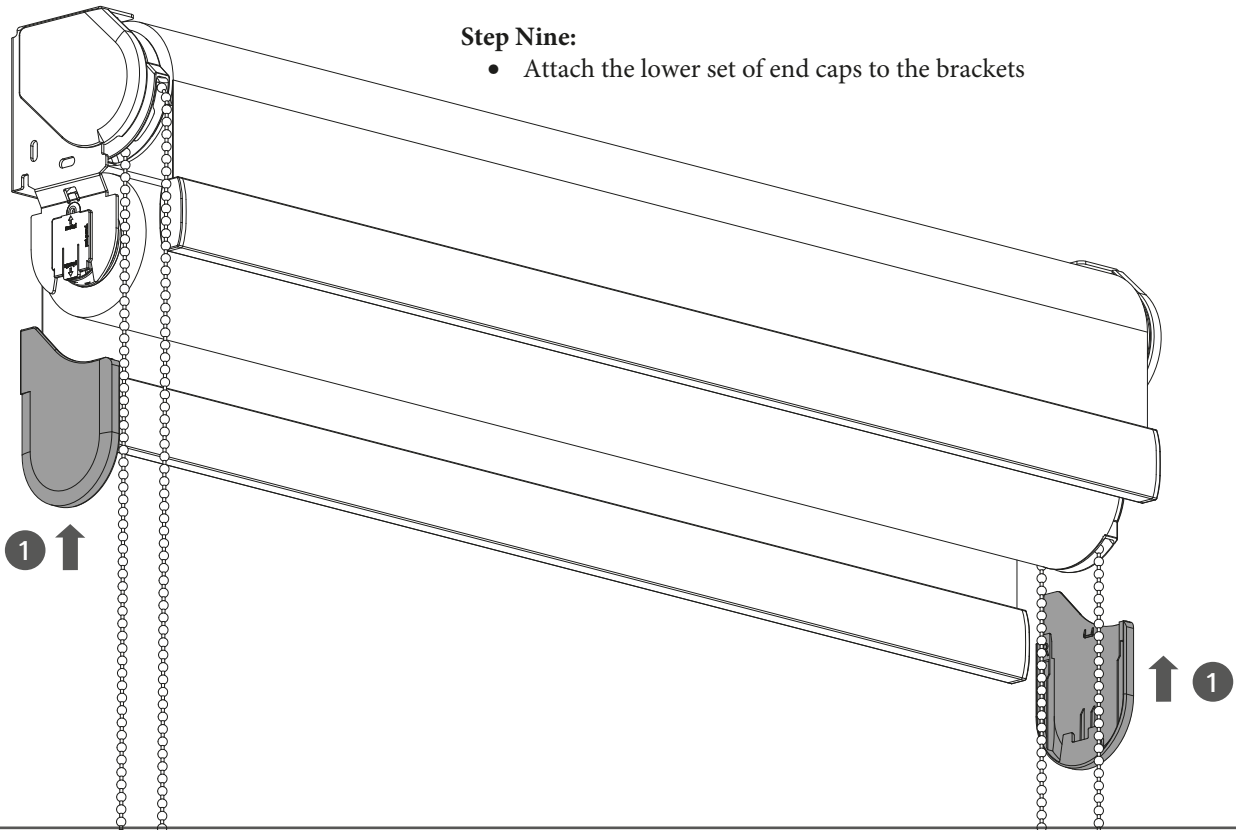

⚠ WARNING

Install the child safety device as specified in the childsafe manual.

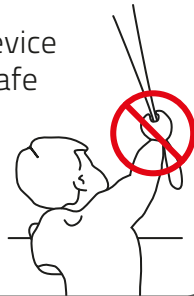

Final Step:

- Install the child safety device

Removal

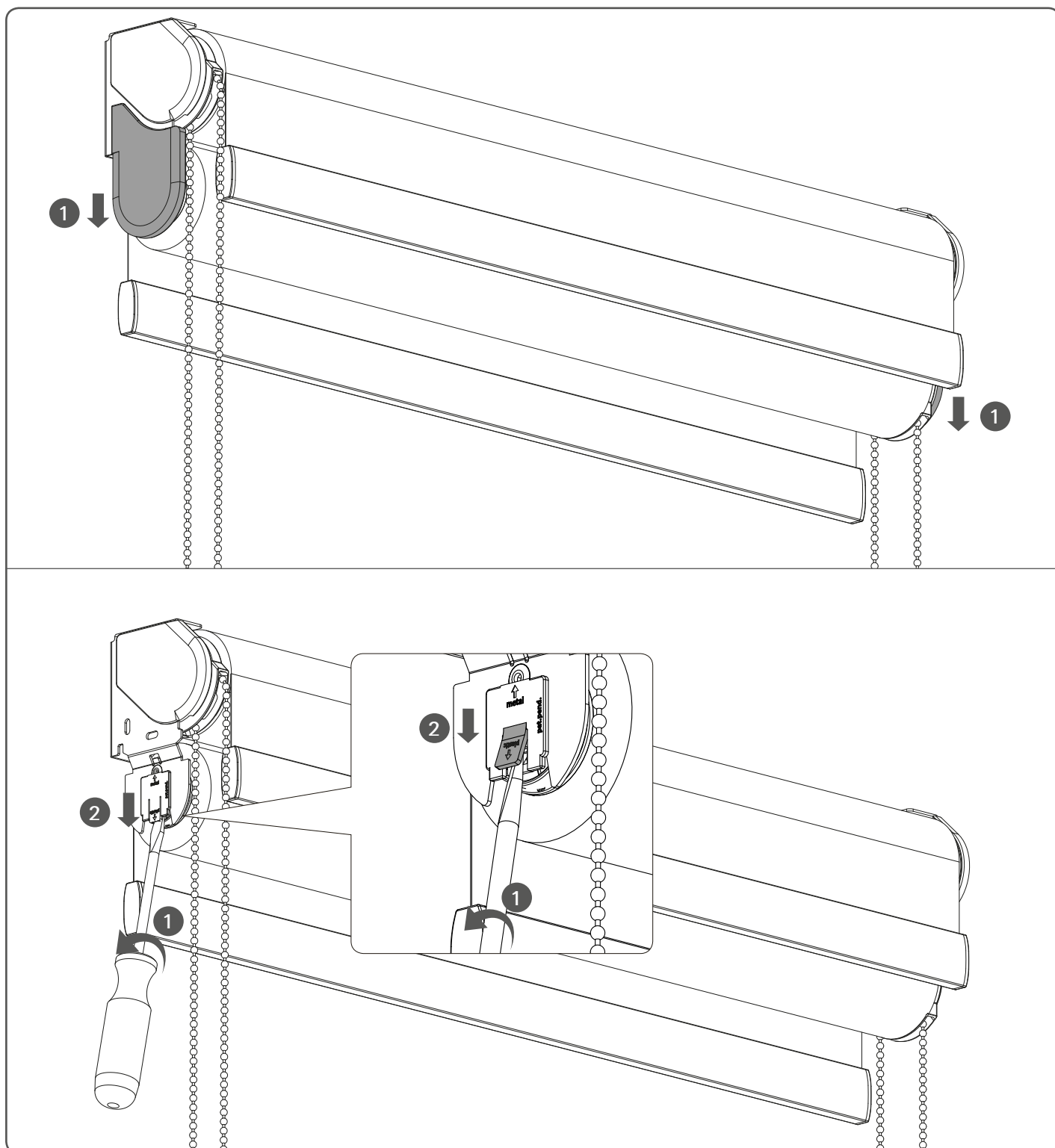

Installation - Fascia: Day/Night with Chain

Read the instructions carefully before assembling and using the product.
Assembling process can be completed by non-professionals. For indoor use only.

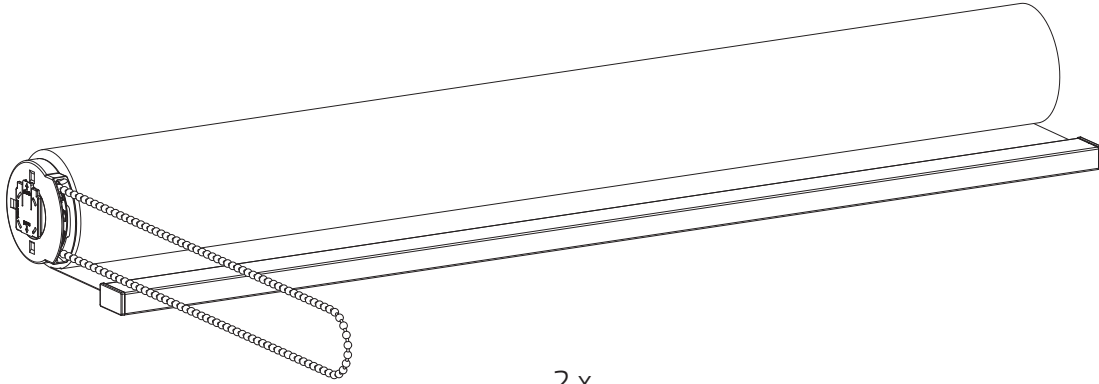

2 x

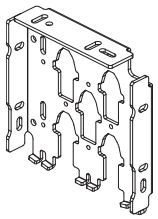

2 x

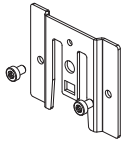

4 x

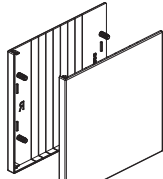

1 x

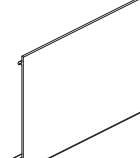

1 x



1 x

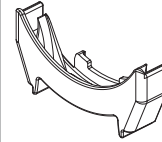

1 x

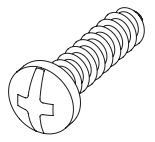

4 x

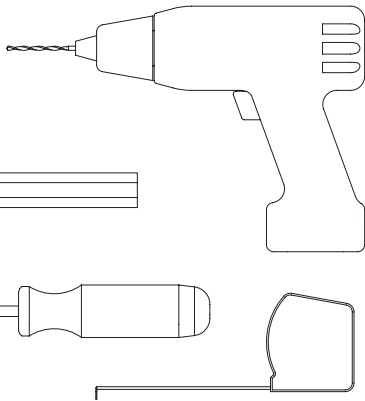

Inside mount

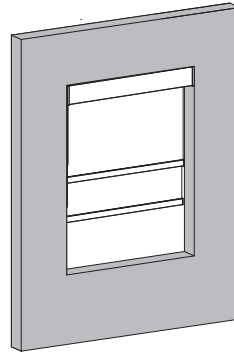

Outside mount

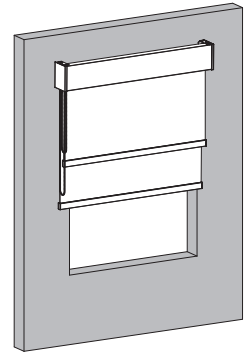

Deduct 45 mm or 1 3/4 inch from opening width for screw positions

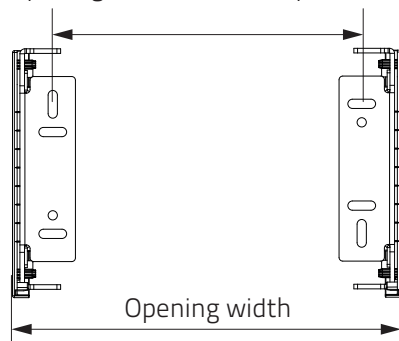

Outside Mount

Inside Mount

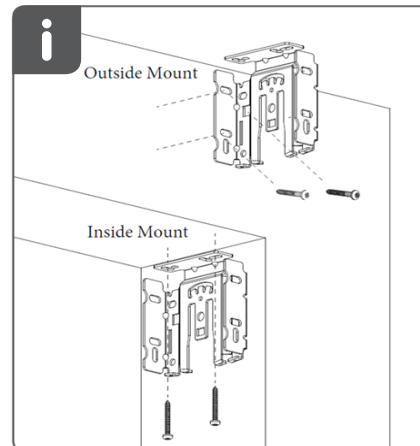

1

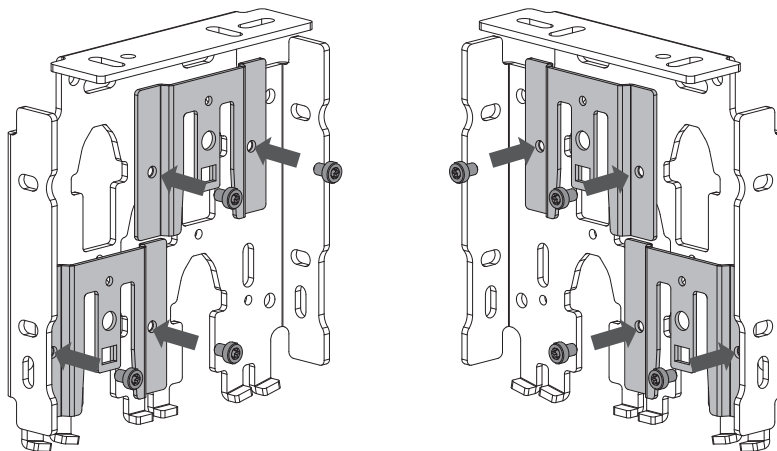

2



3

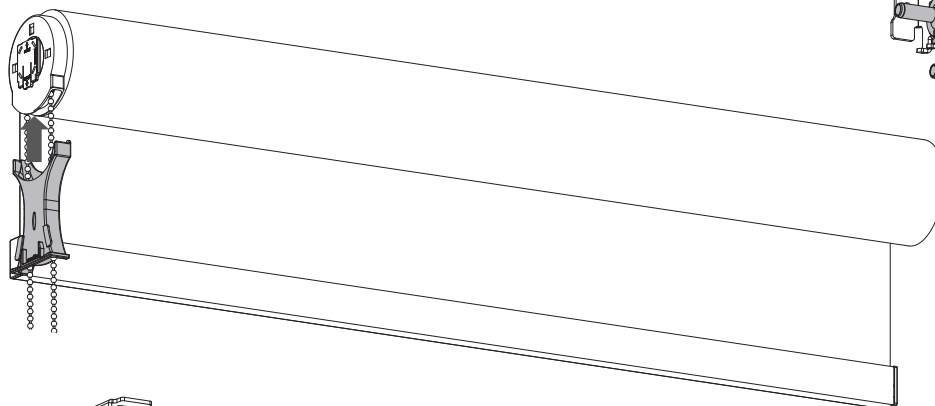

4

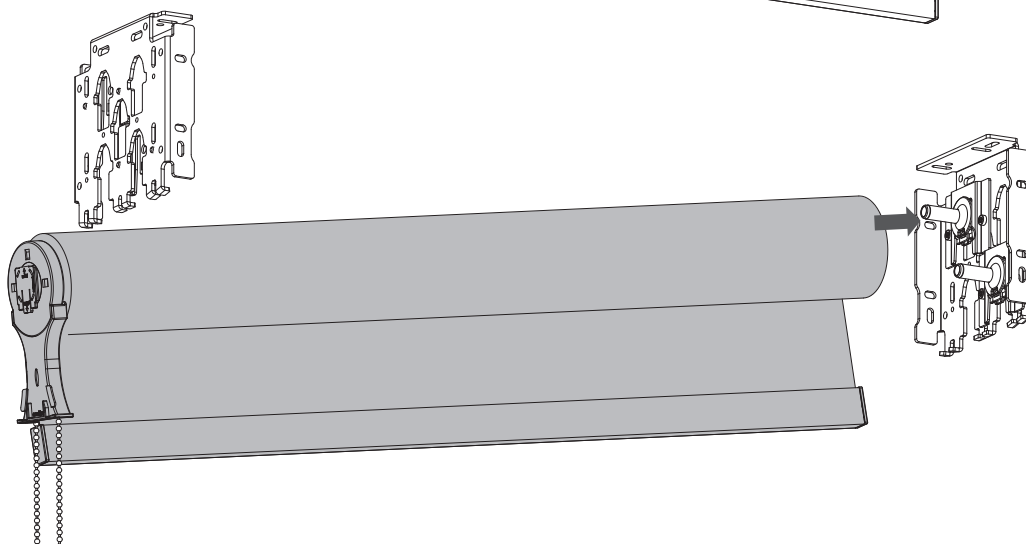

5

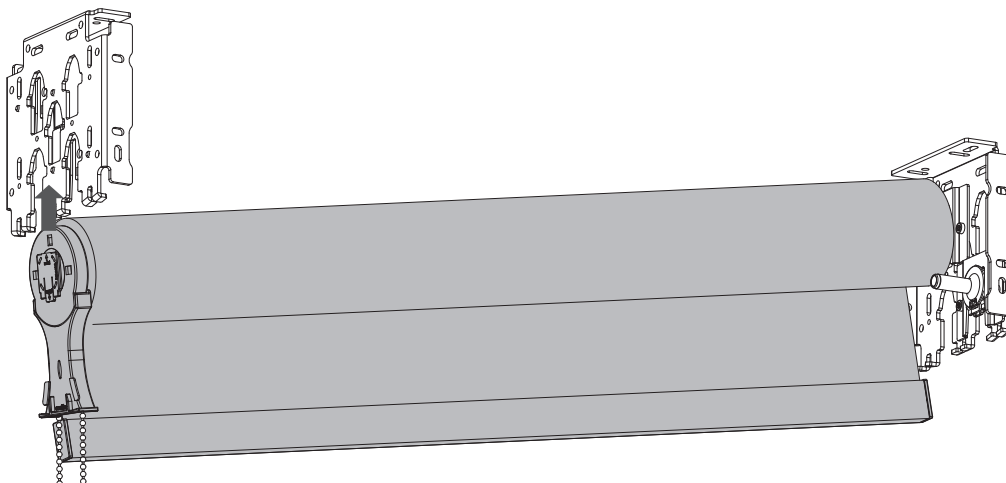

6

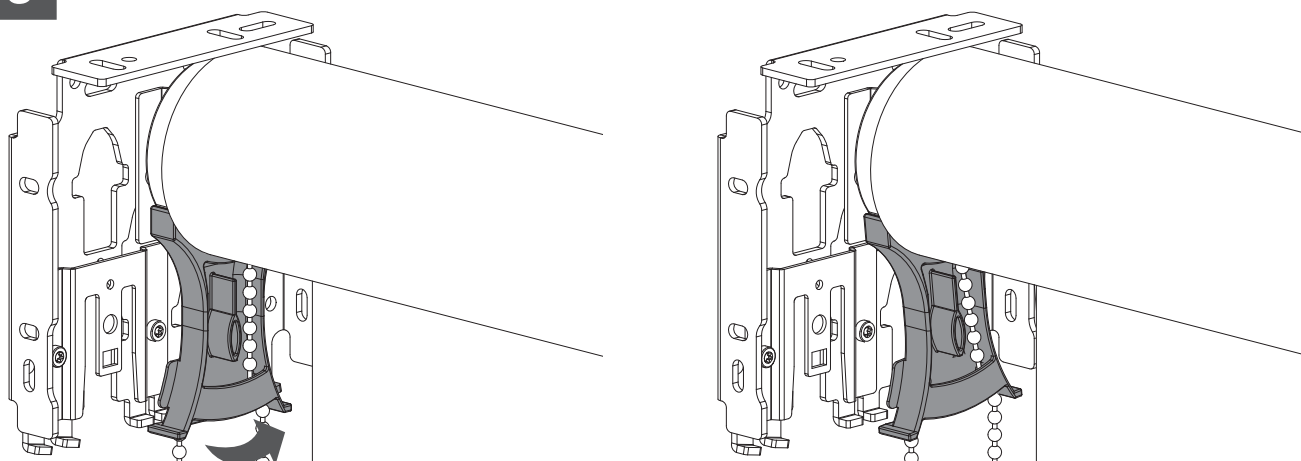

7

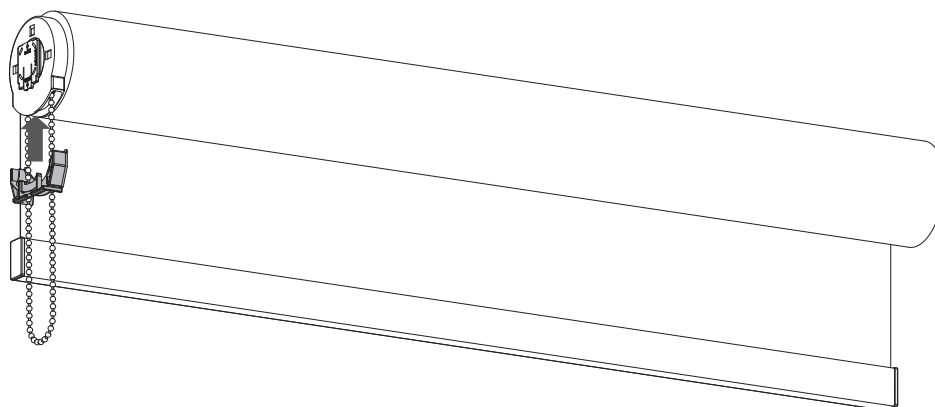

8

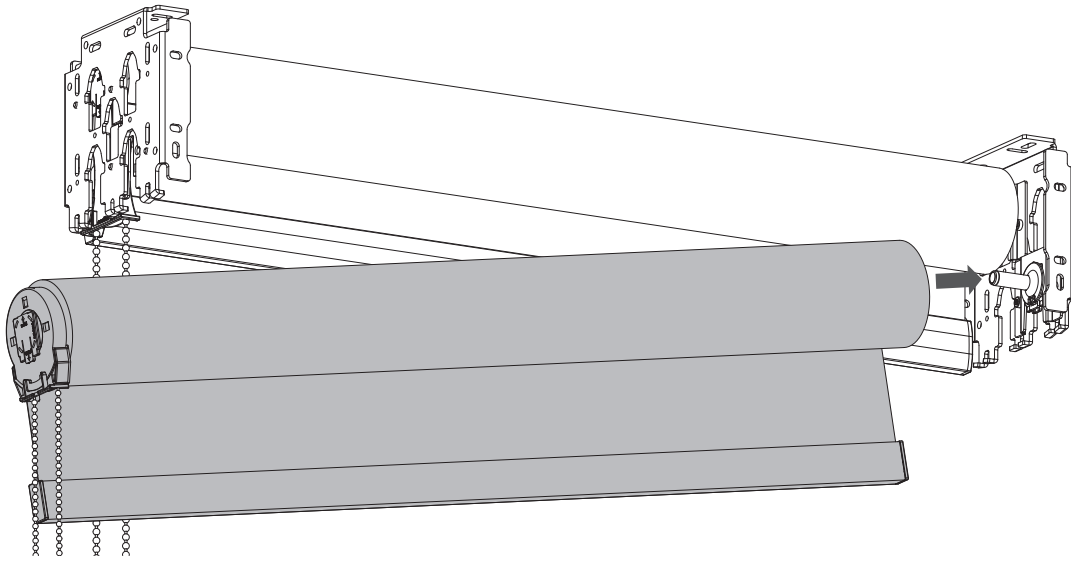

9

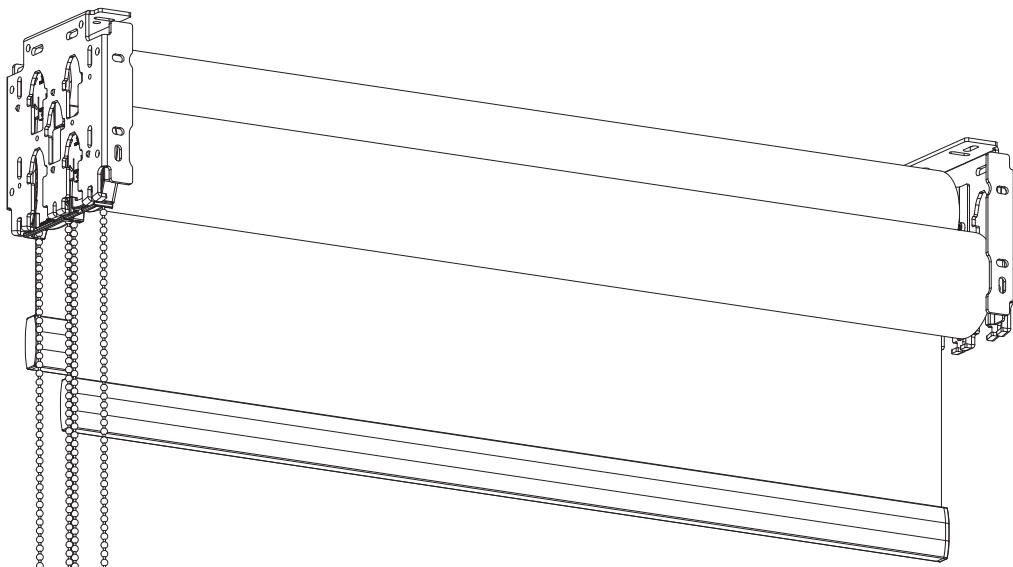
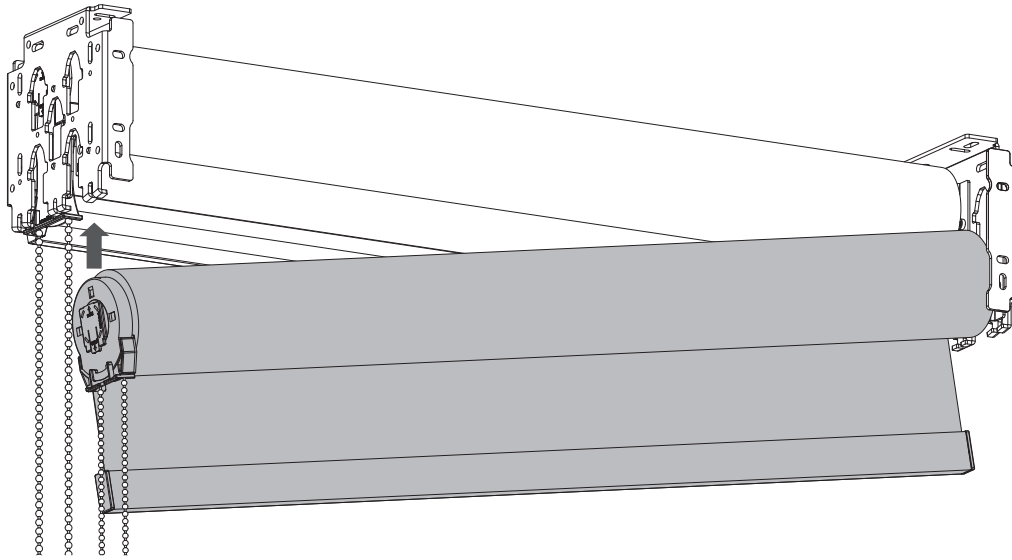

10

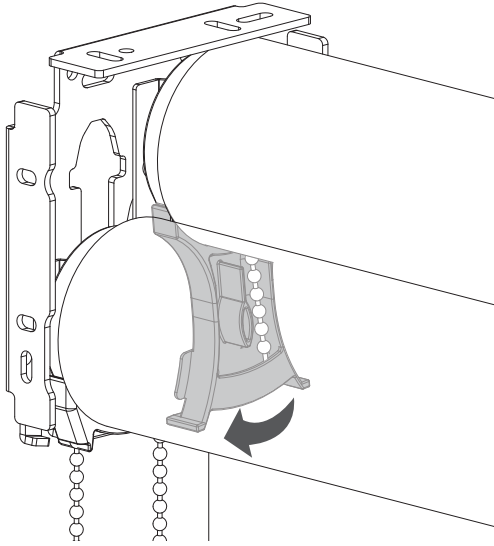

11

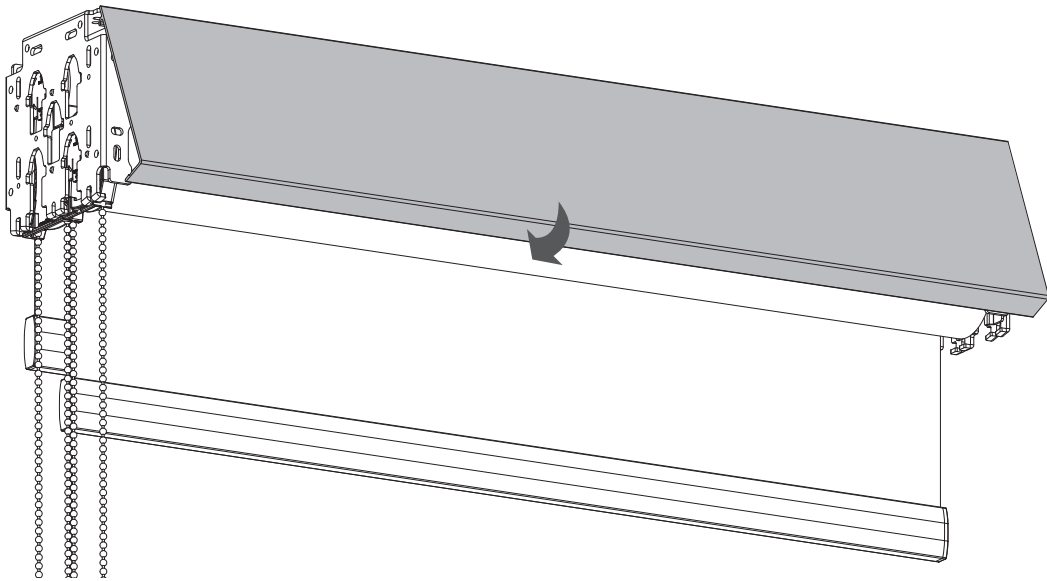

12

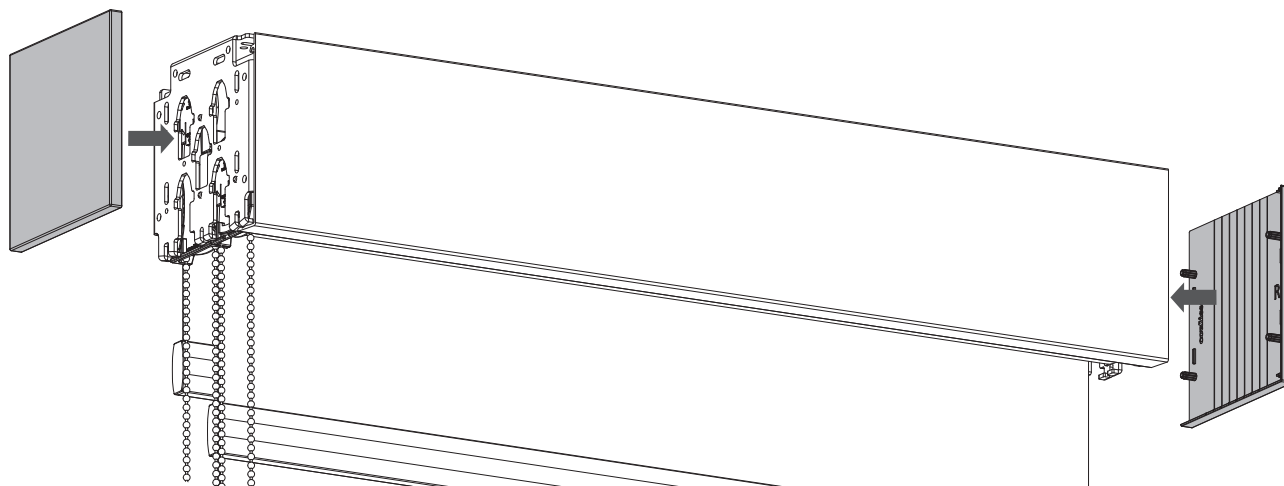

Outside Mount Only

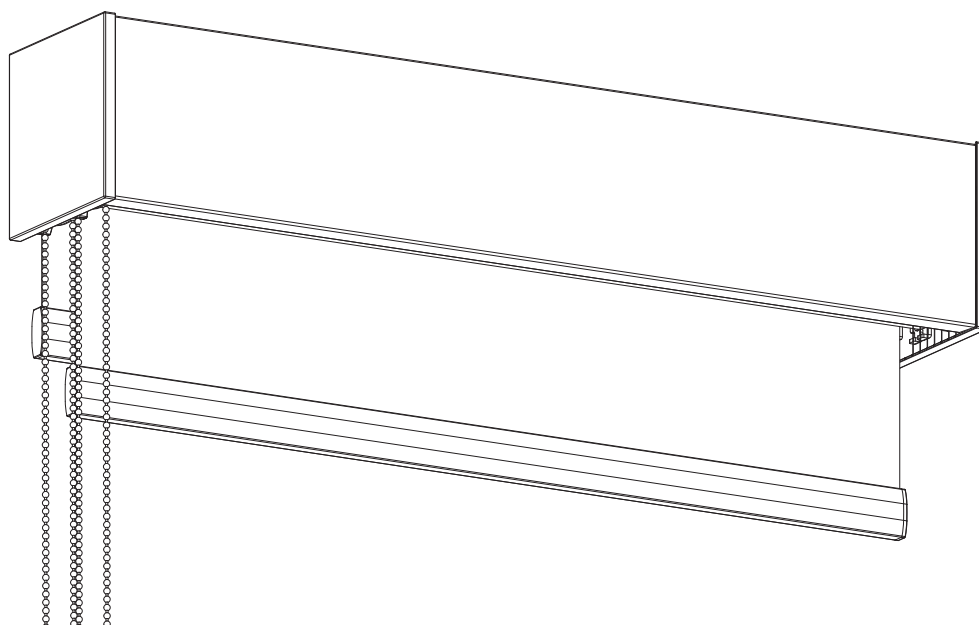

Installation - Fascia Dual Roller with Motorization

INSTALLATION MANUAL

Read the instructions carefully before assembling and using the product.
Assembling process can be completed by non-professionals. For indoor use only.

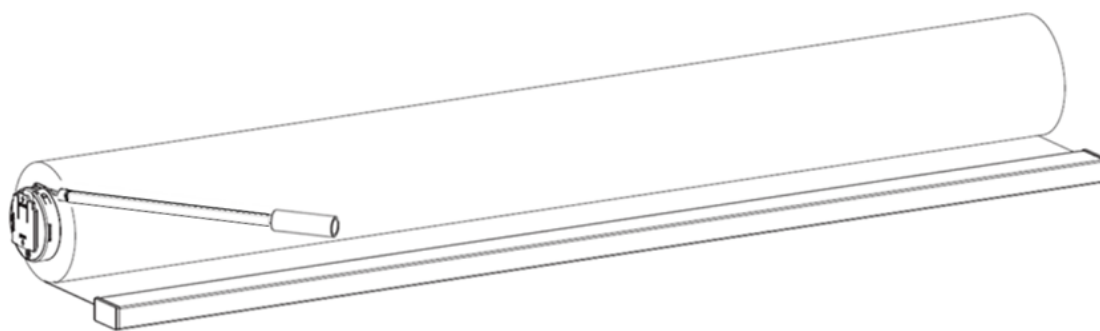

2 x

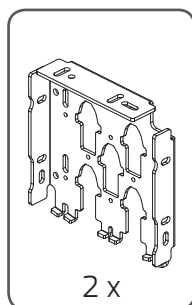

2 x

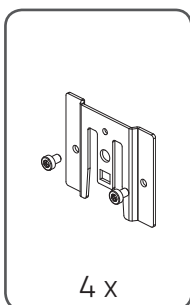

4 x

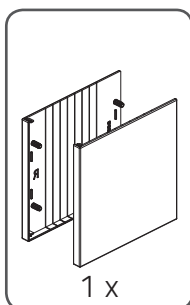

1 x

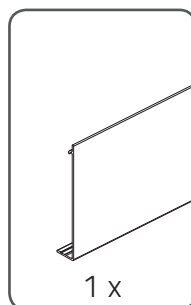

1 x

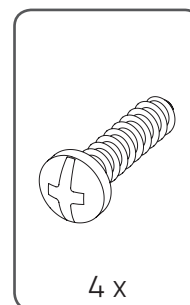

4 x

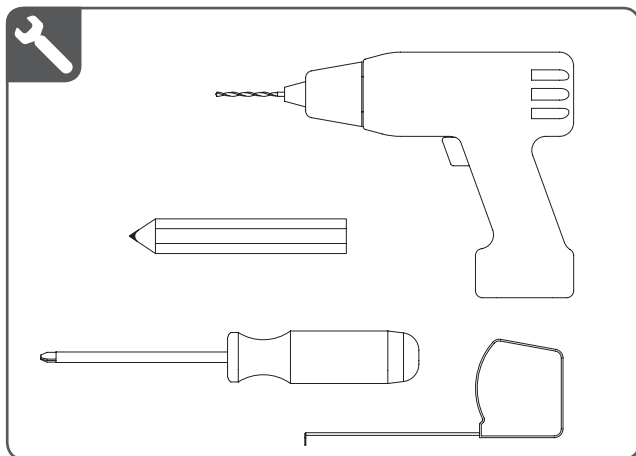

Inside mount

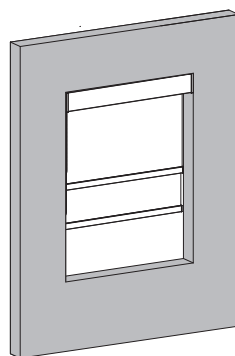

Outside mount

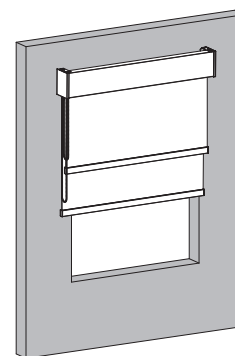

Deduct 45 mm or 1 3/4 inch from opening width for screw positions

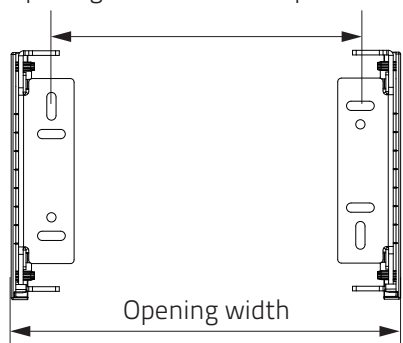

Outside Mount

Inside Mount

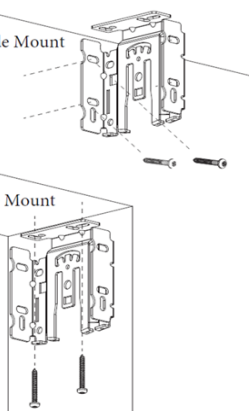

1

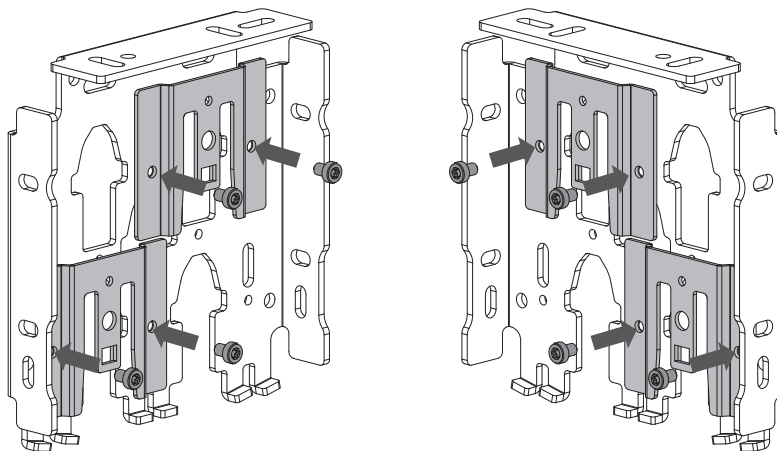

2

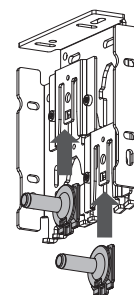
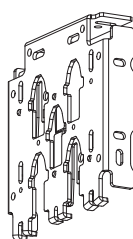

3

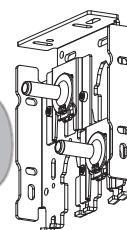
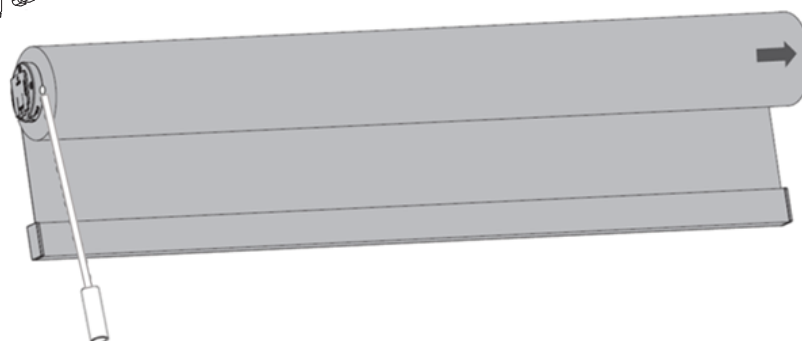
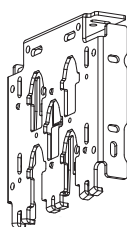

4

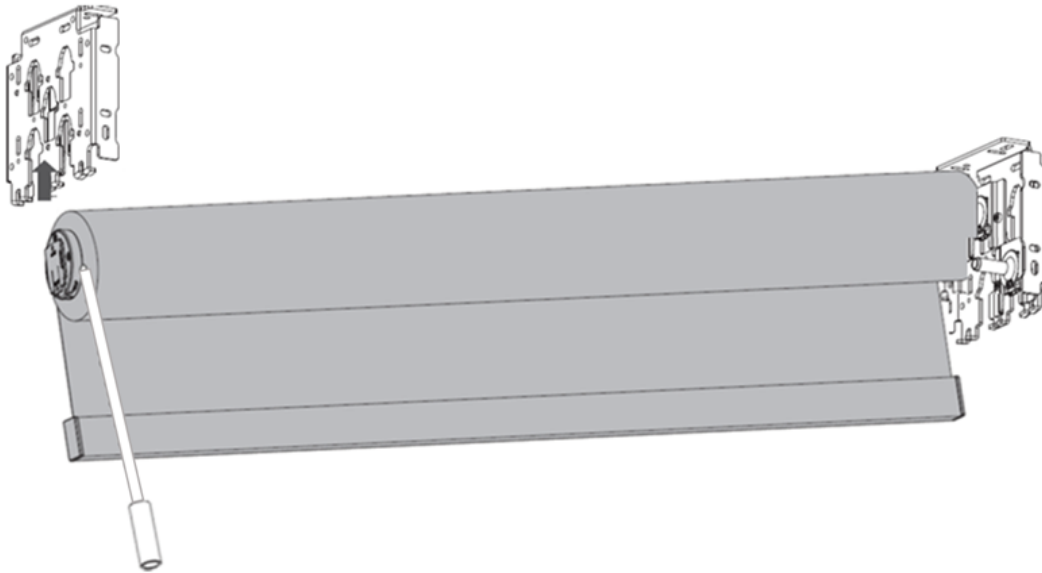

5

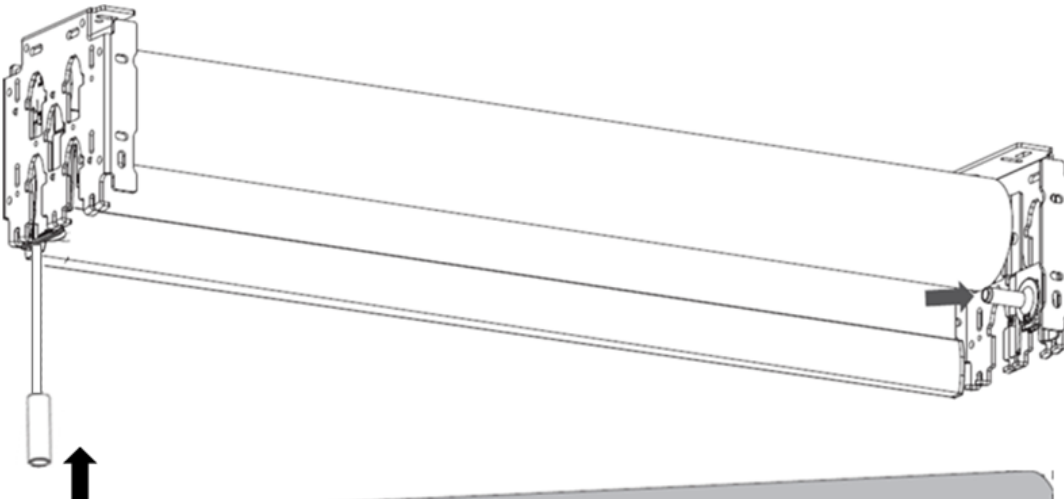

6

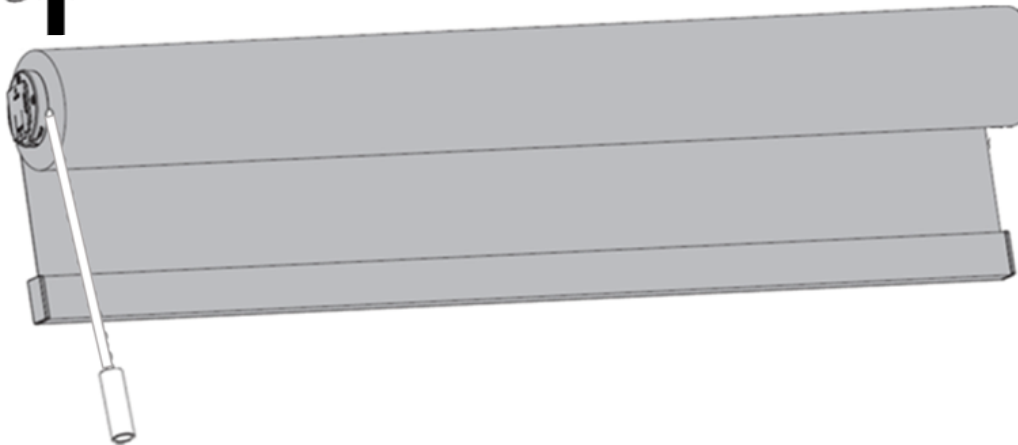

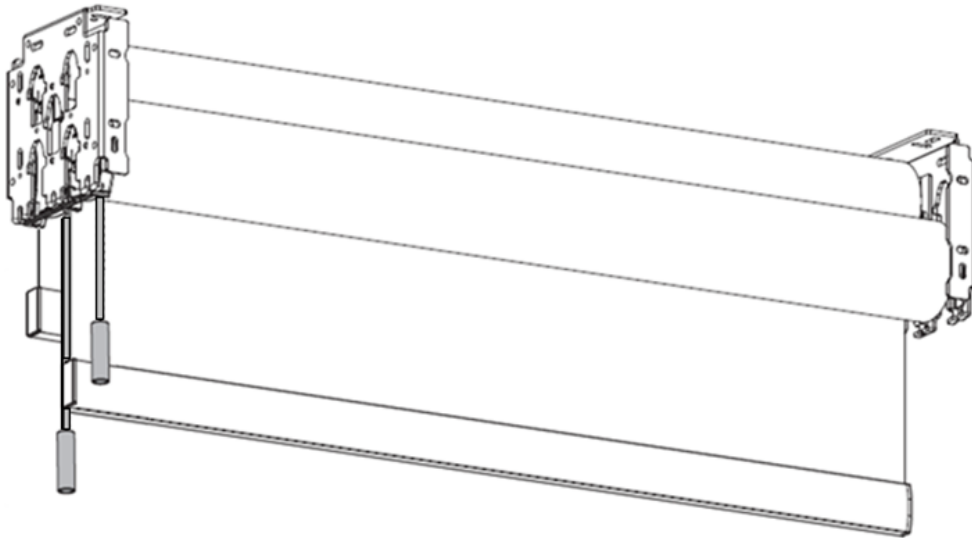

7

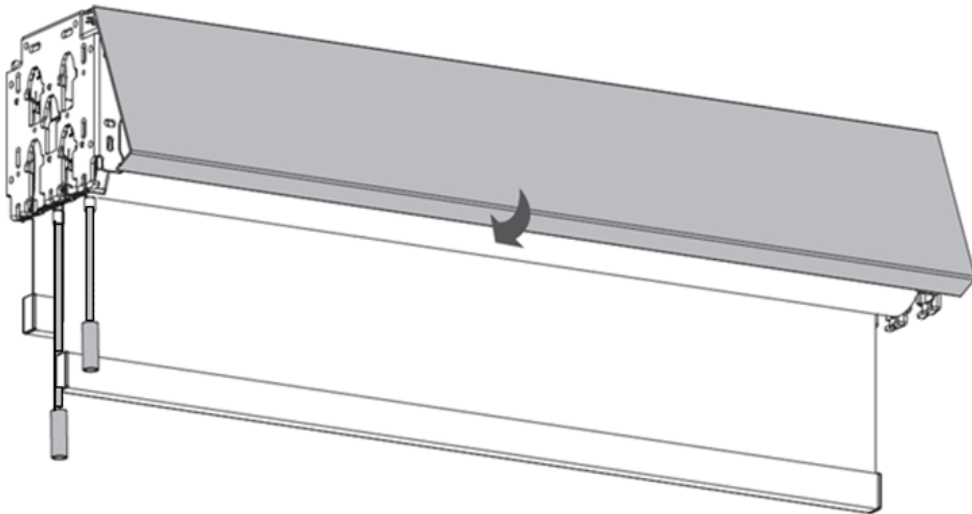

8

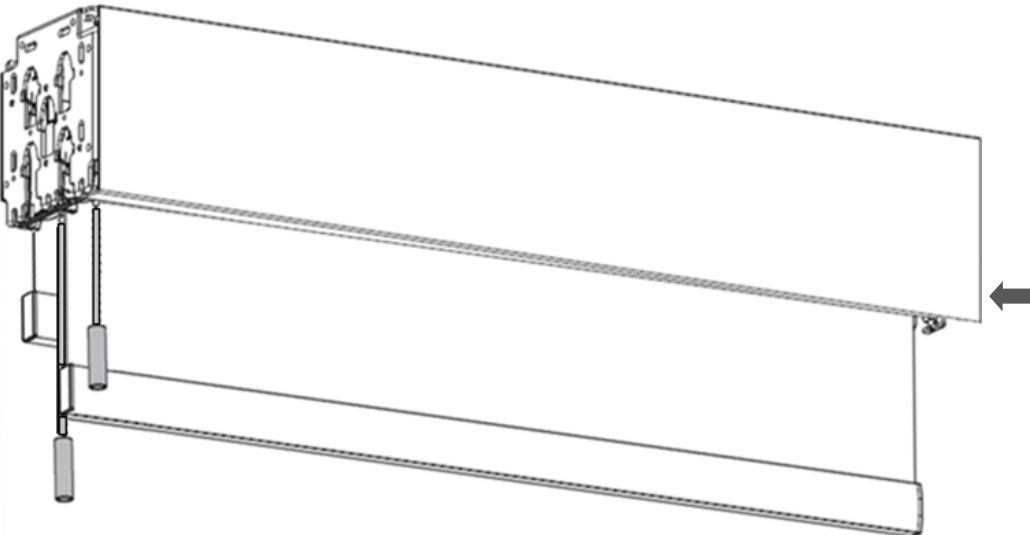

9

